

# THOMSON

NAVICLICK

Manuel d'utilisation  
Bedienungsanleitung  
Manuale di utilizzazione  
User manual  
Gebruiksaanwijzing  
Manual de utilización  
Manual de utilização  
Εγχειρίδιο χρήσης



**SHOWVIEW**®  
DELUXE

FRANCAIS ..... **F**

DEUTSCH ..... **D**

ITALIANO ..... **I**

ENGLISH ..... **GB**

NEDERLANDS ..... **NL**

ESPAÑOL ..... **E**

PORTUGUÊS ..... **P**

ΕΛΛΗΝΙΚΑ ..... **GR**

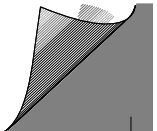
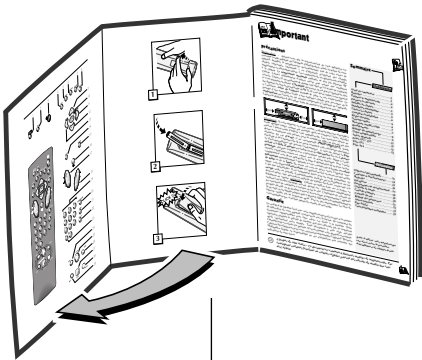

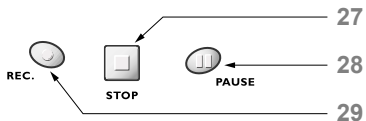
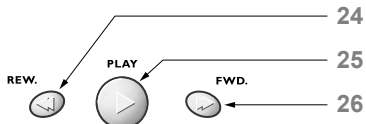
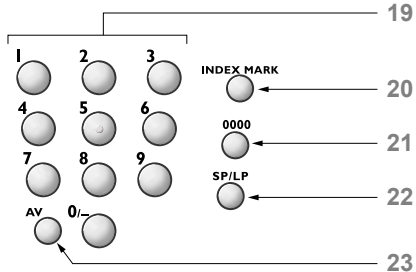
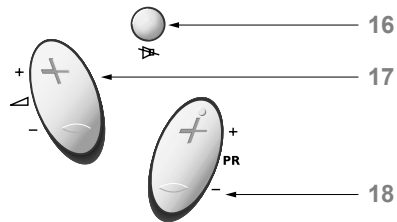
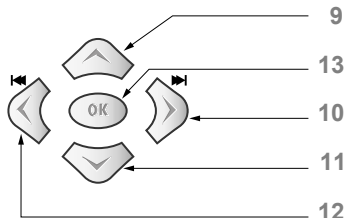
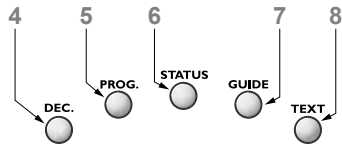
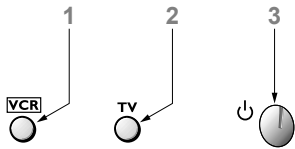

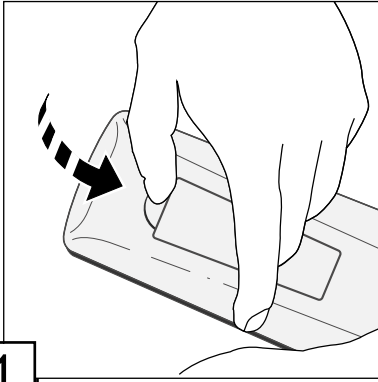

1

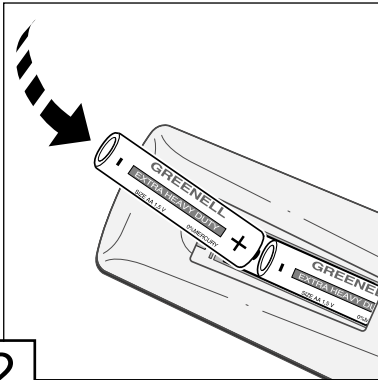

2

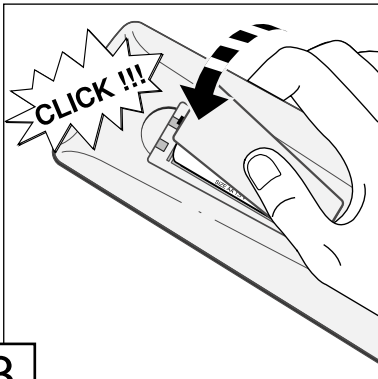

3



# Important

## Precautions

**SETTING UP** - Ensure that the mains supply in your house complies with that indicated on the identification sticker located on the back of your appliance. Install the video recorder horizontally, away from any source of heat (fireplace) or appliances creating strong magnetic or electric fields. The components of this video recorder are sensitive to heat. The **maximum ambient temperature** should not exceed **40° Celsius**. Leave sufficient space around the video recorder to allow adequate ventilation: 10 cm on either side and at the rear, as well as 7 cm above the top are minimum requirements. **The humidity of the room** should not exceed **80%**. If you have to use the video recorder outdoors, **do not expose it to water** from rain or splashing. Moving it from a cold atmosphere into a warm one is likely to cause condensation on some components inside the video recorder. Let the **condensation** disappear by itself before turning the video recorder on again.

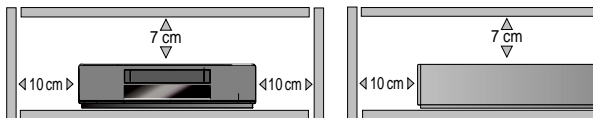
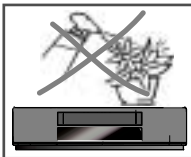

**USE** - If your appliance, or a cassette, has been stored in a very cold atmosphere for a certain amount of time (transported during winter for example), wait approximately 2 hours before using your video recorder. The openings located on the top and the bottom are for ventilation purposes. They should not be obstructed. During **thunder** storms, we recommend that you disconnect the video recorder from the mains and aerial so that it is not affected by electrical or electromagnetic surges that could damage it. For this reason, keep the **mains socket** and **aerial socket** accessible so they can be **disconnected**. When the unit is on standby, some components remain connected to the mains. To fully disconnect your set, you have to unplug the mains connector from the mains socket. Immediately **disconnect** the video recorder if you notice it giving off a **smell of burning** or **smoke**. Under no circumstances whatsoever must you open the video recorder yourself. You risk **electrocution** if you do so. **CLEANING** - Use a soft, dry and clean cloth. Regularly dust the vents at the back or sides. Using solvents, abrasive or alcohol based products risks damaging the set. If an object or liquid enters inside the appliance, unplug it immediately and have it checked by an authorised technician. To avoid deterioration of your video recorder's heads, never use a cleaning tape.

## Guarantee

The type and production number of your appliance are printed on the guarantee certificate delivered with your video recorder. Keep this certificate as well as the invoice. These documents are indispensable for claiming your guarantee rights. All repairs during the guarantee period must be carried out by an authorised technician representing our brand. If this condition is not met, your rights will no longer be valid. Never open the appliance yourself, since this may be dangerous for you or damage the equipment. Thomson Multimedia is not liable if the video recorder is used other than in accordance with this manual.

**Prior to using your video recorder, you'll have to follow the set-up procedure and make the settings described on pages 2 to 7.**

## Contents

	<b>Installation</b>
<b>Before you start</b> .....	<b>2</b>
<b>Making the connections</b> .....	<b>3</b>
<b>Initial installation</b> .....	<b>4</b>
Auto installation - New or encoded channel - Sorting the channels - Clock setting	
<b>Satellite / cable receiver</b> .....	<b>6</b>
Recommended connection scheme - Video recorder settings	
<b>Other sets</b> .....	<b>8</b>
Sockets AV1 / AV2 / AV3 / AV4	



	<b>Use</b>
<b>Using the remote control</b> .....	<b>9</b>
Controlling the video recorder - Programming the TV code - Controlling the television set	
<b>Controlling the operation</b> .....	<b>10</b>
On the display - On the screen	
<b>Viewing a tape</b> .....	<b>11</b>
Watching a channel via the video recorder - Viewing a tape - Play - Accelerated play - Still image - Pause - Variable slow motion - Stop Rewind or Fast forward - Ejection of the tape	
<b>Recording</b> .....	<b>12</b>
Preparing the recording - Simple recording, with automatic stop, "S.O.S. record" - Mark a scene with an index - Continuous recording / play	
<b>NAVICLICK</b> .....	<b>13</b>
Consulting TV programmes with NAVICLICK - Programming a recording with NAVICLICK - Updating NAVICLICK	
<b>Programming a recording</b> .....	<b>14</b>
With the SHOWVIEW® numbers - Without the SHOWVIEW numbers - When the video recorder is programmed - Deleting a programmed recording - Recording programmed by an external connected unit - Error messages likely to occur when programming	
<b>Tape control</b> .....	<b>16</b>
Index search - Introduction search - Clear index - Access to counter - Access to remaining time - Tape type - Auto Sequence Memory	
<b>Sound adjusting</b> .....	<b>17</b>
Adjusting the sound in the play mode Setting the type of sound to be recorded	
<b>Picture adjusting</b> .....	<b>18</b>
Tracking - Sharpness - Stability - Format - S-VHS cassette - TVNTISC - Copy mode - Black and white - Colour system	
<b>Adjusting preferences</b> .....	<b>20</b>
Bleep sound - Auto AV link - ShowView + 10 - Auto clock - VPS/PDC - Subtitle record - External timer - Eco mode - LP mode - Language	
<b>Audio dubbing - Auto Sequence Memory</b> ..	<b>22</b>
<b>Other functions</b> .....	<b>23</b>
Electronic lock - Concerning video tapes - TV set code list	
<b>Technical features</b> .....	<b>24</b>



**ON THIS USER MANUAL:** This user manual being common to several VCR models, some functions or settings may not be available on the model you have bought.





# Before you start



Thank you for purchasing one of our videos. Unpack the set completely and tear off the protection films.

**Video recorder**

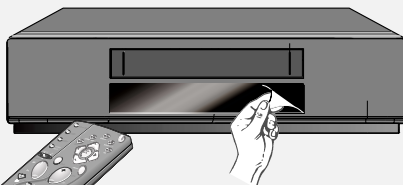

**Remote control**



**2 non-rechargeable batteries, type AA**



**Power cord** \_\_\_\_\_



**Coaxial cable (75 Ω)** \_\_\_\_\_



**Scart cable  
(21 pins connected)** \_\_\_\_\_



**Set-up and user manual**



*To respect the environment, we have printed this document on unbleached recycling paper.*

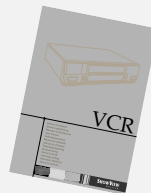

Please respect the environment and prevailing regulations. Before you dispose of batteries or accumulators, ask your dealer whether they are subject to special recycling and it they will accept them for disposal.



# Making the connections



Connecting the video recorder and television set with this cable simplifies set-up and subsequent use, and considerably improves the pictures and sound reproduction quality.

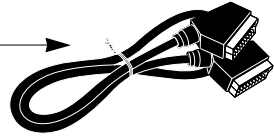

- 1 Disconnect the aerial cable from your TV set and reconnect it to the IN socket of your video recorder.
  - 2 By means of the coaxial cable supplied, connect the video recorder's OUT socket to the television's aerial socket.
  - 3 With the SCART cable supplied, connect the video recorder's AV 1 socket (audio/video 1) to the television's SCART socket (AV 1, EXT 1, AUX 1 depending on the make).
- ☺ *Your television socket should be compatible with RGB signals (21 pins connected).  
If this is not the case, use the AV4 socket on the video recorder (yellow cinch socket).  
See your retailer for the appropriate cable.*
- 4 Connect the video recorder to the mains with the power cord supplied by first plugging in the connector at the video recorder rear.

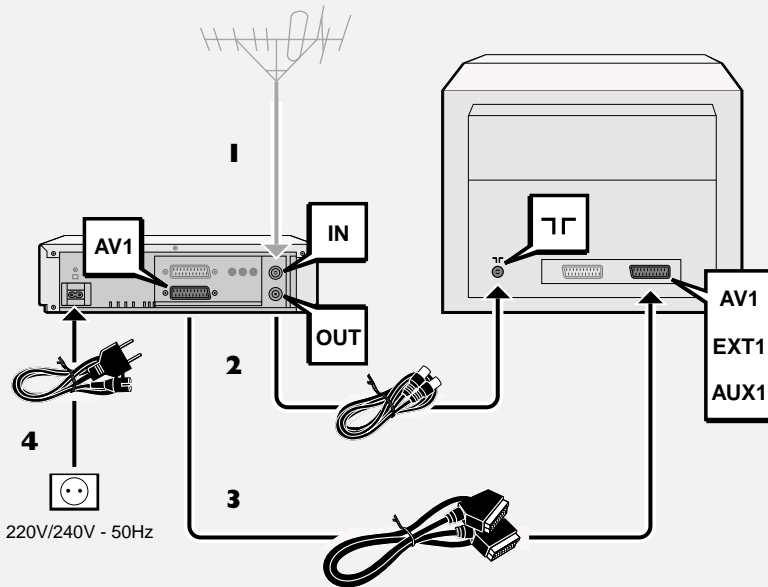

Other possible connection schemes are shown on page 6 and 8.



# Initial Installation



As the video recorder has not been preset to receive channels from your region, you have to install the channels yourself by carrying out the automatic channel installation procedure described below.

## Auto Installation

- 1** Switch on the television.
- 2** Press the **VCR (1)** key on the remote control.
- 3** Switch on your video recorder with button **⏻ (3)**.
  - ⇒ When switching on the video recorder for the first time, a language selection menu comes up. Should it not appear, press **MENU (15)** key.
- 4** With **▲ (9)** and **▼ (11)** keys, select the language you prefer to display the menus on the screen, then validate your choice with the **OK (13)** key.
  - ⇒ A welcoming message appears. Validate with **OK (13)** key.
- 5** The **INSTALLATION** menu appears. The **Auto installation** line has already been selected. Validate with **OK (13)** key.
- 6** Press **▲ (9)** and **▼ (11)** keys to select the country where you usually live, then validate with the **OK (13)** key.

☺ *Your video recorder comes with the NexTView Link feature. This function simplifies the channel installation procedure, downloading them from a TV set fitted with the NexTView Link or similar feature (Easy Link, Smart Link, Megalogic, etc.) and already installed. The channels downloaded in this way preserve the same properties as your TV set (same number, same name, etc.).*

⇒ If your TV set is fitted with the NexTView Link function or similar, the video recorder automatically initiates channel download once you have selected the country. You can view channel download on the video recorder display (Pr1, Pr2,...). On completion of download, the video recorder switches over to standby. Channel installation is finished.

⇒ When your television set is not fitted with the NexTView Link or any similar feature, a message tells you that your video recorder is searching and storing the channels you can receive in your region. Keep patient until a message informs you that your channels are stored.

- 7** Press **OK (13)** key to confirm your channels.
- 8a** If the proposed channel number matches the displayed picture, press **OK (13)** to pass on to the next channel.
- 8b** If the proposed channel number does not correspond to the picture that you see, scroll the channels with the **◀ (12)** or **▶ (10)** keys. Validate with **OK (13)** key.
- 9** When all the channels have been confirmed, press **EXIT (14)** to leave the menu.

## New or encoded channel

☺ *To complete the installation of your video recorder when the automatic channel installation has not stored all of the channels or when you wish to store a new channel.*

- 1** With the **MENU (15)** key, call up the **SUMMARY** menu.
- 2** Press the **▼ (11)** key to select the **Installation** line, then validate with **OK (13)** key.
- 3** The **Manual set up** line is already selected. Press **OK (13)**.
  - ⇒ The **MANUAL SET UP** menu comes up. The **Standard** line is selected.
- 4** Press **◀ (12)** or **▶ (10)** to choose the reception standard.



When the picture of a channel is of poor quality or encoded, try out the fine tuning feature. Refer to New or encoded channel, step 7.



- 5 Press **▼ (11)** to select **Reception** then choose **Aerial** (for channels received via roof aerial) or **Cable** (for cable channels) with **◀ (12)** or **▶ (10)**.
- 6 Press **▼ (11)** to select the **Autosearch line**, then press **◀ (12)** or **▶ (10)** several times to search for the programme channel, or you may also directly enter a number with keys 0 to 9 (**19**).  
⇒ When a channel is found, the pictures come up on the screen.
- 7 When the picture is poor, select the **Fine tuning line**, then press **◀ (12)** or **▶ (10)** to adjust the picture.
- 8 When the channel name is incorrect, select the **Name line** and with **◀ (12)** or **▶ (10)** keys, select a name, or you may also enter a name by choosing the characters with the keys **1** and **2** and press **▶ (10)** to move on to the next character.
- 9 If the channel is encoded, press **▼ (11)** key, to select **Decoder** and check the box with **OK (13)** key.
- 10 Position the cursor on **Store on Pr** and assign a channel number with **◀ (12)** or **▶ (10)** keys, or you may also enter the number with keys 0 to 9 and press on **OK (13)**.
- 11 If you wish to continue with TV channels installation, repeat steps 5 to 10. Otherwise, press **EXIT (14)**.



## Sorting the channels

☺ *The automatic channel installation assigns numbers to the channels in a pre-defined order. These numbers may therefore not match the actual channel numbers. Should this be the case, change these numbers by carrying out the instructions below. For easy channel identification, we suggest that you have a TV magazine at hand.*

- 1 With the **MENU (15)** key call up the **SUMMARY** menu.
- 2 With **▼ (11)** key, select the **Installation line**, then validate with **OK (13)**.
- 3 Select the **Organizer line** from the **INSTALLATION** menu and validate with **OK (13)**.
- 4 Select the **Select Pr line**, and choose a channel by entering its number or by scrolling with **◀ (12)** or **▶ (10)** keys.
- 5 If you wish to change the name of the channel, call up the **Name line** and with **◀ (12)** or **▶ (10)** keys, scroll the names available, or you may enter the name with keys **1** and **2** and press **▶ (10)** to pass on to the next character.
- 6 Call up the **Swap with Pr line** to exchange two channels and enter the channel number you wish to exchange with the channel which presently appears on the **Select Pr line**. Validate with **OK (13)**.
- 7 To delete the currently selected channel, call up the **Delete Pr line** and validate with **OK (13)**, reconfirm with **OK (13)**.

## Clock setting

☺ *Your video recorder is fitted with an automatic clock setting feature that detects the clock setting signals sent by some channels. If your video recorder clock is not right, you can set it right by carrying out the steps below.*

- 1 With **MENU (15)** key call up the **SUMMARY** menu.
- 2 With **▼ (11)** key, select the **Installation line**, then validate with **OK (13)**.
- 3 With **▼ (11)** key, select the **Clock set line** and confirm with **OK (13)**.  
⇒ The **CLOCK SET** menu comes up.
- 4 If the displayed time is incorrect, select **Auto clock line**, then validate with **OK (13)**.
- 5 If the displayed time is still incorrect, change clock in the following order: day, month, time or year by means of **▲ (9)** and **▼ (11)** keys, and press **◀ (12)** or **▶ (10)** keys to change them.
- 6 Validate with **OK (13)**, then press **EXIT (14)** to leave clock setting.

☺ *Did you insert the batteries in the remote control?  
For detail instructions, see inside the cover.*





# Satellite/cable receiver

- ☺ *The connection schemes you may adopt for your satellite receiver depend on the available sockets and cables in your possession. Prior to connecting your satellite receiver to the video recorder, make sure that the former is capable of properly receiving the cable programmes.*

## Recommended connection scheme

To give the video recorder priority over the satellite receiver, connect your satellite receiver to the AV2 of the video recorder by means of a SCART cable.

- ☺ *Position the satellite receiver on top of the video recorder and see that you leave the infrared windows uncovered.*

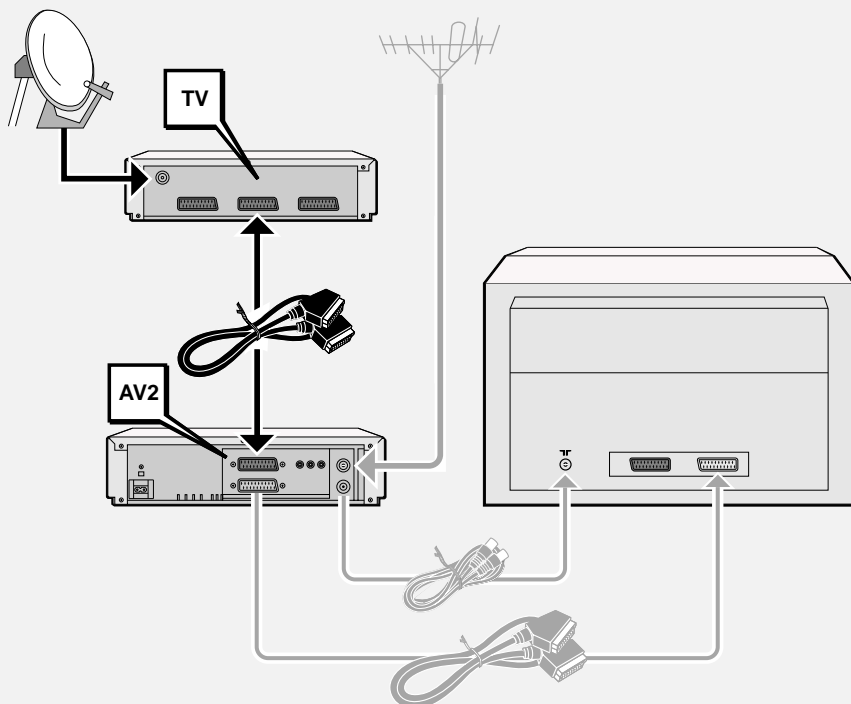

- ☺ *For the other possible connection schemes, refer to the set-up manual of your satellite receiver.*

## Video recorder settings

- 1** Switch on your satellite/cable receiver and select channel 1.
- 2** Press the **VCR (1)** key on the remote control.
- 3** With **MENU (15)** key, call up the **SUMMARY** menu.
- 4** With **▼ (11)** key select the **Installation** line and confirm with **OK (13)**.
- 5** With **▼ (11)** key select the **Satellite and cable box** line and confirm with **OK (13)**.
- 6** Select the country where you live or the country from which you wish to receive the channels, in the case of living on the border, from the list of countries which appears on the screen and press **OK (13)**.  
⇒ The **SATELLITE AND CABLE** screen appears.
- 7** With **◀ (12)** or **▶ (10)** keys, select the socket to which your satellite receiver is connected:
  - either **RF** or **Coax** (mono sound); validate with **OK (13)**. The satellite receiver communication channel search screen appears; press **◀ (12)** or **▶ (10)** to start the search, then validate with **OK (13)** on completion of the search.
  - either **AV1** or **AV2** and validate with **OK (13)**, then select **No decoder** (the other options are rarely used in Europe) and revalidate with **OK (13)**.
- 8** Enter your satellite code number (see the code table at the end of this user manual), then validate with **OK (13)**.  
☺ *If the make or model of your satellite/cable receiver is not on the list, try out other model numbers. If no code works, repeat the procedure described on this page by entering the 00; the video recorder then tries out all the codes stored in its memory.*  
⇒ Via the infrared window, the video recorder transmits a signal to your satellite receiver. A confirmation menu comes up while the satellite receiver positions itself on channel 12 (check whether channel 12 is indicated by the display on satellite receiver - occasionally in a slow manner -, even if there is no image to be seen on the television screen).
- 9** Should the satellite receiver not use channel 12, select **NO** with the **EXIT (14)** key. Your video recorder then starts a new search (depending on the make of your satellite receiver, several attempts are possible).
- 10** If the satellite receiver uses the channel 12, select **YES** with the **OK (13)** key.
- 11** Press **OK (13)** key again. Wait for quite a long time (up to 15 minutes) until a message tells you that the storage of your satellite channels is completed.
- 12** Press **EXIT (14)** key to leave menu.  
⇒ Your video recorder now controls your satellite receiver.
- 13** Refer to page 5 to sort your satellite channels and check their names.

☺ *If you should wish to change your satellite receiver, select the **Installation** line from the **SUMMARY** menu then the **Satellite and cable** line and finally the **New installation** line. If you should wish to rearrange your satellite receiver channels, select the **Satellite channel identification** line from the **SATELLITE AND CABLE** menu.*



*When connecting the video recorder to a television set with integrated satellite receiver, you must select the socket **AV1** during set-up.*



# Other sets

😊 Press the **STATUS** key (6) to call up the control screen and select the socket **AV1**, **AV2**, **AV3** or **AV4** with key **AV** (23) of the remote control.

## Sockets AV1 / AV2 / AV3 / AV4

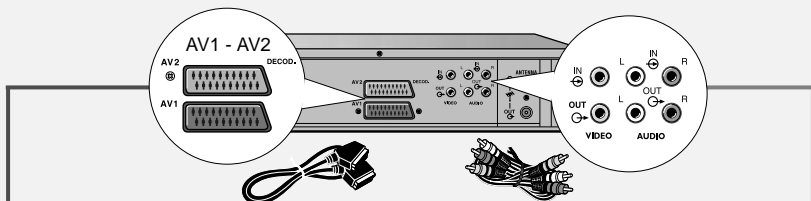

**AV2**

Decoder

**AV1 / AV2 / AV4**

DVD

Camcorder

**AV4**

Audio/Video or Dolby Pro Logic amplifier

TV set

Other video recorder

Video disk player

Satellite receiver

The pictures from another set operating in the play mode and connected to AV2 are conveyed to the socket AV1. When your television is connected to this socket, you can watch the pictures from the set connected.

The four cinch sockets **AUDIO IN/OUT** (red and white) and the two **VIDEO IN/OUT** cinch sockets (yellow) enable you to connect your video recorder to an Audio/Video amplifier.

**AV3**

Camcorder

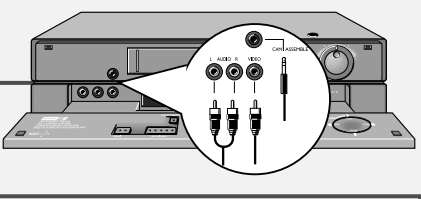

Connect your camcorder to the sockets **AUDIO L** (left), **AUDIO R** (right), **VIDEO IN** and **CAM/PAUSE** and select socket **AV3** on your video recorder.

😊 With compatible camcorders, the **PAUSE** socket facilitates copying by triggering the recording mode of the video recorder as soon as the camcorder switches over from **PAUSE** to **PLAY**. The video recorder must be switched on Record Pause.

Hi-Fi system

The four cinch sockets **AUDIO IN/OUT** (red and white) enable you to connect your video recorder to the HiFi stereophonic system. Thus, you will be able to reproduce all the sound effects of your tapes (musicals, films...) on your HiFi system.



# The remote control



Your remote control enables you to control both the video recorder and the TV set. First choose the VCR key for the video recorder or the TV key for the television. Follow the instructions given below to program the remote control for the television set.

Brand of your TV set:	Brand code
BRANDT .....	.001-000-010-020
FERGUSON . . . . .	.001-003-004-000-010-020
NORDMENDE .....	.001-010-020-000
SABA .....	.001-000-005-010-019-020
TELEFUNKEN . . . . .	.001-002-000-010-020
THOMSON .....	.001-000-002-010-020

Other makes see page 23



## Controlling the video recorder

Remember to press the VCR key before trying to use the video recorder with the remote control.

- |  |   |
|--|---|
| <b>1</b> Controlling the video recorder.         | <b>15</b> Calling up the <b>SUMMARY</b> .   |
| <b>3</b> Switching the video recorder on or off. | <b>18</b> Changing the channels.  |
| <b>4</b> Selecting the <b>decoder</b> function.  | <b>19</b> Choosing a channel. For 2 digit channels first press on the 0/-- key (0,1,2 for Pr12) |
| <b>5</b> Calling up the <b>SHOWVIEW</b> menu.    | <b>20</b> Adding an index.  |
| <b>6</b> Calling up the information screen.      | <b>21</b> Resetting the counter.  |
| <b>7</b> Calling up the <b>NAVICLICK</b> menu.   | <b>22</b> Doubling the recording capacity of a tape with the <b>LP</b> function.                |
| <b>8</b> Calling up sub-titles.                  | <b>23</b> Selecting appliances which are plugged into the audio / Video sockets.                |
| <b>9</b> to <b>12</b> Navigating in the menus    | <b>24</b> Rewind <b>27</b> Stop   |
| <b>13</b> Validating a choice.                   | <b>25</b> Play <b>28</b> Pause/record   |
| <b>14</b> Exiting from a menu.                   | <b>26</b> Fast forward <b>29</b> Record   |

## Programming the remote control with the TV code.

Your remote control may be used to control some functions on the majority of TV sets. To this end, use one of the codes listed in the following table or on page 23 to program your remote control.

- Press the **TV (2)** key on the remote control.
  - Hold down the **MENU (15)** key and enter the three digit code which corresponds with your TV make.
  - Release the **MENU (15)** key and try to control the TV set.
- Should the code that you have entered not control the set, try another code proposed for this make. When you replace batteries in the remote control, you should re-enter the three digit code for the TV set.

## Controlling the television

- |   |   |  |
|---|---|--|
| <b>2</b> Controlling the television.  | <b>10</b> Zooming in / flash zoom +   | } The main functions of your remote control can be found on the VCR front panel. |
| <b>3</b> Switching* the TV set on or off.   | <b>12</b> Zooming out / zoom -  |  |
| <b>4</b> These keys have the same function as some to keys on your TV set's remote control (when the later is of our make). | <b>18</b> Changing the channel.   |  |
| <b>15</b> Mute.   | <b>19</b> Switching* the TV set on or choosing a channel.   |  |
| <b>16</b> Mute.   | <b>23</b> Selecting a scart socket and watching the pictures on the set connected by this socket. |  |
| <b>17</b> Adjusting the sound.  |   |  |

\* The key used for switching the TV set on and off depends on the model.



The main functions of your remote control can be found on the vcr front panel.





# Controlling the operation

## On the display

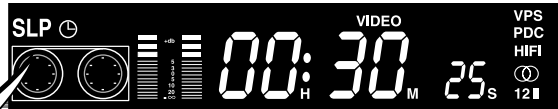

	Stop - Tape in stop position - Presence of a tape in the video recorder
VIDEO	Play.
VIDEO	Accelerated play (forward or backward).
VIDEO	Pause
VIDEO	Variable slow motion (forward or backward).
	Fast forward.
	Rewind.
	Record Pause (flashing).
VIDEO	Recording under way.
Ⓟ	Programmed recording.

<i>Pr</i>	TV channel sound and pictures
<i>Ru 1-2</i>	AV1-AV2 - Sound and pictures of a unit connected to the Scart sockets at the rear of the video recorder
<i>Ru 3</i>	AV3 - Sound and pictures of a unit connected to the video recorder front side
<i>Ru 4</i>	AV4 - Sound and pictures of a unit connected to the cinch sockets at the rear of the video recorder
<i>0 23 SA</i>	Pictures and sound of a satellite channel.
<i>01h15m35s</i>	Tape counter.
<i>09:53</i>	Time.
<b>SP</b>	Play/recording at standard speed (Standard Play).
<b>LP</b>	Play/recording at half speed (Long Play).
<b>SLP</b>	(Super Long Play).
<b>VIDEO</b>	The video recorder transmits the pictures and the sound to the television set.
<b>VPS</b>	The current telecast is in the VPS mode.
<b>PDC</b>	The current telecast is in the PDC mode.
<b>HIFI</b>	Hi-Fi sound
	Stereo
<b>1</b>	Left channel
<b>2</b>	Right channel
	Mono track

} The sound type available on the channel or the tape.

*Display of clock or time:* the time elapsed from the beginning of the tape in play or record mode, the time remaining (r) before end of tape on STOP.

## On the screen

With key **STATUS** (6), you can display the information concerning video recorder operation (tape type, time remaining before end of tape, type of sound, image format, tape speed, channel, time, etc.).

Press this key repeatedly to visualise:

⇒ The television pictures, the pictures of the video recorder including display of the operating status, the television pictures...





# Viewing a tape



To view a tape and explore the recordings, to view a still image and retrieve particular scenes in the accelerated play mode, to rewind to the beginning or wind fast forward to the end of the tape.

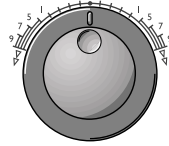

☺ Jog & Shuttle

(on the front side of the video recorder)



## To view a channel via the video recorder

- 1 Switch the television set and the video recorder on.
- 2 Press the **TV (2)** key, then press the **AV (23)** key. The picture corresponding with the channel which has been selected on the video recorder is displayed on the television screen.
- 3 Press the **VCR (1)** to control the video recorder, and using the keys 0 to 9 (**19**) or the **PR+/PR- (18)** key to change channels.

## Viewing a tape

### Play

- 1 Load a tape
- 2 Press **PLAY (25)** key.

☺ When the picture is poor, adjust the phase (page 18). If the colour is not reproduced properly, try another standard (PAL, SECAM or MESECAM) selectable in the **PICTURE** menu (page 19).

### Accelerated play

In play mode, press **REW. (24)** or **FWD. (26)** key repeatedly to change the speed and direction of accelerated play.

☺ You may also use the **SHUTTLE** (outer ring) which is situated on the front side of the video recorder to manipulate accelerated play.

### Still image - Pause

In play mode, press **PAUSE (28)** key to pause a picture, and press repeatedly to wind forward image by image.

### Variable slow motion

- 1 Press the **PAUSE (28)** key.
- 2 Press **REW. (24)** or **FWD. (26)** key to change the speed and direction of slow motion.

☺ The inner knob **JOG** fitted to the front of the video recorder may also be used to explore an image by image sequence in both forward or backward play.

### Stop

Press **STOP (27)** key to stop play.

### Rewind or Fast Forward

- 1 Press the **STOP (27)** key.
- 2 Press the **REW. (24)** or **FWD. (26)** keys.

### Ejection of the tape

- 1 Switch the video recorder to **STOP**.
- 2 Press the **EJECT** key on the front of the video recorder.



# Recording

- ☺ *You can record the pictures and the sound of the TV programmes or the pictures and the sound of the unit connected to one of the available AV sockets.*

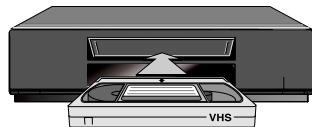

## Preparing the recording

- 1 Load a tape and position it to the desired section where you wish to begin the recording with **REW.**, **FWD.**, **STOP**, **PLAY (24, 26, 27, 25)** keys.
- 2 Select the channel to be recorded with the **PR+ / PR- (18)** key or the keys 0 to 9 (**19**), or else select the AV socket to which the unit is connected with **AV (23)** key.
 

☺ *For two-digit channels, first press 0/-- (19) before entering the two digits.*
- 3 Select standard play (SP) or long play (LP) with the **SP/LP (22)** key.
 

☺ *You may also use the inner knob JOG fitted to the front of the video recorder to explore an image by image sequence.*

## Simple recording

- 1 Press the **REC (29)** key.                   ⇒ The video recorder switches on record-pause.
- 2 Press the **PLAY (25)** key.                 ⇒ The video recorder starts the recording.

## Recording with automatic stop

- 1 Press **REC (29)** key twice.
- 2 Enter current programme end time with keys 0 to 9 on the remote control (**19**).
 

⇒ The recording will automatically stop at the programmed time.

## "S.O.S. Record" (Snap On-Screen) recording

- ☺ *The S.O.S. Record function enables you to record the programme you are watching on the TV at any time provided that your television set is fitted with the function **NexTVView Link** (or similar) and that you have a tape loaded in the video recorder. This function is not available if the video recorder has already been programmed or is in play mode.*
- 1 Press the **REC (29)** key.
 

The video recorder switches on and automatically changes over to the same channel as the television set to start recording.
  - 2 Start the recording with the **PLAY (25)** or the **REC (29)** keys as explained above.

## Mark a scene with an index

- ☺ *Key **INDEX MARK (20)** of the remote control allows you to mark a scene by setting an invisible electronic index while recording or playing a tape.*
- 1 Start play or recording.
  - 2 Press **INDEX MARK (20)** key to add an index
 

☺ *To erase the indices, refer to page 16.*

## Continuous play/recording

- ☺ *It is possible to select endless playback or recording of a tape. When the tape is finished it automatically rewinds to the beginning and the play or the recording recommences.*

**Continuous play:** hold down the **PLAY (25)** key for six seconds.

**Continuous recording:** hold down the **REC (29)** key for six seconds and then the **PLAY (25)** key.

- ☹ *You can't mark or retrieve any index? Check whether the protection tab of the tape is not broken. Should this be the case, cover the opening with a piece of thick adhesive tape. Is recording impossible? Check whether the video recorder is switched to Record Pause (indicated on its display) or to Play.*





# NAVICLICK



*The NAVICLICK function enables you to display every channel's programme on your screen and to programme your recordings for the day with a simple click.*



## Consulting TV programmes with NAVICLICK

- 1 Select a channel on your video recorder.
- 2 Press the **GUIDE (7)** key to display the NAVICLICK page.
- ☺ *This function is available on most of the channels displaying the Teletext (for satellite channels first select SA with the AV key).*

## Programming a recording with NAVICLICK

- 1 Select a channel on your video recorder.
- 2 Press **GUIDE (7)** key and wait until the NAVICLICK page appears.
- 3 Press **▲ (9)** and **▼ (11)** keys to select the programme you wish to record.
- 4 Press **OK (13)** to validate your choice.
- 5 The **TIMER REVIEW** menu appears. Verify your programming and press **EXIT (14)** to exit the menu.
- 6 Switch off the video recorder to put it into standby mode.

## Updating NAVICLICK

- ☺ *In the event of some channels modifying their teletext structure, except in the case of a total modification of the structure, you can update the number of the first page of the teletext of the programme guide.*
- 1 Press **MENU (15)** key to display **SUMMARY** menu.
- 2 Select **Installation** line.  
=> **INSTALLATION** menu appears.
- 3 Select the **NAVICLICK set up** line.
- 4 The menu which appears indicates 3 numbers of the Teletext page channel by channel: those of the current day's programmes, those of the following day's programmes and finally those of the page reserved for sub-titles.
- 5 In order to update information, set the channel to be modified, set page number to be corrected with **◀ (12)** or **▶ (10)** keys, and enter your corrections with keys 0 to 9 (**21**). Validate with **OK (13)**.



# Programming a recording



You can programme a recording with the **SHOWVIEW®** programming numbers indicated in your TV magazine or by means of timer programming if you don't know these numbers. Your video recorder has 8 programming memories. Thus, you'll be able to programme 8 recordings over a 1-year period.

Load a tape and position it to the desired section with keys **REW., FWD., STOP, PLAY (24, 26, 27, 25)**.

## With the **SHOWVIEW®** programming numbers



When programming for the first time, the video recorder positions itself on channel number so that you can confirm or enter the channel number.



SHOWVIEW programming number

- 1 Call up the **SHOWVIEW** menu with **PROG. (5)** key.
  - 2 Enter the number of the programme you wish to record, which you will find in your TV programme, and validate with **OK (13)**.  
⇒ The **TIMER** menu appears. The **Stop time** line is selected.
  - 3 You can complete your programming by selecting a recording triggered by VPS/PDC signals, recording frequency (single, daily, weekly), recording speed (SP/LP), recording sub-titles (from Teletext) at the same time as the programme.
  - 4 Press **OK (13)** to verify your recording time on the **Timer review** line : if not, press **EXIT (14)** key.
  - 5 Switch the video recorder on standby-record with **⏻ (3)** key.
- ☺ If the recording is through a satellite receiver, leave this switched on.

## Without the ShowView® numbers



If you don't know the **SHOWVIEW** number of the programme you wish to record, you'll have to use the **RECORD TIMER** menu.

- 1 Display the **SUMMARY** menu with the **MENU (15)** key.
- 2 Select **Record Timer** line with **▼ (11)** key and validate with **OK (13)**.  
⇒ The **RECORD TIMER** menu comes up.
- 3 With the keys 0 to 9 (**19**) or **◀ (12)** or **▶ (10)** keys, to enter the channel number you wish to record or if not select an AV socket.
- 4 Enter the following information by selecting the corresponding line with the **▼ (11)** key, then with the keys 0 to 9 (**19**) or **◀ (12)** or **▶ (10)** keys:

RECORD TIMER	
Return	
Timer No.	◀▶ 7
Programme No.	Pr - ----
Start time	--:--
Stop time	--:--
Date	20/07
VPS/PDC	No...
How often	Once...
Speed	SP...
Subtitle	Yes...
Clear timer	7
Timer review	

- start time of the programme,
  - end time of the programme,
  - the date, if the recording is not to take place on the same day.
- ⇒ You can complete your record timer by selecting the following options: recording triggered by VPS or PDC signals, daily or weekly repeated recording, recording speed, sub-title recording.
- 5** Switch off the video recorder to put it into standby mode.

## When the video recorder is programmed

When the video recorder is on standby waiting for the time at which the recording shall be triggered, a special indication (⌚) is to be seen on its display. Then, you cannot operate the video recorder any longer unless you quit this mode by pressing key ⏻ (3).



## Deleting a programmed recording

- 1** Display the **SUMMARY** menu with **MENU (15)** key, then select the **Record Timer** line with **▼ (11)**. Validate with **OK (13)**.
- 2** Press **▼ (11)** to select the **Timer Review** list, then validate with **OK (13)**.
- 3** With **▲ (9)** and **▼ (11)** keys, select the programming to be deleted then press key **0000 (21)**.  
⇒ Programming is deleted.

## Recording programmed by a connected external unit

⊙ *The recording of a programme can be triggered by a satellite receiver or any other unit supporting this feature and connected to socket AV1 or AV2 by means of a Scart cable. This connection scheme prevents you from having to programme both units.*

- 1a Programming by external Timer** : tick off the **External timer** box in the menu **PREFERENCES** (page 20) to trigger the recording via socket AV1.
- 1b Programming by the RECORD TIMER menu** : programme the connected unit and, in the video recorder **RECORD TIMER** menu, only select either socket AV1 or AV2, without indicating start and end times.
- 2** Switch the video recorder to standby with **⏻ (3)** key.

## Error messages likely to occur when programming

⊖ *No timer available*

You need to free one of the memories in order to programme again.

⊖ *When you programme two recordings with overlapping time periods, the menu **TIMER REVIEW** comes up and makes the programmed recordings flash.*

Delete the programme recordings with the **0000 (21)** key.

⊖ *Incomplete programming*

Check that you have completed all the requirements for the recording (start time, end time, etc.).



# Tape control



The tape control function enables you to erase an index, or to go or return to a particular tape position. Tape control also informs you of the overall length of the tape and remaining time.

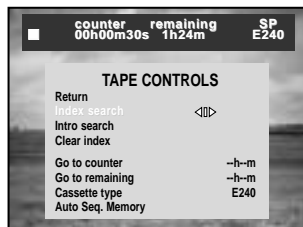

- 1 Load a tape, then display the **SUMMARY** menu with **MENU (15)** key.
- 2 Select **Tape controls** with **▲ (9)** and **▼ (11)** keys, then validate with **OK (13)**.

## Index search

Press **◀ (12)** or **▶ (10)** keys to have access to the precedent or following index. The video recorder immediately returns to the required position and starts to play at this place if you have finished your entry by pressing **PLAY (25)**.

## Intro search

☺ *Intro search displays all the indices in the tape. It explores the tape in fast forward mode with temporarily accelerated play mode of all the indices.*

Select **Intro search** line and press **OK (13)** to start the search.

## Clear an index

- 1 Select the index as described above.
  - ⇒ The video recorder stops at the index.
- 2 Select the **Clear index** function with **▼ (11)** key, then validate with **OK (13)**.

## Go to counter

☺ *Thanks to the time counter you can access a particular position from the beginning of the tape or the 00h00m00s position.*

Enter a value with **◀ (12)** or **▶ (10)** keys, then validate with **OK (13)**.

⇒ The video recorder immediately rewinds to the required position and starts to play at this point if you have ended your entry by pressing **PLAY (25)**.

## Go to remaining time

☺ *Thanks to the time counter, you can access a particular position according to its position relative to the end of the tape.*

Enter a value with **◀ (12)** or **▶ (10)** keys, then validate with **OK (13)**.

⇒ The video recorder immediately rewinds to the required position and starts to play at this point if you have ended your entry by pressing **PLAY (25)**.

## Cassette type

☺ *The video recorder detects the type of any standard tape when it corresponds to a standard time (E60, E120, E180, E240 for 60, 120, 180 and 240 minutes of recording times). For all other tapes (hired films for example), you must enter the cassette type. The video recorder will then be able to accurately calculate and display the elapsed and remaining time of your tape.*

To enter the recording time of the tape, press **◀ (12)** or **▶ (10)** keys, or the keys 0 to 9.

## Auto sequence memory

Refer to page 22.



*It's impossible to use the index marks? Check whether the protection tab of the tape is not broken. Should this be the case, cover the opening with a piece of thick adhesive tape.*

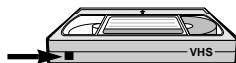



# Adjusting the sound

☺ *Your video recorder receives and records the digital NICAM sound broadcast by some channels in Europe. This sound remains compatible with the analogue stereo sound system broadcast in the other European countries.*

## Adjusting the sound in Play mode.

☺ *You can modify the sound adjustment when you view a HiFi tape. However, in the case of a mono tape, it is not possible to adjust sound.*

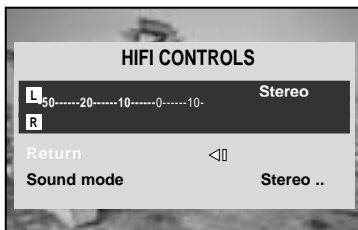

- 1 Load tape and press **PLAY (25)**.
- 2 Display the **SUMMARY** menu with **MENU (15)** key.
- 3 Select **HiFi controls** with **▼ (11)** key, then validate with **OK (13)**.  
⇒ The **HiFi CONTROLS** menu appears.
- 4 With **◀ (12)** or **▶ (10)** keys select the sound track(s):
  - STEREO: stereo sound of the Hi-Fi tracks,
  - MONO: mono sound of the linear track,
  - TRACK 1: sound of the left track,
  - TRACK 2: sound of the right track,
  - MIX: sound of the mixed Hi-Fi and mono tracks.

☺ *When viewing a HI-FI STEREO tape, you may select the sound tracks with **AV (23)** key.*

## Setting the type of sound to be recorded

☺ *The sound level varies with each channel. The sound can be adjusted before recording*

- 1 Load tape and press **REC (29)** key.
- 2 Display **SUMMARY** menu with **MENU (15)** key.
- 3 Select **HiFi controls** with **▼ (11)** key, then validate with **OK (13)**.  
⇒ The **HiFi CONTROLS** menu appears.
- 4 In the case of a stereo or bilingual programme, select **Sound mode** line, then display **Stereo, Mono, Sound 1 or Sound 2** with **◀ (12)** or **▶ (10)** keys.
- 5 Then, select **Level** line and adjust the recording level yourself with **◀ (12)** or **▶ (10)** keys.

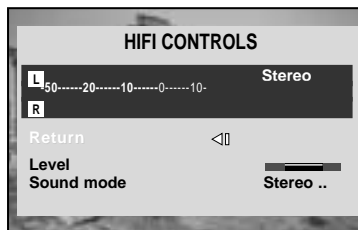



# Adjusting the picture



Through the **PICTURE** menu, you can adjust the video recorder for a better picture quality, a particular colour system detection or recording.

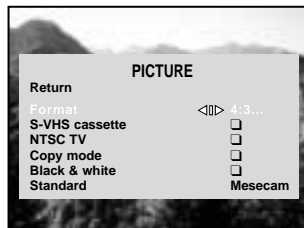

- 1 Display the **SUMMARY** menu with **MENU (15)** key.
- 2 Select **Picture** with **▲ (9)** and **▼ (11)** keys, then validate with **OK (13)**.

## Tracking

☺ Thanks to tracking, you can reduce interference and picture flickering.

- 1 During play, select **Tracking** from the **PICTURE** menu.
- 2 With **◀ (12)** or **▶ (10)** keys, adjust tracking.
- 3 Press **0000 (21)** key to return to standard tracking or select **Tracking** line and display **Auto** with **◀ (12)** or **▶ (10)** keys.

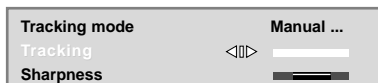

## Sharpness

☺ To improve picture clearness in play.

- 1 During play, select the **Sharpness** line from the **PICTURE** menu.
- 2 Adjust with **◀ (12)** or **▶ (10)** keys.
- 3 Press **0000 (21)** key to return to standard tracking.

## Stability

☺ To improve the picture stability in frozen image mode.

- 1 Pause cassette, and select **Stability** from the **PICTURE** menu.
- 2 Adjust with **◀ (12)** or **▶ (10)** keys.
- 3 To return to standard adjustment, press **0000 (21)** key.



## Format

- 1 Select **Format** from **PICTURE** menu.
  - 2 Choose an option with **◀ (12)** or **▶ (10)** keys.
- ☺ *Automatic: for automatic recognition of a 16:9 recording format.*  
 16:9: to record or read in 16:9 (D2 MAC, Vistopass, PAL+ decoder, numerical television, DVBS), connected to an AV2 or AV1 socket.  
 4:3: to record or read in another picture format.

## S-VHS cassette

If you should wish to read a cassette recorded in a S-VHS format, tick a box with the **OK (13)** key (☑).

## NTSC TV

☺ *To view a cassette recorded in the NTSC 3.58 format on a NTSC TV connected to AV1.*  
Tick the box on the **NTSC TV** line with the **OK (13)** key (☑).

## Copy mode

- ☺ *To improve the copy mode quality from another video recorder or from a camcorder*
- 1** Select the sockets AV1 or AV2.
  - 2** Press **REC (29)** key.
  - 3** Tick the box on the **Copy mode** line with the **OK (13)** key (☑).
  - 4** Start recording by pressing the **PLAY (25)** key.



## Black and white

☺ *When recorded pictures are not of good quality (Scrambling), when the film is in black and white, or when you wish to give an old film effect to your recording.*

Tick the box on the **Black and white** line with the **OK (13)** key (☑).

## Standard

- ☺ *Your video recorder comes with an automatic colour standard detection system (PAL, SECAM, MESECAM, PAL/SECAM, PAL/MESECAM) that works in both play and record mode.*  
*When playing a tape causes problems (scrambled pictures or black and white), you will have to force the play mode by selecting one of the available options (PAL, SECAM, MESECAM).*  
*If you wish to record a tape in a particular colour standard, choose one of the options displayed.*  
*For example, if you wish to exchange tapes with people living in the Middle East, you must record and play in MESECAM.*

Select one of the options with ◀ (**12**) or ▶ (**10**) keys.



# Preference adjustments

☺ *To personalise your video recorder, automate certain functions, complete your programming or modify settings.*

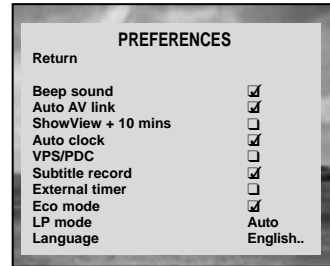

- 1 Display the **SUMMARY** menu with the **MENU (15)** key.
- 2 Select **Preferences** with **▼ (11)** key, then validate with **OK (13)**.  
⇒ The **PREFERENCES** menu appears

## Beep sound

Tick this box to obtain a beep sound every time you press a key on the remote control.

## Auto AV link

☺ *Some television sets send a signal to your video recorder at regular intervals thus often putting the latter into operation mode.*

In order to avoid these spontaneous operations, the **Auto AV link** () function can be de-activated with the **OK (13)** key.

## SHOWVIEW + 10 (minutes)

☺ *Thanks to this option, you can systematically add 10 minutes to the end of your recordings programmed with the SHOWVIEW system. Thus you will avoid defective recordings due to programme time shifting or programmes exceeding the scheduled time (within the 10-minute limit).*

## Auto Clock

☺ *When the automatic daily clock setting feature does not match the time of your region.*

De-activate this function () and manually adjust the clock on your video recorder.

## VPS / PDC

☺ *Some channels telecast their programmes with VPS (Video Programme System) or PDC (Programme Delivery Control) signals. These signals which are recognised by your video recorder allow accurate triggering and stopping of a recording, whatever the delay of the programmes.*

In order to have the possibility of recording at the very moment when a programme begins, tick this option as long as the channel telecasts their programmes in VPS or PDC signals (information available on the video recorder display).



## Subtitle record

☺ *Some programmes are available with sub-titles. Press on the button **TEXT (8)** to display them. It is also possible to record these sub-titles when you are recording a programme. Select **Yes** at the **Subtitle** option in the **RECORD TIMER** menu (see page 14) in order to automatically record them for a given programme.*

To systematically record the sub-titles broadcasted by the programmes which you record, tick the box in the **Subtitle record** line () in the **PREFERENCES** menu .

## External timer

☺ *Recording of a programme can be triggered by a satellite receiver or another programmed unit. Activate this function () so that you only have to programme the unit connected to the socket AV1 of the video recorder.*



## Eco mode

Tick this box to activate the eco mode which enables your video recorder to save energy while in standby mode where only the red indicator is on.

## LP mode

☺ *The LP function enables you to double the recording time of a video tape. Thus, an E180 tape with a three-hour recording time in SP mode can have a 6-hour recording time in LP mode.*

Select one of the options with **◀ (12)** or **▶ (10)** keys :

- *Auto*: the video recorder automatically goes into LP mode in the event of not having enough time on the tape in SP mode.
- *Always*: all recordings are in LP mode.
- *Never*: all recordings are in SP mode.

## Language

☺ *To change the menu language displayed on the screen*

Press **◀ (12)** or **▶ (10)** keys to scroll the different languages available.

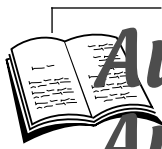

# Audio Dubbing - Auto Sequence Memory

## Audio Dubbing

- ☺ *The audio dubbing enables you to replace the recorded sound on the mono track of a VHS tape whilst keeping the recorded sound on the HiFi tracks.  
A unit connected to sockets AV1, AV2, AV3 or AV4 may be used to dub your recordings.*

- 1 Rewind the cassette to the start of the sequence to be dubbed and pause the picture using the **PAUSE (28)** key.
- 2 Press the **AV** key on the remote control (**23**) or **AUDIO DUBBING** on the front of the video recorder to activate the dubbing function.
- 3 Select the connected unit (Au3 for white, red and yellow cinch sockets on the front of the video recorder; Au1, Au2 or Au4 for the sockets at the back of the unit) to monitor the sound.
- 4 Press **PLAY (25)** to start dubbing, **PAUSE (28)** to interrupt the dubbing and **STOP (27)** to stop.

## Insert editing

- ☺ *Thanks to Insert editing, you can replace part of an existing recording precisely without disturbance at the edit points.  
It is possible to insert from another video recorder, from a camcorder, or from another unit (TV set, another video recorder).*

- 1 Load the cassette and press **STATUS (6)** key.
- 2 Select unit or source of the sequence which is to be placed on the tape.
- 3 Fast forward the tape to the end of the sequence to be replaced and press **STOP (27)**.
- 4 Press **0000 (21)** key to reset the counter.
- 5 Rewind the tape to the beginning of the sequence to be replaced and press **PAUSE (28)** key.
- 6 Press on **REC (29)** and finally start playing from the source so as to begin the insertion.
- 7 The insertion will automatically stop when the counter reaches 0000.

## Auto Sequence Memory

- ☺ *Thanks to Auto Sequence Memory, you can choose different sequences from a tape and consecutively view them. If you are connected to another video recorder fitted with a compatible PAUSE socket, it is possible to copy these sequences and to automatically carry out the editing.*

- 1 Connect the CAM/PAUSE sockets of the two video recorders with the assembly cable.
- 2 Using a SCART/Peritelevision cable, connect the AV1 socket of this video recorder (master) and the AV2 socket of a second video recorder (slave), which is, in turn connected to the television by the AV1 socket.
- 3 Load the tape to be copied.
- 4 Load the blank tape in the other video recorder and select the AV2 socket.
- 5 Display the **SUMMARY** menu, select **Tape controls** option, then the **Auto seq. Memory** line.
- 6 Find the beginning of the first sequence, validate with **OK (13)**, then press **▶ (10)** key.
- 7 Find the end of the first sequence and validate with **OK (13)**.
- 8 Repeat this process for the other sequences. Select the **Start assembling** line to begin the editing and validate with **OK (13)**.

- ☺ *This video recorder is not as precise as professional editing equipment.*



# Other functions





*This page concerns locking your video recorder, and offers some advice regarding video tapes as well as giving the list of TV codes which you will need to program your remote control (see page 9).*

## Electronic lock



*To prevent the video recorder from being used, keys on the front can be locked.*

- Hold down the standby  (3) key on the remote control for 10 seconds and put it in a safe place.
- Press the standby  (3) key on the remote control to unlock the video recorder.



## Concerning video tapes



*To avoid erasing one of your tapes by accident, we recommend that you to protect them by breaking the security tab. To reuse a protected tape, just stick a piece of adhesive tape on this place.*



↑ Unprotected

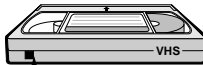

↑ Protected

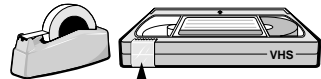

↑ re-recordable

*Tapes are sensitive to utilisation and storage conditions. Keep them away from dust, humidity or excessive heat. Do not place them next to appliances producing strong magnetic or electrical fields (electro-magnet, motor, etc.). Tapes may vary in quality. The difference in quality not only concerns the tape itself but also the different mechanical elements of the video cassette. A poor quality tape can damage your video recorder. You should therefore use quality brand tapes.*

## TV code list

BRAND OF YOUR TV SET	BRAND CODE
AKAI	.008-020
AKARI	.028
BANG & OLUFSEN	.009-019
BLAUPUNKT	.023
BRANDT	.001-000-010-020
BRIONVEGA	.019
BLUESKY	.020
CGE	.016
CONTINENTAL EDISON	.004
DAEWOO	.020-025
ELBE	.005-015-023
FERGUSON	.001-003-004-000-010-020
FINLUX	.020-024-019
FISHER	.008
FORMENTI	.019
GOLDSTAR	.020
GRUNDIG	.023-024-016
HITACHI	.007
IMPERIAL	.016
JVC	.013

BRAND OF YOUR TV SET	BRAND CODE
KNEISSEL	.020-025
LOEWE	.020
LOEWE OPTA	.019-020
LUXOR	.005
METZ	.013-019-023
MITSUBISHI	.017-018-020
MIVAR	.016
NOKIA	.005
NORDMENDE	.001-010-020-000
ORION	.005-020
PANASONIC/national	.012-005-026
PHILIPS	.019-020-021
PHONOLA	.019-020-021
PIONEER	.001-005
POLYTRON	.020-027-029
RADIOLA	.019-020-021
RADIOMARELLI	.019
REX	.005
SABA	.001-000-005-010-019-020
SALORA	.005

BRAND OF YOUR TV SET	BRAND CODE
SAMSUNG	.020-030
SANYO	.008-018
SCHAUB-LORENZ	.005-016-020
SCHNEIDER	.019-020-021
SELECO	.005
SHARP	.022-018
SIEMENS	.023
SINGER	.001-002-019
SINUDYNE	.019
SONITRON	.008
SONY	.014-018
TELEAVIA	.001-010-020
TELEFUNKEN	.001-002-000-010-020
THOMSON	.001-000-002-010-020
TOSHIBA	.006-018-024-016
WEGA	.019
YOKAN	.020-025
YOKO	.020



# Technical data



*In our efforts to improve the quality of our products, we reserve the right to change their features. The information contained in these instructions are therefore liable to change and are not contractual.*

---

<b>Mains supply</b>	200 to 240 V $\pm$ 10% - 50/60 Hz
<b>Consumed power</b>	23 W when ON 3 W in the eco mode
<b>Clock autonomy</b>	approx. 30 minutes
<b>Weight</b>	approx. 4.0 kg
<b>Functioning conditions</b>	+5°C à + 40°C Surrounding humidity: 80 % maximum
<b>Tape heads</b>	video - 4 rotary heads audio - 2 rotary heads (HiFi) 1 fixed head (mono linear track)
<b>HiFi pass-band</b>	20 to 20 000 Hz
<b>Dynamic</b>	80 dB
<b>Tuner</b>	PLL, VPS/PDC Type
<b>Reception band</b>	I-III-IV Hertzian (aerial) Inter-band (cable network) Hyper-band (cable network)
<b>Frequency ranges</b>	45 to 855,25 MHz
<b>Colour systems</b>	PAL - SECAM - MESECAM Playing and recording in NTSC 3.58 Playing of NTSC tapes on TV PAL 60 Hz Playing of S-VHS tapes
<b>Reception standards</b>	LL' - BG - DKK'
<b>Number of storable channels</b>	99
<b>Remote control</b>	Infrared 33 Khz - Batteries 2 x 1,5 V (AA)
<b>Menu language</b>	French, English, German, Italian, Spanish, Hungarian, Dutch, Polish, Portuguese, Swedish, Czech.
<b>Automatic functions</b>	On (using any key) Play (with protected tape) Rewinding (at the end of the tape) Long Play (LP) - Super Long Play (SLP)
<b>Tapes</b>	VHS format Rewinding time: 130s with E 180

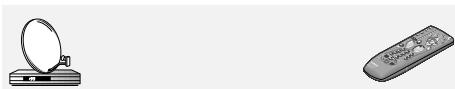

AKAI	SX 1000	13
ALBA	333, 550, 555, 666, SAT200, SAT300, SAT400, SAT500 ISR7000	01 01-13
ALDES		02
ALLSAT		04
AMSTRAD	SAT100, SAT200, SAT300, SAT520, SR150, SRD400 SRD 500, SRD510/SRD520, SRD540, SRD545, SRD550 SRD600IRD, SRD600E, SRD650E, SRD700, SRD2000 SRX20016Ch, SRX20048Ch, SRX300, SRX310, SRX320 SRX330, SRX340, SRX345, SRX350, SRX360	03
ARMSTRONG		06
BEST		07
B.TELECOM	SVS200 SVS300	08 13
BUSH	SR2000 SR3000 IRD155	01 19 09
CANAL SATELLITE NUMERIQUE (1)		20
CAMBRIDGE	ARD200, RD480, RD 480EXTRA (2) RX580S, ARX200, ARK200 SYSTEM	13 13 11
CHANNEL MASTER		11
CHAPARRAL		18
CITIVISION		10
CITYCOM	CCS150, CSS140, CSS190	26
COLUMBUS		35
CONNEXIONS		14
DISKEXPRESS		07
DNT		15
DRAKE		16
EXATOR	EXA111N	37
FERGUSON	SRA1, SRD6, SAFP5, SRV1, SRD5, SRD16, FSP10	12
FINLUX	TV5000 (3)	34
FUBA	ODE540, ODE543, ODE545 (4) ODE550, ODE622 ODE642	37 37 35
GOODMANS	ST700	19
GRUNDIG	GIRD3000 GIRD2000, GRD150, GRD200, GRD250, GRD280 GRD300, STR-1, STR211, STR212, STR311, STR312 STR315, STR322, STR511, STR512, CSR10	19-21 21
HIRSCHMANN		22
HITACHI	SR2070D, SR1050D	19
JOHANSSON		25
JVC	TU-AD1000	08 19
KATHREIN	UFD41, UFD70, UFD89, UFD90, UFD91, UFD92, UFD93 UFD94, UFD95, UFD200, UFD210, UFD211, UFD220, UFD230, UFD232	26
MANHATTAN	7700	25
MASPRO	SRE90R, SRE90S, SRE250S, SRE350	27
MATSUI	RD600	21
MIMTECH	Nimbus 48C(5)	28
MINERVA	MSR200, MSR250, SAT500, SAT5000	21
MITSUBISHI	SSTPB10, ST-PB10	19
MORGAN		06
NAGAI		29
NEC	3022, 4012	30
NETWORK		31
NIKKO		32

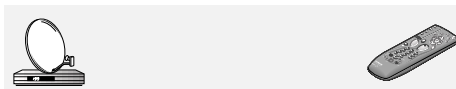

NOKIA	5918(6), 1100(6), 1500(6), 1600, 1602(6), 1700(6), 1800 2200, PRD900 (6), SAT750, SAT800, SAT800+, SAT820S SAT1201, SAT1202, SAT1202E, SAT1202T, SAT2202 SAT3003CS	23
NORDMENDE	SR120ST, SR990IMC, SR600 SRD1000	33 19
OXFORD		08
ORBITECH	X100, X100PLUS	47
PACE	APOLLO, MSS100, MSS200, MSS300/1, MSS500/1 MSS 1000, PRD 800, PRD 800 IRD, PRD 800+ PRD900IRD, PRD900, PRD900IRD, PRD900+ PSR800, PSR800+, PSR900, SBR99, SS-600, SS-9000 SS-9000IRD, SS-9200, SS-9200IRD, SS-9210IRD SSR806, SSR902, SSR906	19 21
PALADIUM	LC200E	21
PALCOM	ML-200, ML-72002, SL-300, SL-4000RP, SL-650R SL-750R, SL-7900RP, SL-8000RP	35
PALSAT		29
PANASONIC	TUS200D TUD250	36 19
PHILIPS	STU330(6), STU350(6), STU430, STU560, STU660 STU801(6), STU802, STU804(6), STU812(6), STU824 STU904, STU901, STU909, STU1400, STU3310(7)	20
PROSAT		19
QUADRAL		13
REDIFFUSION		39
RFT	SAT1000, SAT1100, SAT1200, SAT1500, SAT2000 STASSFURT SAT1(6) SAT3000	21 26-20
SABA	ASR315 SSR290, SSR299, SSR399, SSR420, SSR430, SSR500 SSR880, STR200 SSR700(8)	49 40
SABRE		58
SAKURA	SR800ER, SR8685	41
SALORA	5902	23
SAMSUNG/JUPITER		42
SEEMANS		43
SENTRA		44
SONY	SAT300, SAT301	46
SUNSTAR		06
TATUNG		32
TECHNISAT	VC2001, VC2002	48
TELECS		19
TELEDIREKT		43
TELEFUNKEN	ARDI-K, SR950Z, SR900Z, SR1050Z, SR1050V SR1000Z	49 19
TELEPIU		59
TELEVES		56
THOMSON	TSR610V, TSR710VT ASR11T	50 49
THORN	SAT120, SAT99	58
TOSHIBA	TS540	51 19
TPS		67
UNIDEN	7007	52
UNIVERSUM	LC200E	21
WINERSAT		25
WISI	OR31, OR48, OR49, OR52, OR53, OR54, OR55 OR58, OR59	53
WOSLEY (TANDY)		54

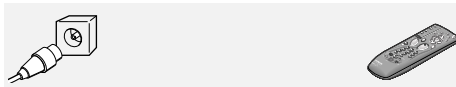

CABLESTAR		60
CABLETIME		60
GI		61
IMPULSE		61
JERROLD		61
MACOM		62
OAK		63
SCIENTIFIC ATLANTA		64
VISIOPASS		20-67
VIDEOTRON		66
VIDEOWAY		66

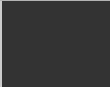
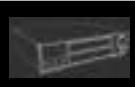

Modèle et numéro de série  
Modell und Seriennummer  
Modello e numero di serie  
Model and serial number  
Model en serienummer  
Modelo y número de serie  
Modelo e número de série  
Μοντέλο και αύξων αριθμός

**THOMSON MULTIMEDIA**

46 quai A. Le Gallo  
92648 Boulogne  
Cedex France  
RCS NANTERRE B 322 019 464

<http://www.thomson-multimedia.com>



**21103130** © Copyright THOMSON multimedia 2000

Adresse du détaillant  
Adresse des Fachhändlers  
Indirizzo del rivenditore  
Dealer's address  
Adres van de verkoper  
Dirección del distribuidor  
Morada do negociante  
Διεύθυνση του εμπόρου

R9000 - Pack 3 / R9078PE