

# STREAM | jockey Satellite Radio | Products



## Vehicle Kit Instruction Manual

Model **X5021**

To activate your Satellite Radio Receiver or for latest news and questions regarding SIRIUS® Satellite Radio service visit [sirius.com](http://sirius.com) or call 1-888-539-SIRIUS (7474).

For accessory & product information visit us at [www.getxact.com](http://www.getxact.com).

**XACT**™

**SIRIUS**  
SATELLITE RADIO

**NOTE!** Do not modify or alter in any way the wires or connections especially to the 12v vehicle adapter. Doing so will prevent the protection provided in the circuitry from functioning properly and result in damaging your receiver. This will void your warranty

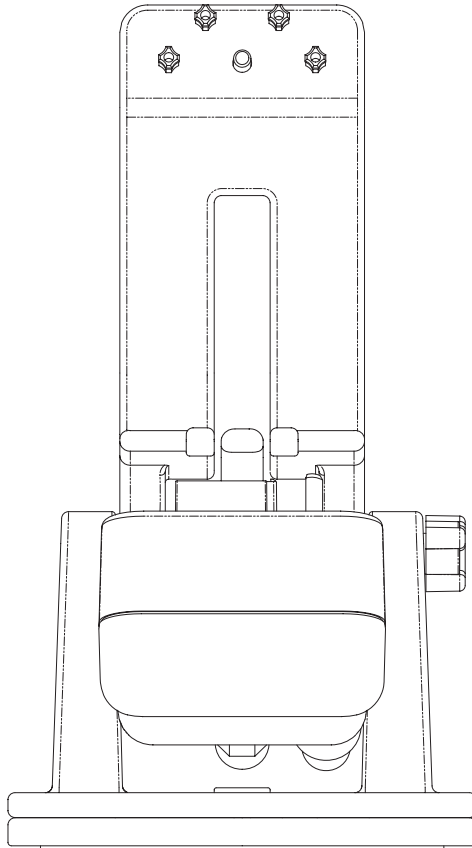

This equipment has been tested and found to comply with the limits for a Class B digital device, pursuant to Part 15 of the FCC Rules. These limits are designed to provide reasonable protection against harmful interference in a residential installation. This equipment generates, uses, and can radiate radio frequency energy and, if not installed and used in accordance with the instructions, may cause harmful interference to radio communications. However, there is no guarantee that interference will not occur in a particular installation. If this equipment does cause harmful interference to radio or television reception, which can be determined by turning the equipment off and on, the user is encouraged to try to correct the interference by one or more of the following measures:

- Reorient or relocate the receiving antenna.
- Increase the separation between the equipment and receiver.
- Connect the equipment into an outlet on a circuit different from that to which the receiver is connected.
- Consult the dealer or an experienced radio/TV technician for help.

Changes or modifications not expressly approved by the Manufacturer for compliance could void the user's authority to operate the equipment

**NOTE!** Use only the appropriate accessories or input devices with your receiver. Use only the 12v Vehicle Adapter that is provided with the kit. It is important that you do not modify it in any way since this will result in damaging your equipment and void the warranty.

## COPYRIGHT / TRADEMARKS

No part of this publication may be reproduced, stored in a retrieval system, or transmitted in any form or by any means, whether electronic, mechanical, photocopying, recording or otherwise without the prior writing of the publisher.



is a registered trademark of SIRIUS® Satellite Radio. To activate your Satellite Radio Receiver or for latest news and questions regarding SIRIUS® Satellite Radio service visit [sirius.com](http://sirius.com) or call 1-888-539-SIRIUS (7474).

# SAFETY PRECAUTIONS

## Warning

Follow these notifications to avoid any traffic accidents or personal injury:

1. Installation must be performed according to this user guide.
2. Do not install the device where it may obstruct your view through the windshield or of your vehicle's indicator displays.
3. Do not install the device where it may hinder the function of safety devices such as an airbag. Doing so may prevent the airbag from functioning properly in the event of an accident.
4. The installation and usage suggestions contained in this user guide are subject to any restrictions or limitations that may be imposed by applicable law. The purchaser should check applicable law for any restrictions or limitations before installing and/or operating this device.
5. Failure to follow these safety instructions and warnings may result in a severe accident.

## Danger

Be aware of the following precautions to prevent fire and avoid personal injury:

1. To avoid short circuits, never put or leave any metallic objects (coins, tools, etc.) inside the device.
2. If the device emits smoke or strange smells, turn the power off immediately and contact your dealer.
3. Do not drop the device or subject it to strong shocks.
4. If the LCD display becomes damaged or broken, do not touch the liquid crystal fluid. The fluid may be dangerous to your health or even fatal. If the liquid crystal fluid contacts your body or clothing, immediately wash it off with soap and water.

## Caution

Do not operate this device in a way that might divert your attention from driving safely. As a driver, you are responsible for safely operating your vehicle in accordance with traffic safety laws at all times.

# INTRODUCTION

## Overview

Thank you for purchasing this product! Your new XACT Vehicle Kit is specifically designed to allow you to mount your plug and play XACT Stream Jockey Satellite Radio in your vehicle.

## Package Contents

Carefully unpack your kit box and ensure that you have the following items.

- Vehicle Docking Cradle
- Vehicle Antenna
- 12v Vehicle Adapter
- User's Guide

In the event that any item is missing or if you find any mismatch or damage, promptly contact your dealer.





Your Xact Stream Jockey Vehicle Kit must be used in conjunction with your plug and play Xact Stream Jockey Satellite Radio Receiver Model Number XTR1.

The easiest way to activate your Satellite Radio Receiver is to log on to [sirius.com](http://sirius.com). You may also call 1-888-539-SIRIUS (7474).

# GETTING STARTED

## Mounting Your XACT Stream Jockey Satellite Radio in a Vehicle

Find an accessible location in your vehicle to install your plug and play satellite radio receiver; usually, this is the dashboard.

-  Do not mount your device where it may obstruct your view through the windshield or your view of your vehicle's indicator displays.
-  Do not mount your device where it may impede your access to the vehicle's controls.
-  Do not mount your device where it may hinder the function of safety devices, such as an airbag. Doing so may prevent the airbag from functioning accordingly in the event of an accident.
-  Mount your satellite radio where it can be easily reached.
-  The device must be directly in line-of-sight of the remote controller.

**NOTE!** Do not modify or alter in any way the wires or connections especially to the 12v vehicle adapter. Doing so will prevent the protection provided in the circuitry from functioning properly and result in damaging your receiver. This will void your warranty

# VEHICLE KIT

## INSTALLATION

**NOTE!** Use only the appropriate accessories or input devices with your receiver. Use only the 12v Vehicle Adapter that is provided with the kit. It is important that you do not modify it in any way since this will result in damaging your equipment and void the warranty.

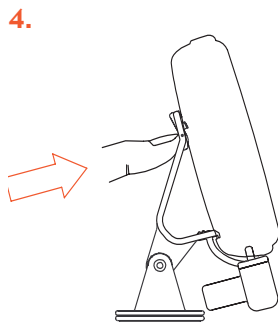
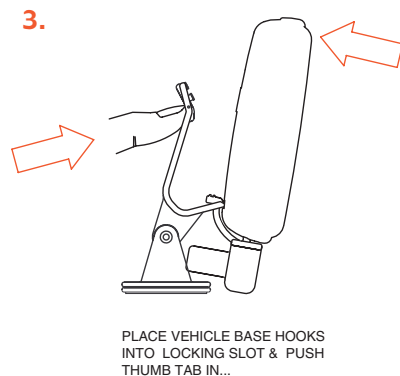
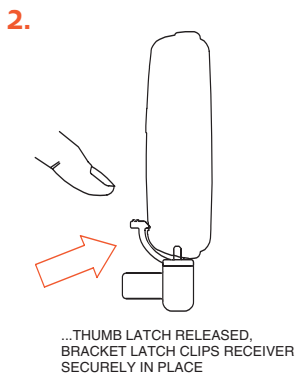
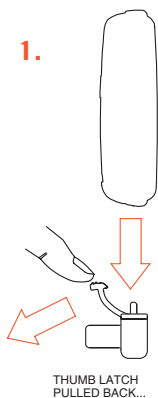

...ROTATE RECEIVER UNIT BACKWARDS  
TO ENGAGE HOOKS AND TURN KNOB  
CLOCKWISE TO LOCK IN THE RECEIVER

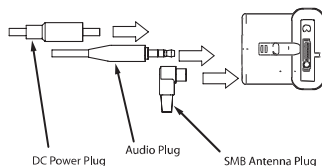
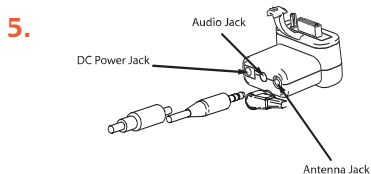

## Problem Solving Section

**For your assistance, we have listed a few common problems below.**

### **The Satellite Receiver does not work.**

Please check the Power Cables. Make sure you have contacted SIRIUS® to activate your Satellite Radio subscription 1-888-539-SIRIUS (7474).

### **I have no sound from my Satellite Receiver.**

Check the audio cables and make sure they are plugged in correctly.

Check the FM Transmitter Setting and make sure that your FM radio is set to the correct channel.

### **The LCD displays Acquiring Signal.**

When the audio signal is lost, a pop-up window with the message “Acquiring Signal” is displayed until the signal is recovered.

### **The LCD Displays Antenna not Detected.**

When no antenna is detected and the signal is lost, a pop-up window with the message “Antenna Not Detected” is displayed until an antenna is detected and the signal is acquired.

### **Reception is weak or the audio has static and is unclear.**

Check that the satellite antenna is connected and not faulty. Change the location of the Antenna making sure it is away from obstructions, see page 3.



# WARRANTY

## Warranty Information

### XACT Communication

#### One-Year Limited Warranty

This limited warranty sets forth all **XACT Communication** responsibilities regarding your product. There are no other expressed or implied warranties from **XACT Communication**.

### Warranty Service Provided

If you purchased the product new from a retail vendor, **XACT Communication** warrants the equipment against defects in material and workmanship for a period of one (1) year from the original date of purchase. This warranty is in lieu of all other express warranties. This warranty begins when you purchase the product and continues for one (1) year unless you sell or rent the unit, in which case the warranty stops.

**XACT Communication** disclaims any implied warranty, including the warranty of merchantability and the warranty of fitness for a particular purpose, as of the date of one year from your original purchase of the product. **XACT Communication** assumes no responsibility for any special, incidental, or consequential damages.

This warranty gives you specific legal rights and you may have other rights which vary from state to state. Some states do not allow the exclusion or limitations of special, incidental, or consequential damages or limitations on how long a warranty lasts, so the above exclusion or limitation may not apply to you.

### Warranty Service Not Provided

This warranty does not cover damage resulting from accident, misuse, abuse, improper installation or operation, lack of reasonable care, unauthorized modification, or the affixing of any attachment not provided by **XACT Communication** with the equipment, and/or loss of parts. This warranty is voided in the event any unauthorized person opens, alters, or repairs the product.

All **XACT Communication** equipment being returned for repair must be suitably packaged.

# WARRANTY

## What To Do for Warranty Service

During the first thirty (30) days, a defective product is eligible for over-the-counter exchange at the retailer from whom it was purchased. After thirty (30) days, the defective product should be returned to the authorized service center. Please allow a minimum of 2-3 weeks for the return of your product. For the shipping address of the authorized service center, call one of the telephone numbers given below.

Your product will be repaired or replaced if examination by the service center determines the product is defective. Products received damaged as a result of shipping will require you to file a claim with the carrier prior to repair. A product received with missing parts or with damage due to abuse, inadequate packing or some other noncompliance with this limited warranty will be returned to you C.O.D., freight collect.

**NOTE:** A product received which was not made by **XACT Communication** or which is not defective as determined by our test procedures will not be repaired and will be returned to you C.O.D., freight collect.

## To Obtain Warranty Service

- Provide proof of the date of purchase within the package.
- Prepay all shipping costs to the authorized service center.
- Include a return shipping address within the package.

Please retain your sales receipt, the carton, the packing materials, and the printed material. The original carton is the best shipping container for the Product should you have to return it.

## For your reference:

Model Number \_\_\_\_\_

ESN Number \_\_\_\_\_

S/N Number \_\_\_\_\_

Date of Purchase \_\_\_\_\_

Name of Dealer \_\_\_\_\_

***XACT Communication Customer Service Telephone Number:  
1-866-466-XACT (9228)***

***OUTSIDE THE U.S.A. AND CANADA CALL: 1-212-481-7950***

***Visit Us on the Web: [www.getxact.com](http://www.getxact.com)***



To activate your Satellite Radio Receiver or for latest news and questions regarding SIRIUS® Satellite Radio service visit [sirius.com](http://sirius.com) or call 1-888-539-SIRIUS (7474).

**XACT™**

**SIRIUS**  
SATELLITE RADIO

Call Toll Free 1-866-466-XACT (9228)  
or Visit our Website:

[www.getxact.com](http://www.getxact.com)