



The Razer Chimaera 5.1 Wireless Gaming Headset for Xbox 360® gives you a true-to-life surround sound experience. Building on our extensive gaming audio expertise from PC gaming, this wireless headset offers pinpoint tournament grade 5.1 positional audio with extra large circumaural ear cups for maximum comfort.

The base station doubles up as a charging dock and audio processing unit, giving you the option to adjust the game sound and link up to four base stations to talk to your teammates over a lag-free, local communication channel.

MASTER GUIDE

CONTENTS

1. Package Contents
2. System & Hardware Requirements
3. Key Features
4. Technical Specifications
5. Installation and Setup / Registration / Technical Support
6. Using Your Razer Chimaera 5.1
7. Legalese

1. PACKAGE CONTENTS

- Razer Chimaera 5.1 Wireless Gaming Headset for Xbox 360®
- Charging Dock Base Station
- Cables:
 - Optical Cable
 - RCA Cable
 - AC Adapter
 - 2.5mm to 2.5mm Stereo Cable (For Controller Connection)
 - 3.5mm to 3.5mm Stereo Cable (For Local Team Communications)™
- 2 AAA Rechargeable Batteries
- Quick Start Guide
- Master Guide

2. SYSTEM & HARDWARE REQUIREMENTS

- Xbox 360®
- Composite Cable (or Component HD AV Cable)

OR

- PC

3. KEY FEATURES



A. 5.1 Surround Sound

B. Left Button 1 – Microphone Volume Up

C. Left Button 2 – Microphone Volume Down

D. Right Button 1 – Volume Up

E. Right Button 2 – Volume Down

F. Left Button 3 – Microphone Mute

G. Left Button 4 – Power Button

H. Right Button 3 – Mode Button (Xbox LIVE / Local Team Communications Toggle)

I. Right Button 4 – Volume Mute / Synchronization Button

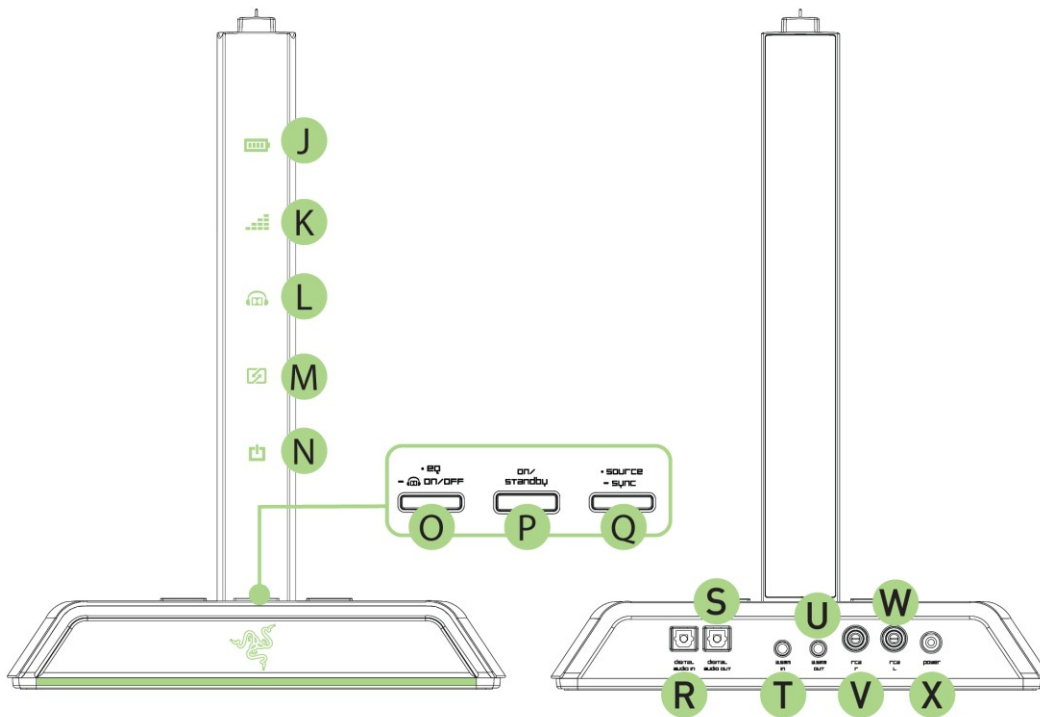

J. Charging LED

K. EQ LED

L. Dolby Headphone LED

M. Mode (Xbox LIVE / Local Team Communications) LED

N. Standby LED

O. EQ/ Dolby Headphone Button

P. Standby Button

Q. Source / Synchronization Button

R. Digital Audio In

S. Digital Audio Out

T. 3.5 mm In

U. 3.5 mm Out

V. RCA In Right

W. RCA In Left

X. AC Connector

4. TECHNICAL SPECIFICATIONS

Wireless Headset Dimensions (in mm): 200 (W) x 204 (H) x 88 (D)

HEADPHONES

- Radio Frequency: 5.8GHz
- Dolby® Headphone / Dolby® Pro Logic® II / Dolby® Digital
- Wireless Range: 33 Ft / 10m
- Frequency Response: 20 - 20,000 Hz
- Impedance: 32Ω at 1kHz
- Sensitivity (@1kHz, 1V/Pa): 105dB +/- 2dB
- Drivers: 50mm Neodymium Magnets
- Batteries: 2 AAA Batteries (Up to 8 Hours Battery Life)
- Charging Time: 3 Hours

MICROPHONE

- Frequency Response: 130 - 10,000 Hz
- Sensitivity (@1kHz, 1V/Pa): -42 ± 2dB
- Signal-to-Noise Ratio: >55 dB
- Pick-up Pattern: Uni-directional

5. INSTALLATION AND SETUP / REGISTRATION / TECHNICAL SUPPORT

BATTERY INSTALLATION

For best results, fully charge the batteries before first time use of the Razer Chimaera 5.1. A depleted battery will be fully charged in about 3 hours.

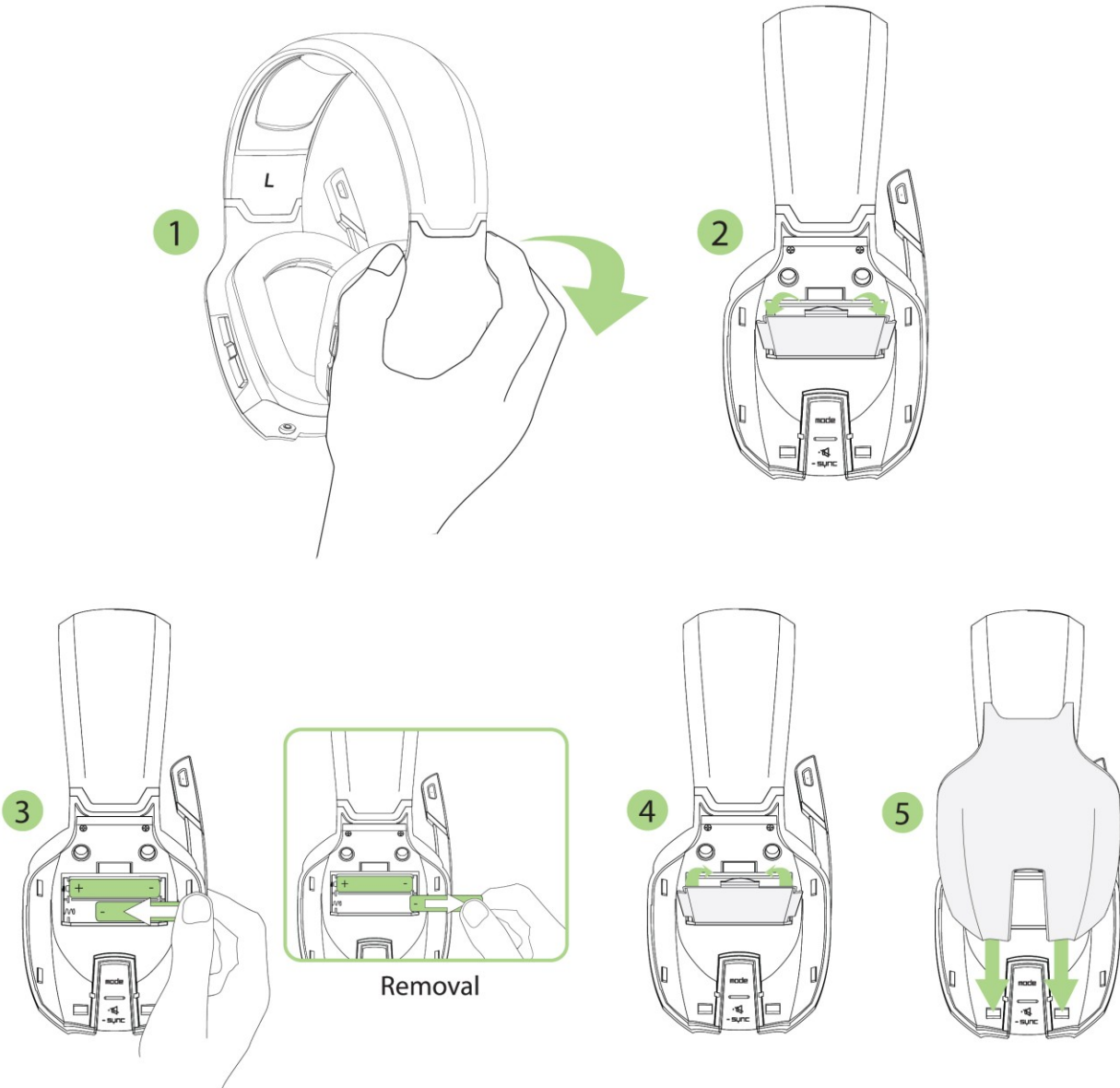

CAUTION: Use AAA batteries and the supplied adaptor only.

POWER

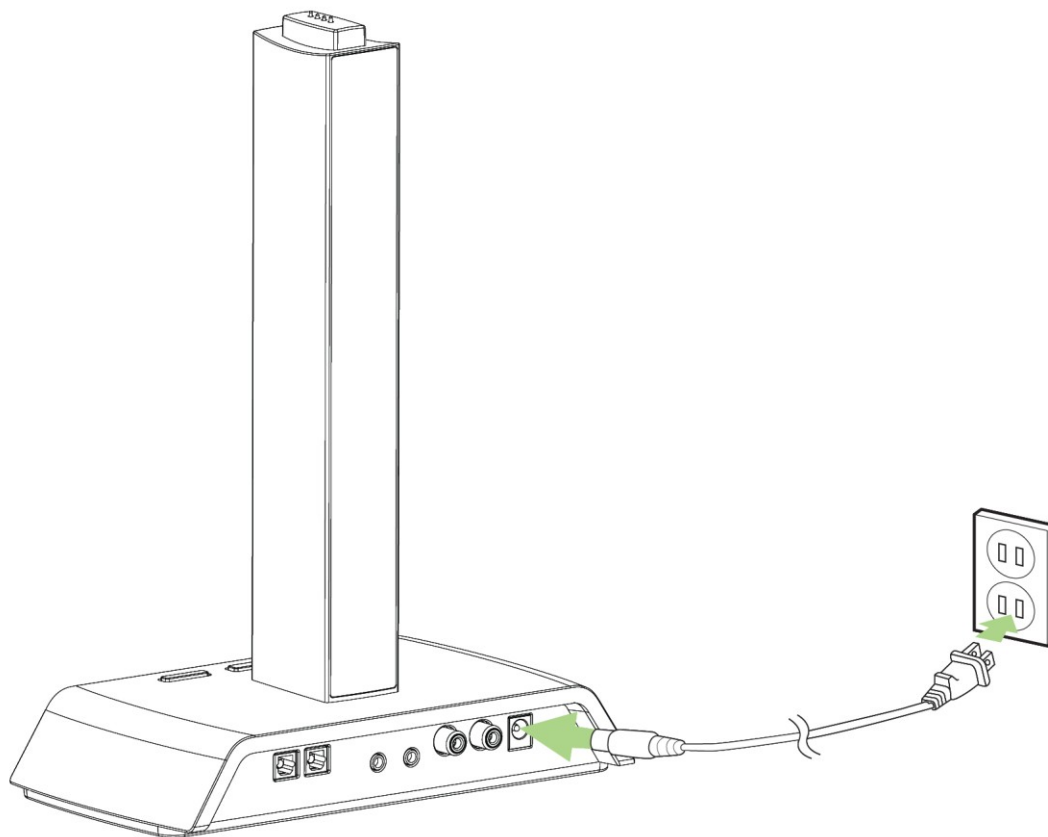

For US*, Japan and Taiwan
- Voltage: 100-240V ~ 50/60/Hz

* Please note that in the United States, a polarized plug is used. It can only be inserted one way.



For France, Germany, Sweden, Switzerland and Korea
- Voltage: 100-240V ~ 50/60/Hz

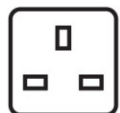

For UK, Singapore, India and Hong Kong
- Voltage: 100-240V ~ 50/60/Hz



For Australia
- Voltage: 100-240V ~ 50/60/Hz

PAIRING

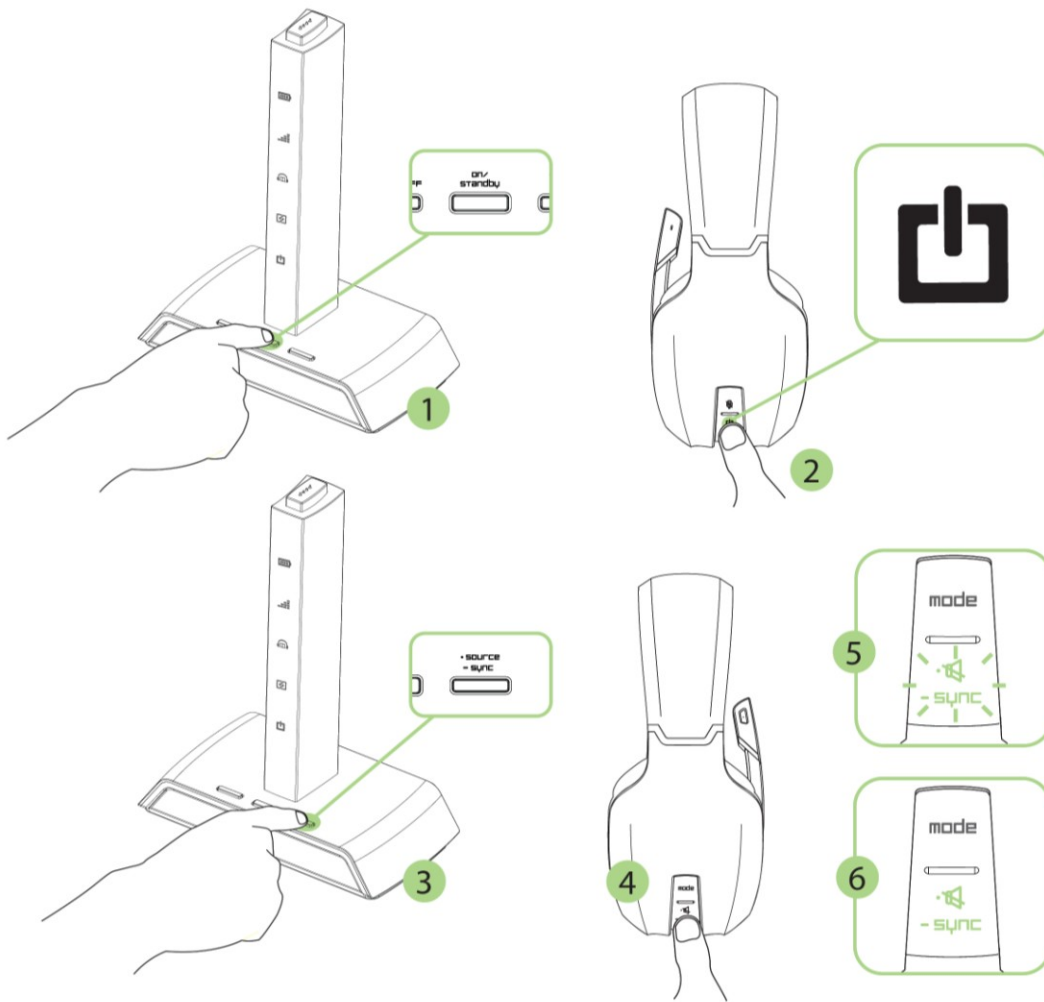

CONTROLLER



CONNECTIVITY TO XBOX 360®

AUDIO

You can choose between 3 methods of installation depending on your configuration.

1. Plugging directly into the Xbox 360® (Xbox 360 S)

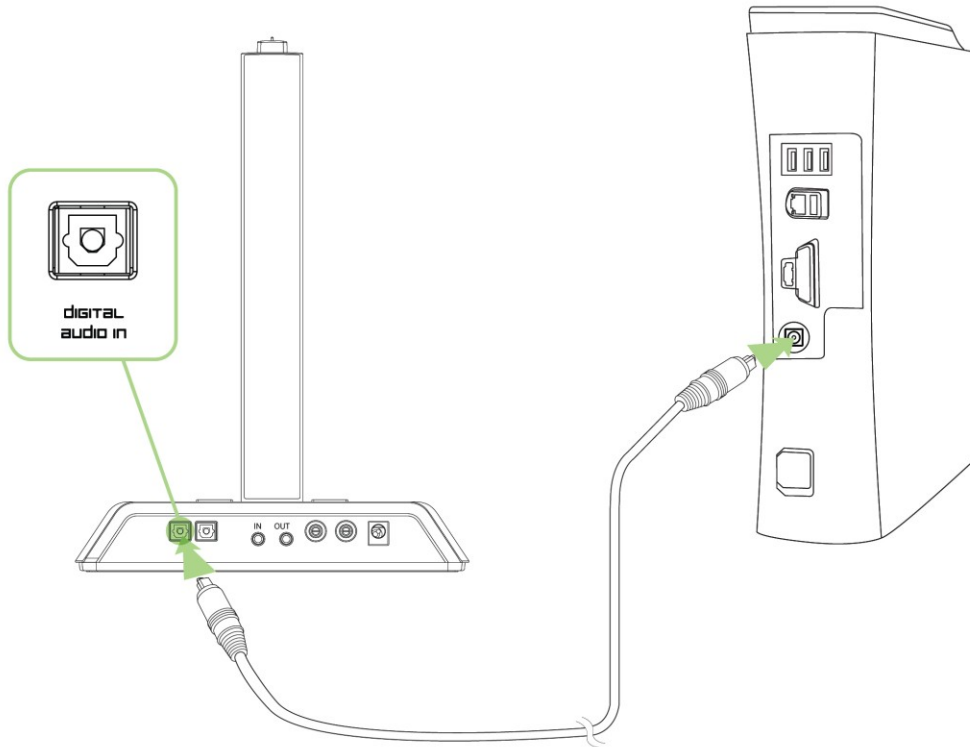

2. Using a Component HD AV Cable with Digital Audio Output

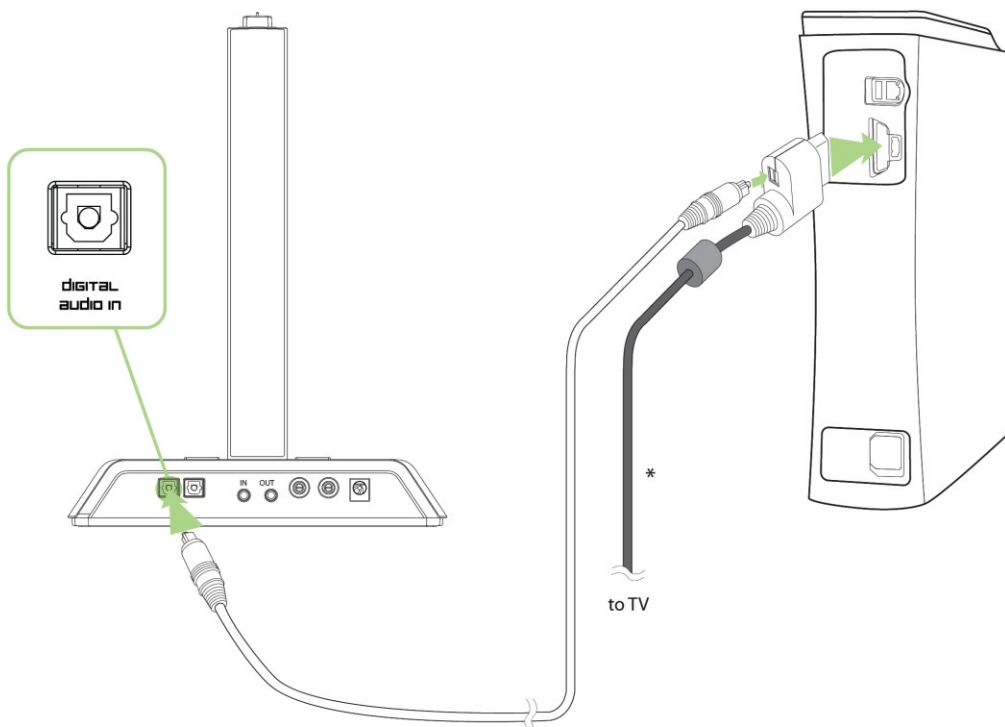

* Not Included

3. Using a Composite AV Cable without Digital Audio Output

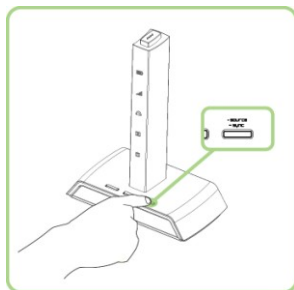
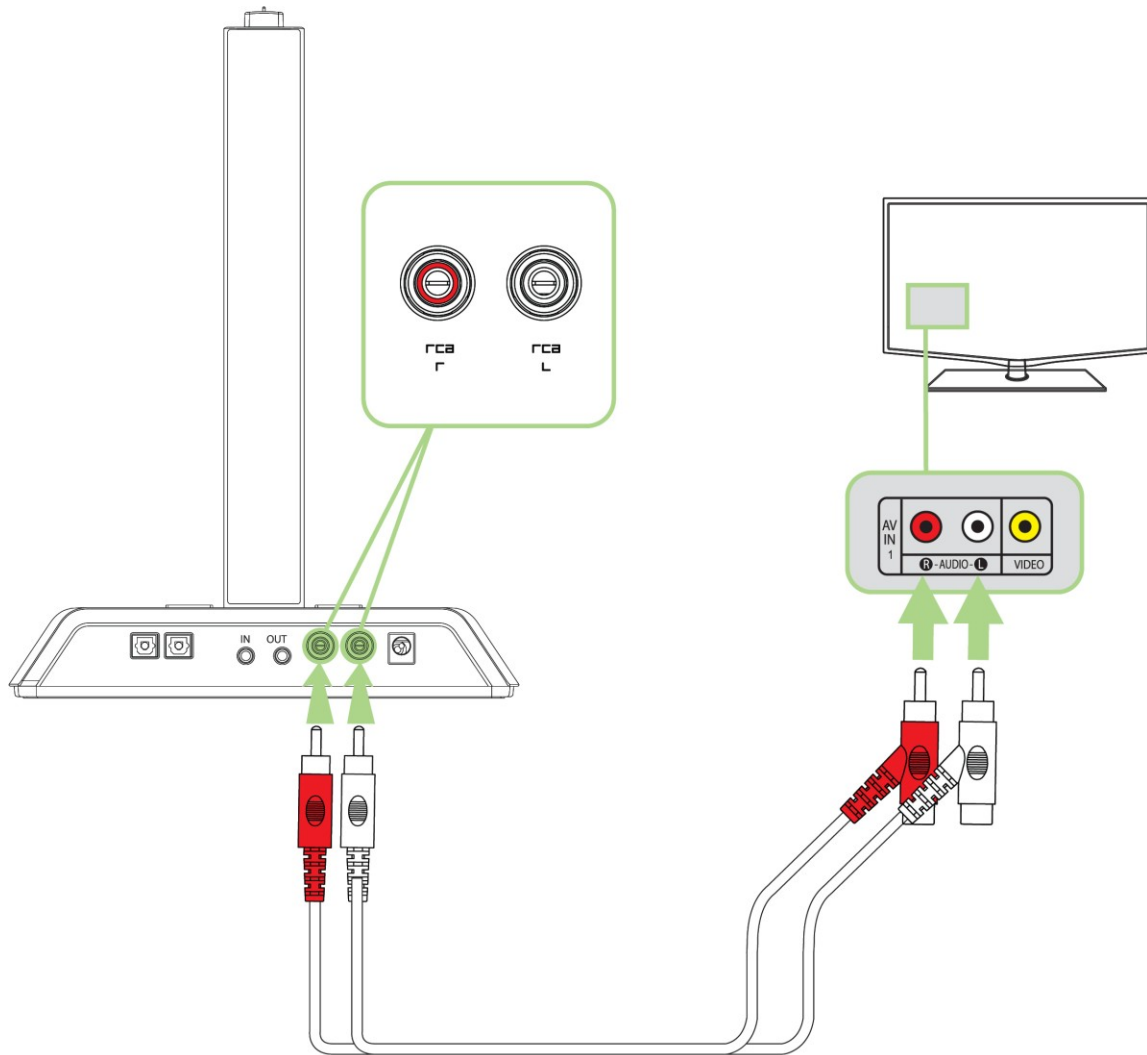

On first time usage, press **SOURCE** / **SYNC** to change the source from Digital Audio In to RCA In.

CONNECTION TO ANOTHER RAZER CHIMAERA 5.1

You can connect up to 4 Base Stations (purchased separately) to create a local communication channel for team talk through your Razer Chimaera 5.1 Headset.

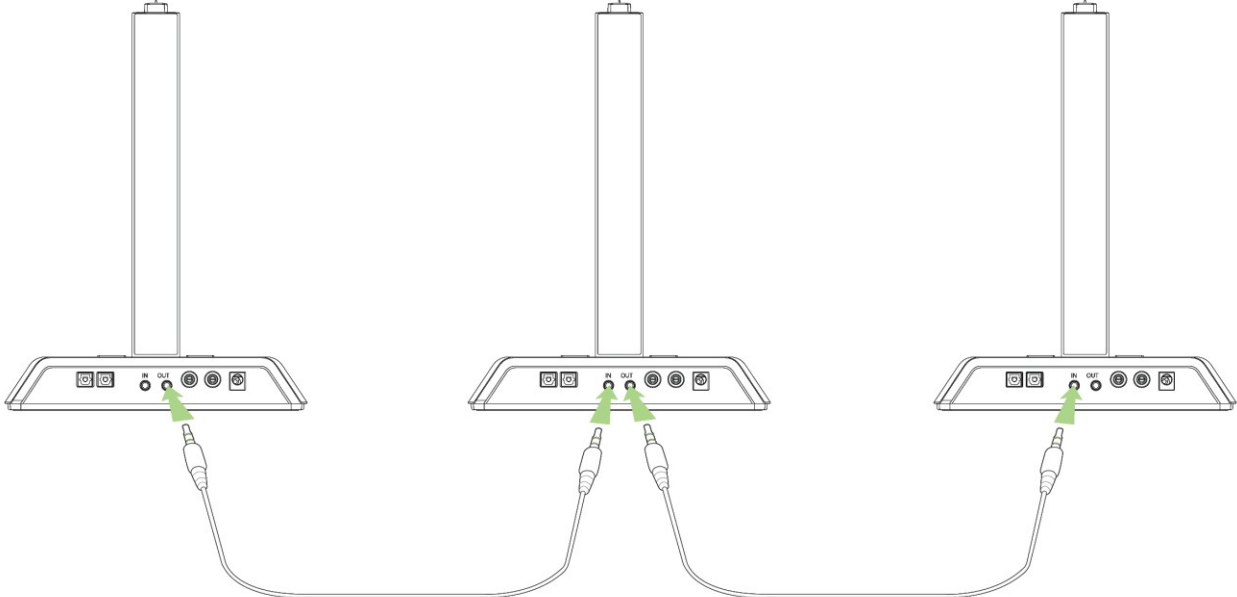

CONNECTIVITY TO PC

NOTE: When transitioning back from PC to Xbox usage, we advise you to remove the jacks connected to your PC.

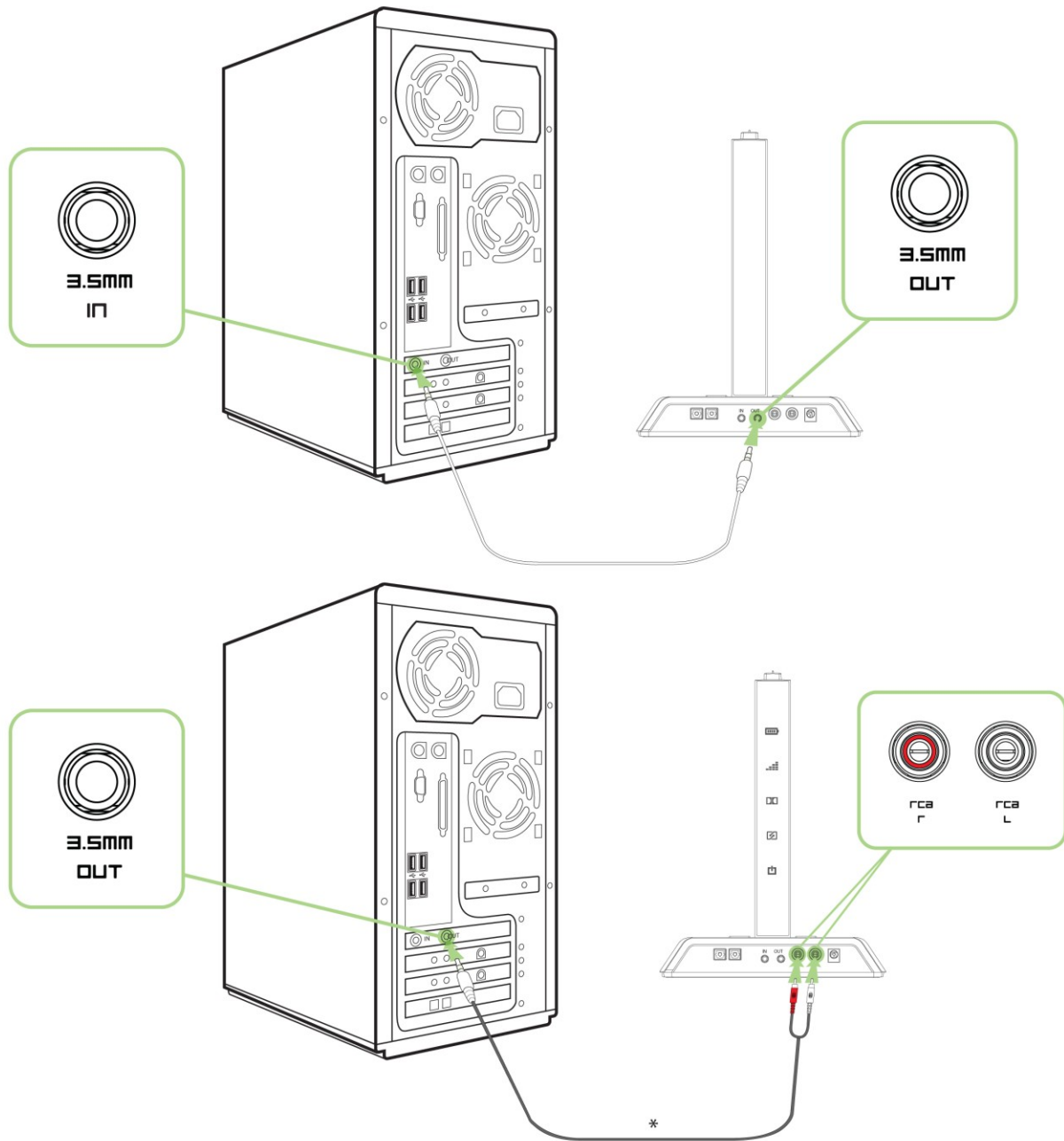

* Not Included

REGISTERING YOUR RAZER CHIMAERA 5.1

Please visit www.razerzone.com/registration/ for online product registration.

What you'll get:

- 1 year limited manufacturer's warranty
- Free online technical support at www.razersupport.com

6. USING YOUR RAZER CHIMAERA 5.1

MUTING THE MICROPHONE

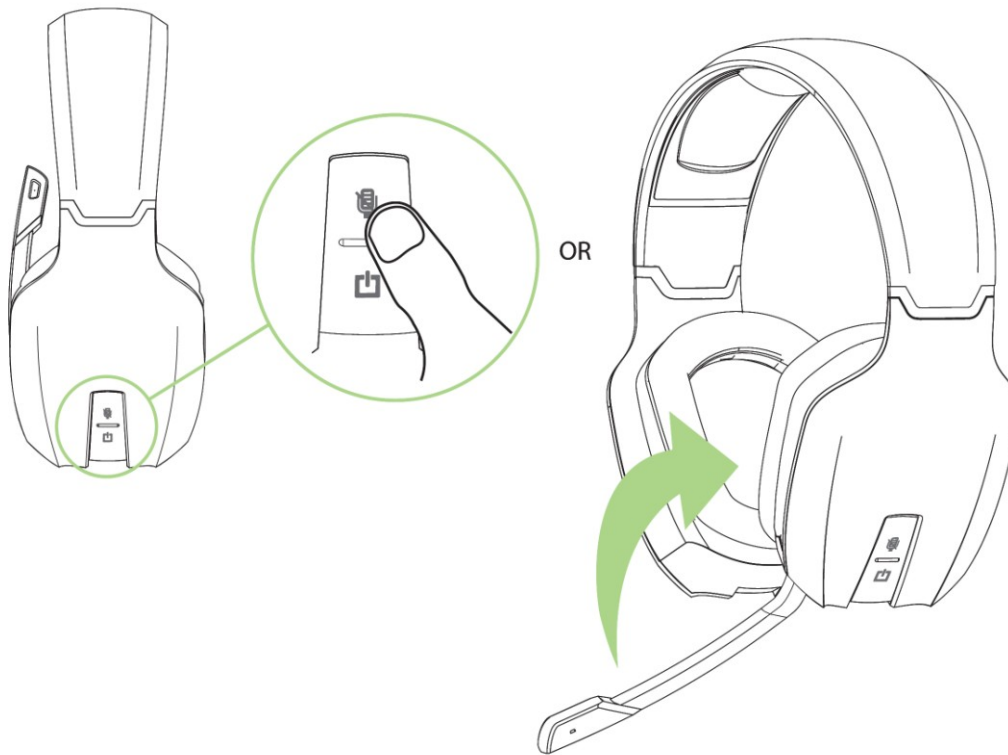

Press Left Button 3.

OR

Twist the microphone upwards.

POWER MANAGEMENT





If the headset does not receive an audio signal for 10 minutes, the headset will automatically power down to conserve energy.

If the power in the headset drops below a 10% charge, a beeping sound will be emitted from the unit at a 2 minute interval. At this point, please charge the headset.

USING THE BUTTONS



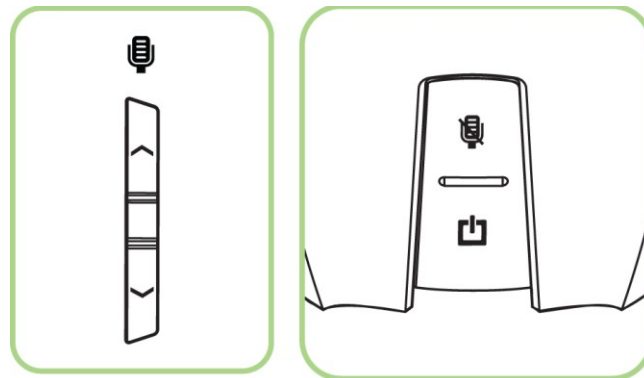

HEADSET

Buttons On The Left Ear Cup

- Press  and  to increase/decrease the microphone volume.
- Press  to mute the microphone.
- Hold  to power on/off the headset.



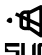

Buttons On The Right Ear Cup

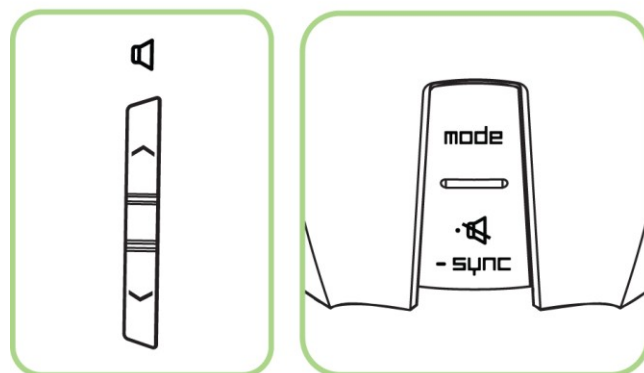
- Press  and  to increase/decrease the audio volume.
- Press **mode** to switch between Xbox LIVE and Local Team Communications mode.
- Hold **mode** for 3 seconds to toggle between incoming and outgoing microphone volume. This only functions in Xbox LIVE mode. When the headset is turned on, incoming microphone volume is the default setting.
- Press  - **sync** to mute the audio volume.
- Hold  - **sync** to pair the headset with the base station.

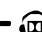

BASE STATION

EQ/Dolby Headphone Button

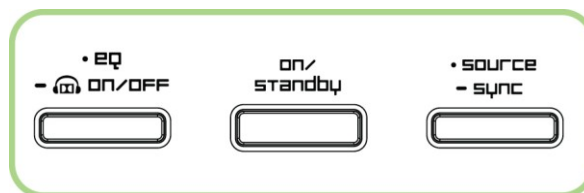

- Press  -  **ON/OFF** to toggle between Normal, Bass and Treble modes.
- Hold  -  **ON/OFF** for 2 seconds to turn on/off the Dolby Headphone mode.



Standby Button

- Press  to turn on/off the power of the base station.











Source/Synchronization Button

- Press  to toggle between Digital Audio In and RCA In. The toggle does not work in Local Team Communications mode.
- Hold  to pair the base station with the headset.













LED STATUS INDICATORS

The Razer Chimaera 5.1 has various LED status indicators on the headset and charging dock base station.

HEADSET

	CONSTANT	FLASHING	OFF
Power	 On	 Battery <10%	 Off
Microphone	 Mute	NA	 Unmute
Volume / Synchronization	 Mute	 Pairing	 Unmute/Unpaired
Mode	 Local Team Communications	NA	 Xbox LIVE®

CHARGING DOCK STATION

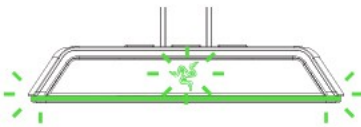
Charging	 100% charged	 <100% charged	 No Headset Docked
Equalizer	 Normal	 Bass	 Treble
 Dolby Headphone	 On	On	 Off
Mode	 Local Team Communications	Local Team Communications	 Xbox LIVE®
Standby	 Unit on Standby		
Synchronization	 Pairing		

7. LEGALESE

COPYRIGHT AND INTELLECTUAL PROPERTY INFORMATION

©2011 Razer USA Ltd. Patent Pending. All Rights Reserved. Razer™, the Razer Triple-Headed Snake logo, the Razer distressed word logo and other trademarks contained herein are trademarks or registered trademarks of Razer USA Ltd and/or its affiliated or associated companies, registered in the United States and/or other countries. Windows and the Windows logo are trademarks of the Microsoft group of companies.

Razer USA Ltd (“Razer”) may have copyright, trademarks, trade secrets, patents, patent applications, or other intellectual property rights (whether registered or unregistered) concerning the product in this Master Guide. Furnishing of this Master Guide does not give you a license to any such copyright, trademark, patent or other intellectual property right. The Razer Chimaera 5.1 product (the “Product”) may differ from pictures whether on packaging or otherwise. Razer assumes no responsibility for such differences or for any errors that may appear. Information contained herein is subject to change without notice.

Manufactured under license from Dolby Laboratories.

Dolby, Pro Logic and the double-D symbol are trademarks of Dolby Laboratories.

LIMITED PRODUCT WARRANTY

For the latest and current terms of the Limited Product Warranty, please visit

<http://warranty.razerzone.com>.

LIMITATION OF LIABILITY

Razer shall in no event be liable for any lost profits, loss of information or data, special, incidental, indirect, punitive or consequential or incidental damages, arising in any way out of distribution of, sale of, resale of, use of, or inability to use the Product. In no event shall Razer’s liability exceed the retail purchase price of the Product.

COSTS OF PROCUREMENT

For the avoidance of doubt, in no event will Razer be liable for any costs of procurement unless it has been advised of the possibility of such damages, and in no case shall Razer be liable for any costs of procurement liability exceeding the retail purchase price of the Product.

GENERAL

These terms shall be governed by and construed under the laws of the jurisdiction in which the Product was purchased. If any term herein is held to be invalid or unenforceable, then such term (in so far as it is invalid or unenforceable) shall be given no effect and deemed to be excluded without invalidating any of the remaining terms. Razer reserves the right to amend any term at any time without notice.