

morphy richards®

Essentials Compact Steam Cleaner

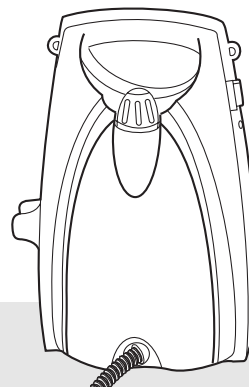

Please read and keep these instructions



getting the best from your new cleaner...

Please study all instructions carefully before use.

No steam

- Check the power supply.
- Check the heater switch is set to the on (I) position.
WARNING: If the cleaner has been boiled dry, it must be switched off for a few minutes to allow the safety cut-out to reset.
- Check water is in the tank. We recommend the use of filtered water to reduce the scale.
- The cleaner may need descaling.
(In hard water areas, the cleaner will require regular descaling. Follow the instructions on page 7).

Using the steamer

- When using the steamer, always keep it vertical.

2year
guarantee

CE



UK Helpline: 0845 077 7700
Ireland 1800 409 119

www.morphyrichards.com

Important safety instructions

The use of any electrical appliance requires the following common sense safety rules.

Primarily there is danger of injury or death and secondly the danger of damage to the appliance. These are indicated in the text by the following two conventions:

WARNING: Danger to the person!

IMPORTANT: Damage to the appliance!

In addition we offer the following safety advice.

Location

- Do not use or keep this product outside.
- Do not store the appliance near hot ovens or heating appliances.

Children

- Never allow children to use this appliance.
- Children do not understand the dangers associated with operating electrical appliances.
- Children should be supervised to ensure that they do not play with the appliance, or stumble over the power cord.

Personal safety

- **WARNING: The filling cap must not be opened during use.**
- Let the cleaner cool for a few minutes before re-filling.
- To protect against fire, electric shock and personal injury, do not immerse cord, plug or cleaner in water or other liquid.
- The plug should be removed from the wall socket after use, before cleaning, filling or changing the accessories.
- The accessories get very hot. Allow to cool before changing.
- Make certain the steam has stopped before changing the accessories or putting the hose aside.
- **WARNING: Do not discharge the steam towards people. Danger of scalding.**
- **WARNING: Never touch the plug or cable with wet hands.**

- **WARNING: Danger of scalding.** →
- Steam must not be directed towards equipment containing electrical components, such as the interior of ovens.

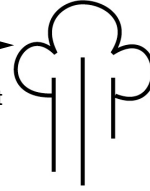

- This appliance is not intended for use by persons (including children) with reduced physical, sensory or mental capabilities, or lack of experience and knowledge, unless they have been given supervision or instruction concerning use of the appliance by a person responsible for their safety.

Other safety considerations

- Do not use any chemical detergents, perfumes, alcohol etc in water.
- Repairs to electrical appliances are only to be undertaken by trained personnel. Unprofessional repairs can be dangerous for users.
- Use only genuine Morphy Richards spare parts and accessories.
- If the electrical cable becomes damaged, the complete cable assembly must be replaced. Do not attempt this task yourself, contact Morphy Richards using the replacement parts number on the front of this leaflet.
- The appliance must never be left running when unsupervised.
- This steam cleaner is intended for domestic use only. Misuse or use for commercial or any other purpose will render the guarantee invalid.

Product safety

- Never modify the cleaner in any way.
- When using the cleaner, always keep it vertical.

Electrical requirements

Check that the voltage on the rating plate of your appliance corresponds with your house electricity which must be A.C. (alternating current).

If the socket outlets in your home are not suitable for the plug supplied with this

appliance, the plug should be removed and the appropriate one fitted.

WARNING: The plug removed from the mains lead, if severed, must be destroyed, as a plug with a bared flexible cord is hazardous if engaged into a live socket outlet.

WARNING: This appliance must be earthed.

Should the fuse in the 13 amp plug require changing, a 13 amp BS1362 fuse must be fitted.

Illustration

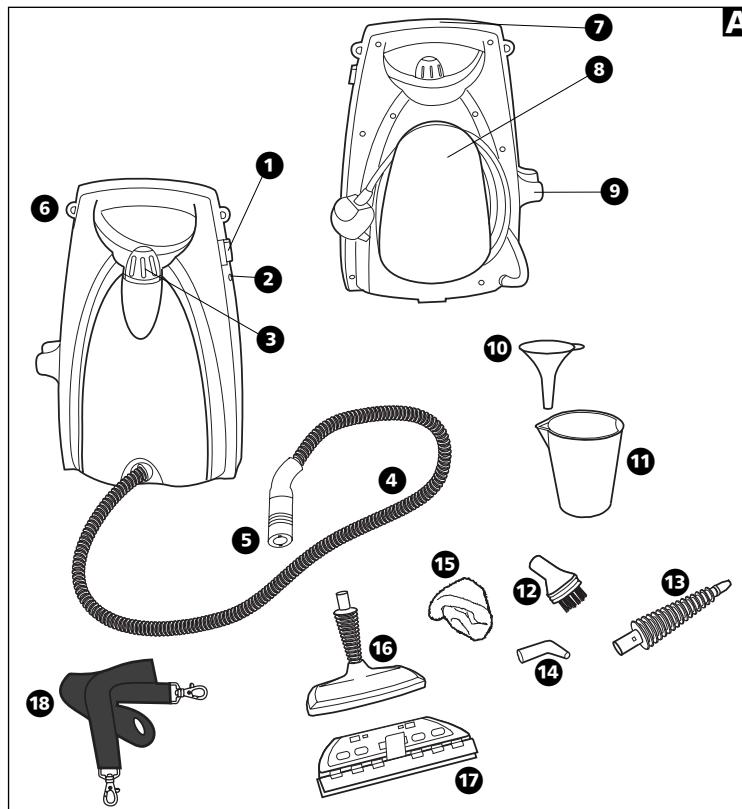

Features

- ❶ Heater switch
- ❷ 'Heater on' indicator light
- ❸ Filler cap
- ❹ Flexible hose
- ❺ Hose end
- ❻ Carry strap fixing locations
- ❼ Carrying handle
- ❽ Cord storage
- ❾ Hose end storage holder

Accessories you should have

- ❿ Funnel
- ⓫ Filling jug
- ⓬ Round brush
- ⓭ Jet nozzle
- ⓮ Directional nozzle
- ⓯ Cotton socks (3 of)
- ⓰ Upholstery nozzle
- ⓱ Window squeegee attachment
- ⓲ Carrying strap
- Storage bag (not shown)

Operation

Please remember that the steam cleaner operates by emitting steam at an increased temperature of 115°C. Never use it on objects or surfaces which cannot resist this temperature, delicate materials, dralon, plastic, natural fur etc. Where any doubt exists, check carefully on a part of the material where minor marks will not matter.

Filling the water tank

- To fill, unscrew the filler cap **B** anti-clockwise **B**.
- Fill the boiler with a maximum of 1 litre of water by using the funnel and the filler jug provided **C**.
Three full jugs make up the 1 litre required. **WARNING: Do not overfill.**
 - Do not use any detergent.
- WARNING: Screw the filler cap clockwise to tighten. Tighten fully.**

Heater switch

- When the water tank has been filled, insert the plug into the power socket.
- Fit the required nozzle/accessory.
- Switch the cleaner on by pressing the

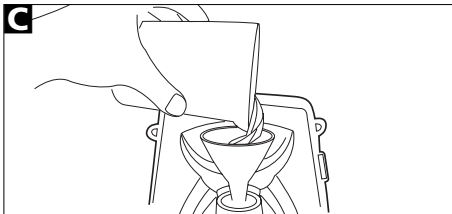
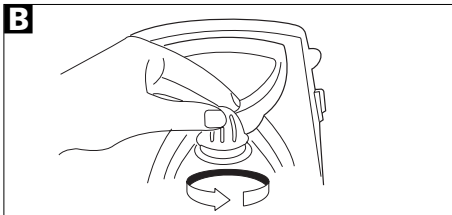

heater switch **D** to the on position **D**. The boiler will take approximately 5 minutes to heat up.

WARNING: As soon as the boiler is up to temperature, steam will begin to be emitted from the nozzle. Hold the nozzle away from the body and away from other persons.

- Water may be ejected at first. Aim the nozzle into a sink or bucket.

WARNING: Do not block the end of the nozzle. If the nozzle becomes blocked, a safety relief valve releases steam pressure from the base of the filler cap.

Note: the 'heater on' light will cycle on and off during use, this is normal.

Note: If the product is switched off before the boiler is empty, steam will continue to be emitted for up to 2 minutes. You can continue to use the steam to clean or rest the hose in a sink until the steam has dispersed.

Refilling

When the steam flow begins to slow, the unit is ready for refilling.

- Switch off the cleaner before refilling.
- Unplug from the mains socket and leave for a few minutes to cool.

WARNING: Allow any steam to disperse away before attempting to remove the filler cap.

- Carefully unscrew the cap.

WARNING: Take care as the inner part of the cap will be hot.

- Use warm water to reduce heat-up time. Refill using the funnel and the jug.

- The water tank should be emptied after use. Allow to cool completely before emptying.

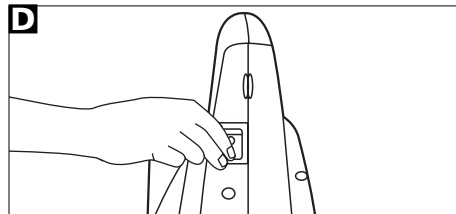

Attaching accessories

WARNING: Always switch the unit off and wait for the steam to disperse before attaching and detaching accessories.

WARNING: Never direct steam at electrical components/fittings. If in doubt about the suitability of steam for cleaning an appliance, contact the appliance manufacturer for advice prior to cleaning.

IMPORTANT: It is strongly recommended that after fitting the new attachment, the hose end is held over the sink initially as a small amount of hot water may be ejected before the steam reaches full pressure.

1 Jet nozzle

Attach the jet nozzle **15** to the hose end **5** by lining up the lugs and twisting to lock in place **E**.

The jet nozzle is ideal for:

- General cleaning tasks, for work surfaces, tile grouting and for awkward corners and spaces.
- Defrosting freezers and removing dust from plants.

The closer you hold the jet nozzle to the surface to be cleaned, the better the cleaning results.

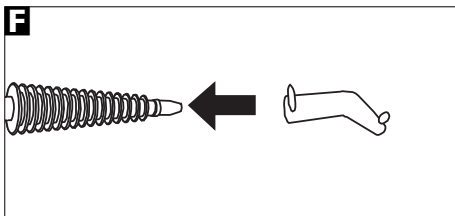
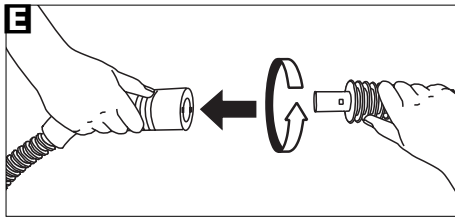

The following accessories can be added onto the jet nozzle by simply pushing to fit:

2 Directional nozzle

Push the directional nozzle onto the jet nozzle **F**.

The directional nozzle **14** is ideal for getting steam into awkward spaces and for directing steam under the lip of sink/toilet bowls, grout, tap ware, venetian blinds, and sliding door runners.

3 The round brush

Push the round brush onto the jet nozzle **G**.

The round brush **12** is ideal for hob cleaning and tile grouting depending on the application.

4 Upholstery nozzle

Alternatively, the upholstery nozzle **16** can be attached to the hose end **5** **H**.

- This can be used for cleaning upholstery or removing creases from clothing.
- Place garments onto a clothes hanger and spray steam at a distance of around 10-20cm.

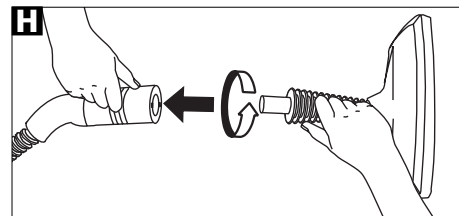
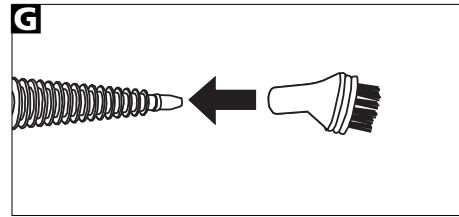

5 Cotton socks

Stretch the sock over the upholstery attachment **I**.

Switch on the steam and move the sock covered brush gently over surfaces to be cleaned. Replace sock regularly so that more dirt can be collected and to avoid too much moisture being applied. Extra socks can be ordered by using our helpline.

WARNING: Always test on an inconspicuous area first. Never use on materials that can't resist high temperature, such as dralon, natural fur etc.

6 Window squeegee attachment

Attach the window squeegee attachment **17** to the upholstery nozzle by attaching the hooks on the upholstery nozzle to the tabs on the window squeegee and push the main tab over the upholstery nozzle **J**.

This accessory is ideal for cleaning windows, patio doors, conservatory glass, tiles and shower screens.

To clean windows, start at the top of the window, pressing the squeegee to the surface and drag downwards. Move the squeegee in straight passes from top to bottom. Wipe the rubber blade and the bottom edge of the window dry after each pass.

WARNING: Do not use on very cold glass, as the sudden temperature change may crack the glass.

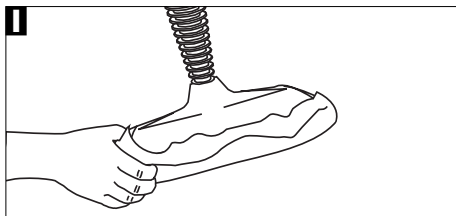

Sanitising bedding and upholstery

Sanitising and removing dust mites and allergens from bedding and upholstery

Fit the upholstery nozzle and pass the steam slowly and evenly over the surface ensuring all areas are treated. Repeat the process. Leave the mattress to dry thoroughly before covering.

Carrying strap

Your steam cleaner comes with a carrying strap for added convenience.

The carrying strap **13** can be clipped on the fixing locations **6** either side of the cleaner **K**.

WARNING: Use only with the cord storage side of the cleaner towards your body.

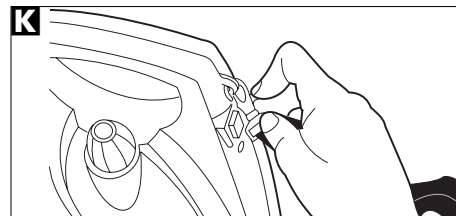
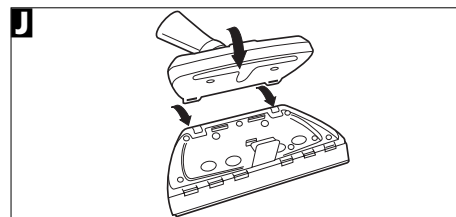

After use

- 1 Switch the cleaner off and unplug from the socket. Wait until the cleaner has cooled down completely.
- 2 Empty the water tank. Allow the inside of the water tank to dry out before replacing filler cap.

Rinse water tank

Regularly rinse the water tank to release any limescale deposits that have collected on the bottom of the tank. Use clean cold water and fit the filler cap to allow vigorous rinsing.

Descaling

If the 'heater on' light goes off before the cleaner starts to steam, this indicates the thermostat has operated too soon and the cleaner needs descaling.

In order to prolong the life of your cleaner, you should descale the boiler at least every 6 months.

- 1 Switch the cleaner off, unplug and allow to cool.
- 2 Empty any water out of the tank.
- 3 Mix the descaler in the measuring jug using warm water. We recommend using 50gm of citric acid crystals per 1 litre of water. Citric acid crystals are available from most pharmacies.
- 4 Pour 1 litre of the descaler solution into the tank.
- 5 Fit the cap and tighten fully.
- 6 Using the handle, move the steam cleaner about to swill the solution around the tank.
- 7 Leave for 30 minutes.
- 8 Empty the solution carefully.
- 9 Rinse the tank with clean warm water, then empty.
- 10 Wipe the outside of the cleaner with a damp cloth to remove all traces of descaler solution.

WARNING: Do not switch on the heater with the descaling solution inside.

Note: We recommend the use of filtered water to minimise scale build up.

Care and maintenance

Your cleaner is manufactured to withstand normal day-to-day use, but an occasional wipe over with a damp cloth will help maintain its good looks. Abrasive cleaners should not be used.

Helpline

If you have any difficulty with your appliance, do not hesitate to call us. We are likely to be more help than the store from where it was bought.

Please have the following information ready to enable our staff to help you:

- Name of the product
- Model number as shown on the back of the appliance.
- Serial number as shown on the back of the appliance.

UK Helpline

0845 077 7700

Ireland Helpline

1800 409 119



For electrical products sold within the European Community. At the end of the electrical products useful life it should not be disposed of with household waste. Please recycle where facilities exist. Check with your Local Authority or retailer for recycling advice in your country.

Two year guarantee

It is important to retain the retailer's receipt as proof of purchase. Staple your receipt to this back cover for future reference.

Please quote the following information if the product develops a fault. These numbers can be found on the back of the product.

Model no. **Serial no.**

All Morphy Richards products are individually tested before leaving the factory. In the unlikely event of any appliance proving to be faulty within 28 days of purchase, it should be returned to the place of purchase for it to be replaced.

If the fault develops after 28 days and within 24 months of original purchase, you should contact the Helpline number quoting Model number and Serial number on the product, or write to Morphy Richards at the address shown. You will be asked to return the product (in secure, adequate packaging) to the address below, along with a copy of proof of purchase. Subject to the exclusions set out below (1-5), the faulty appliance will then be repaired or replaced and dispatched usually within 7 working days of receipt.

If for any reason this item is replaced during the 2 year guarantee period, the guarantee on the new item will be calculated from original purchase date. Therefore it is vital to retain your original till receipt or invoice to indicate the date of initial purchase.

Morphy Richards products are intended for household use only.

Morphy Richards has a policy of continuous improvement in product quality and design. The company, therefore reserves the right to change the specification of its models at any time.

To qualify for the 2 year guarantee, the appliance must have been used according to the manufacturer's instructions. For example, the product must have been regularly descaled, as instructed.

EXCLUSIONS

Morphy Richards shall not be liable to replace or repair the goods under the terms of the guarantee where:

- 1 The fault has been caused or is attributable to accidental use, misuse, negligent use or used contrary to the manufacturer's recommendations or where the fault has been caused by power surges or damage caused in transit.
 - 2 The appliance has been used on a voltage supply other than that stamped on the products.
 - 3 Repairs have been attempted by persons other than our service staff (or authorised dealer).
 - 4 Where the appliance has been used for hire purposes or non domestic use.
 - 5 The guarantee excludes consumables such as the cotton cloths.
- This guarantee does not confer any rights other than those expressly set out above and does not cover any claims for consequential loss or damage. This guarantee is offered as an additional benefit and does not affect your statutory rights as a consumer.
 - This guarantee is valid in the UK and Ireland only.



morphy richards®

The After Sales Division
Registered address
Morphy Richards Ltd, Mexborough
South Yorkshire, England, S64 8AJ

Helpline (office hours)
UK 0845 077 7700
Republic of Ireland 1800 409 119