

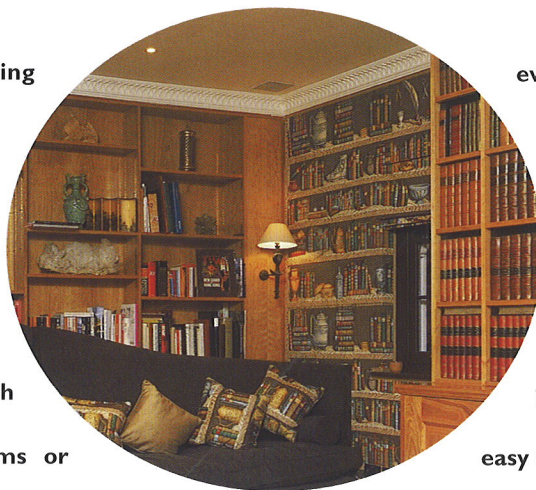

Purpose-built for flush mounting into walls and ceilings, the Ci Series delivers KEF audio quality as unobtrusively as possible - and since all models are designed to withstand harsh environments such as bathrooms or



even outside (under the eaves), there's virtually no limit to the design possibilities they open up. And with KEF's simple and ingenious mounting system, you'll also find them amazingly easy and rapid to install.

### Ci Reference 2000, 1500 and 1000

Discrete installation needn't involve sacrificing audio integrity. With a UNI-Q® array to Reference Series standards and two high specification 160mm (6 1/2") bass drivers, the Ci Series Reference 2000 combines 200 Watts power handling with 91dB sensitivity - and its superb off-axis dispersion characteristics allow far greater latitude of positioning, whether for hi-fi or home theatre applications. Sharing the same audiophile quality engineering on a slightly more modest scale, the 3-way Ci 1500 and 2-way Ci 1000 deliver similar levels of listener involvement and enjoyment for smaller spaces and less demanding applications. All models come magnetically shielded to avoid interference with other electronics.



Ci 2000



Ci 1500



Ci 1000

Model	Ci Reference 2000	Ci Reference 1500	Ci Reference 1000
Design	3 way UNI-Q, 4 driver	3 way UNI-Q, 3 driver	2 way UNI-Q, 2 driver
Frequency response at 15' horizontally off axis ±3 dB	55 Hz - 20 kHz	65 Hz - 20 kHz	75 Hz - 20 kHz
LF Corner - 6dB	42 Hz	55 Hz	65 Hz
Crossover frequency	2.7 kHz, 260Hz	3 kHz, 400 Hz	3 kHz
Amplifier requirements	30 - 200 W	10 - 150 W	10 - 125 W
Sensitivity (2.83V/1m)	91 dB	90 dB	89 dB
Maximum output	114 dB	110 dB	108 dB
Impedance	4 Ω	4 Ω	8 Ω (min 5Ω @ 15 kHz.)
Magnetic shielding	Yes	Yes	Yes
Weight	10 kg (22 lbs)	7.5 kg (16.5 lbs)	4.5 kg (9.9 lbs)
Dimensions (H x W x D)	632 x 252 x 100 mm 24.2 x 10 x 4 in.	442 x 233 x 100 mm 17.4 x 10 x 4 in.	252 x 252 x 100 mm 10 x 10 x 7.9 in.

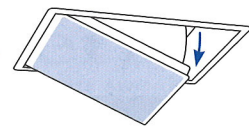

### Ci 200QT

Easily configured for infrared remote control, the Ci 200QT features an integral motor to position the 200mm (8") 2-way UNI-Q®

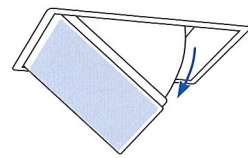

driver array at the optimum angle with the press of a button. Operates as a conventional ceiling-mount speaker when fully retracted.

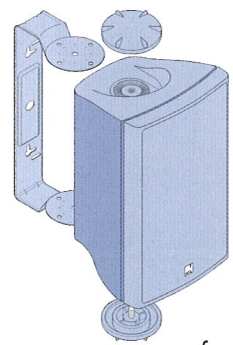

### Ci 500AW

Imagine KEF acoustic quality by the summerhouse. Near the pool. On the patio. On the yacht, even. The 70 Watt Ci 500AW is the answer - a sleek 2-way closed box speaker designed specifically for external use. Completely weatherproof and with a neat integral mounting bracket, it delivers a solid, richly detailed sound virtually anywhere.

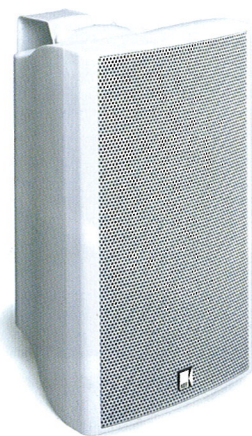

### Ci 130DS

With its switchable bipole/dipole radiation pattern, Ci 130DS is the ideal surround/rear effects speaker to partner Ci 200QT for high performance built-in home theatre. A pair of 80mm (3 1/4") midrange/HF drivers facing 80° apart complement the 130mm (5 1/4") bass driver in one compact unit.

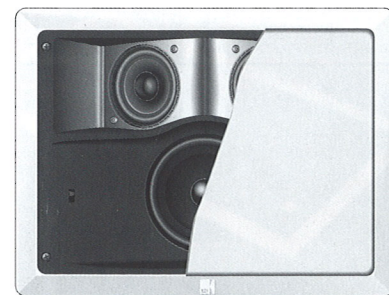
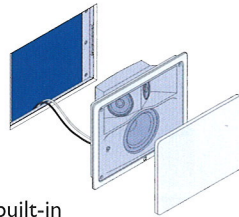

Model	Ci 200QT	Ci 500AW	Ci 130DS
Design	2 way UNI-Q, 2 driver	2 way, 3 driver/ABR	di-pole/bi-pole, 3 driver
Frequency response at 15° horizontally off axis ±3 dB	50 Hz - 20 kHz	60 Hz - 20 kHz	70 Hz - 8 kHz
Crossover frequency	2.5 kHz	3 kHz	750 Hz
Amplifier requirements	10 - 100 W	10 - 70 W	10 - 60 W
Sensitivity (2.83V/1m)	88 dB	87 dB	88 dB
Maximum output	108 dB	105 dB	106 dB
Impedance	6 Ω	8 Ω	4 Ω
Magnetic shielding	No	No	No
Weight	5.2 kg (11.4 lbs)	3.5 kg (7.7 lbs)	2.8 kg (6.2 lbs)
Dimensions (H x W x D)	380 x 277 x 200 mm 15 x 10.9 x 7.9 in.	290 x 180 x 173 mm 11.5 x 7.1 x 6.9 in.	367 x 277 x 88 mm 7.8 x 7.8 x 3.5 in.

### Ci 200QS and QR

### Ci 160.2QS and QR

### Ci 130QS and QR

QS (square bezel) and QR (round bezel) models all share the proven benefits of KEF UNI-Q® technology: the almost unlimited flexibility of positioning that comes from creating such a wide sound stage. The largest in the range, Ci 200QS/QR, delivers exceptional



Ci 200QR

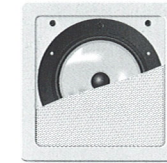

Ci 160.2QS



Ci 130QR

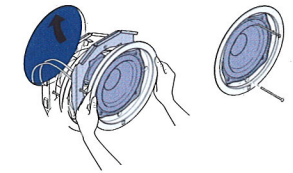

bass extension with its 200mm (8") UNI-Q driver array. The equivalent 160mm (6 1/2") Q series units of the new Ci 160.2QS/QR models feature the same Ferrofluid cooled soft dome tweeter, as do the 130mm (5 1/4") drivers of Ci 130QS and QR models.

### Ci 160.2FS and FR

### Ci 130FS and FR

Full range loudspeakers offering KEF audio quality at a remarkably affordable price, the new Ci 160.2 (160mm (6 1/2") driver) and Ci 130 (130mm (5 1/4") driver) speakers are available either with square bezels for wall



Ci 160.2FS



Ci 130FR

mounting (FS) or round bezels for ceiling mounting (FR). Like all other Ci Series speakers, their bezels and grilles can be painted to specification or covered by material to suit the style of the room.



Model	Ci 200QS/R	Ci 160.2QS/R	Ci 130QS/R	Ci 160FS/R	Ci 130FS/R
Design	2 way UNI-Q, 2 - driver	2 - way UNI-Q, 2 - driver	2 - way UNI-Q, 2 - driver	full range single driver	full range single driver
Frequency response at 15° horizontally off axis ±3 dB	50 Hz - 20 kHz	60 Hz - 20 kHz	75 Hz - 20 kHz	60 Hz - 16 kHz	75 Hz - 16 kHz
Crossover frequency	2.5 kHz	2.8 kHz	2.8 kHz	N/A	N/A
Amplifier requirements	10 - 100W	10 - 100W	10 - 50W	10 - 100W	10 - 50W
Sensitivity (2.83V/1m)	88 dB	89 dB	86 dB	89 dB	88 dB
Maximum output	108 dB	108 dB	103 dB	108 dB	105 dB
Impedance	6 Ω	8 Ω	6 Ω	8 Ω	8 Ω
Magnetic shielding	No	No	No	No	No
Weight	2.6kg (5.7lbs)	1.5kg (3.3lbs)	1.7kg (3.7lbs)	1.3kg (2.8lbs)	1.5kg (3.3lbs)
Dimensions (H x W x D)	265 x 265 x 88 mm 10.4 x 10.4 x 3.5 in.	220 x 220 x 88 mm 8.7 x 8.7 x 3.5 in.	198 x 198 x 88 mm 7.8 x 7.8 x 3.5 in.	220 x 220 x 88 mm 8.7 x 8.7 x 3.5 in.	198 x 198 x 88 mm 7.8 x 7.8 x 3.5 in.