

## K206-10H1 9.6" Liquid Crystal Display TV

This guide is designed as a reference to help you start using your LCD TV quickly. Please refer to the User's Manual for more detailed installation and safety instructions.

## Other Models

The information in this Quick Start Guide applies to all models shown below.

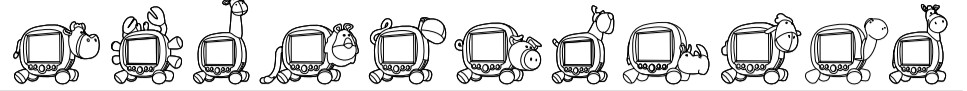

### Front View

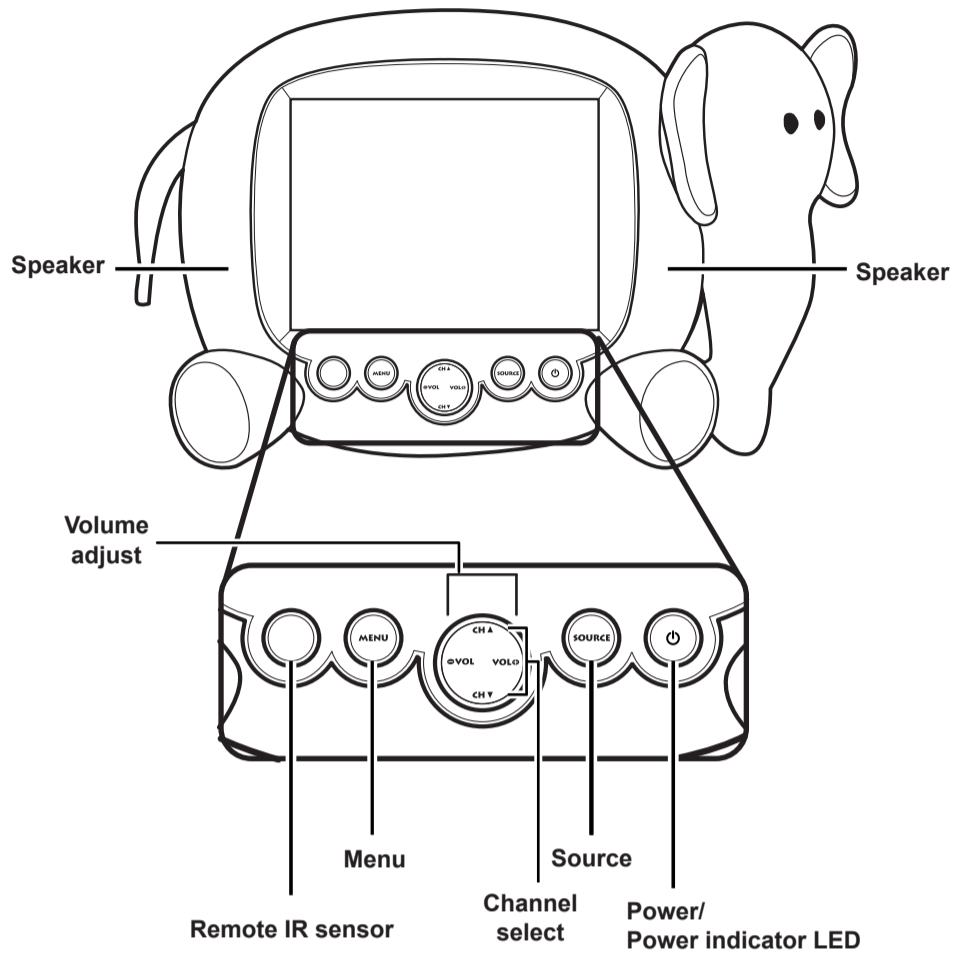

### Rear View

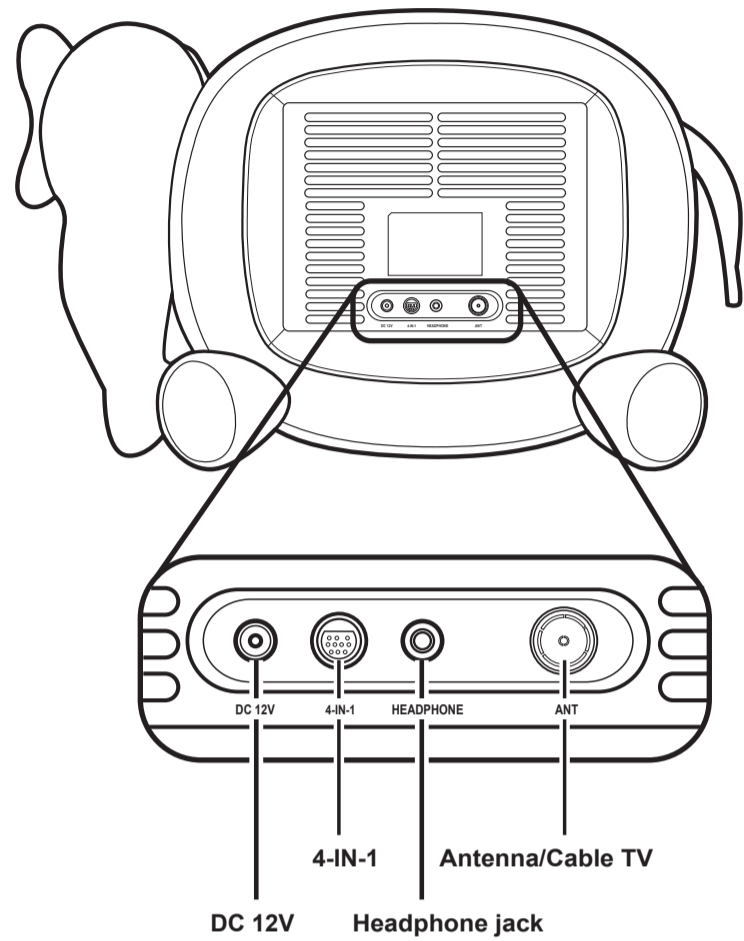

**Note:** Do not unzip the plush cover. The plush cover may only be removed by the qualified personnel to service the product.

## Making Connections

### Connecting to Antenna/Cable TV

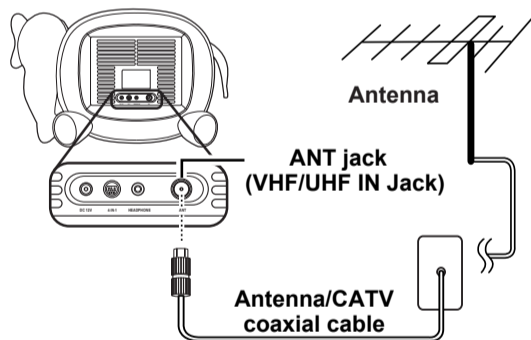

1. Connect one end of the VHF/UHF (Antenna) or CATV cable to ANT Jack (VHF/UHF IN Jack) on the back of the TV.
2. Connect the other end of the VHF/UHF (Antenna) or CATV cable to the Antenna or CATV socket.

### Connecting to a VCR, VCD, DVD Player, or Video Game Console

1. The illustration presented here shows you how to connect your TV to a VCR, VCD, DVD player or video game console.

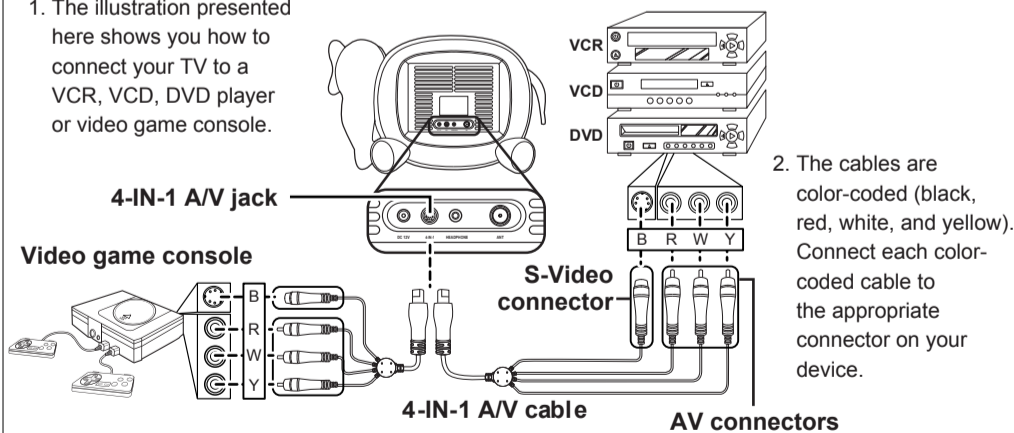

2. The cables are color-coded (black, red, white, and yellow). Connect each color-coded cable to the appropriate connector on your device.

### Connecting the Power Adapter

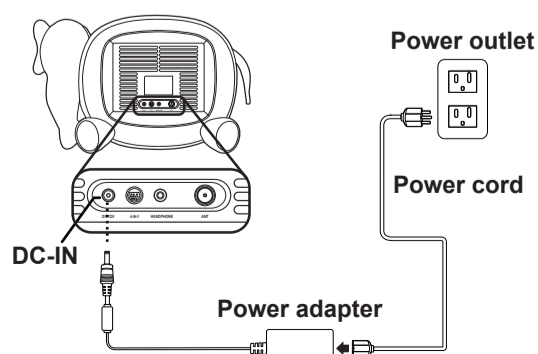

1. Connect the power cord to the power adapter as illustrated.
2. Plug the power adapter connector into the DC-IN input jack on the rear panel of the TV.
3. Insert the three-pronged plug at the other end of the power cord into a power outlet.

**Note:** Images are for illustration only and may vary by model or region.

## A/V and Channel Setup

### Selecting A/V Sources

1. Make sure your TV is turned on and a device such as a DVD player is connected.
2. Press the **SOURCE** button on the control panel to select different source signals. TV channel number, AV or AVs appear on the screen.

**Note:** AVs only appears on the screen when S-Video is connected.

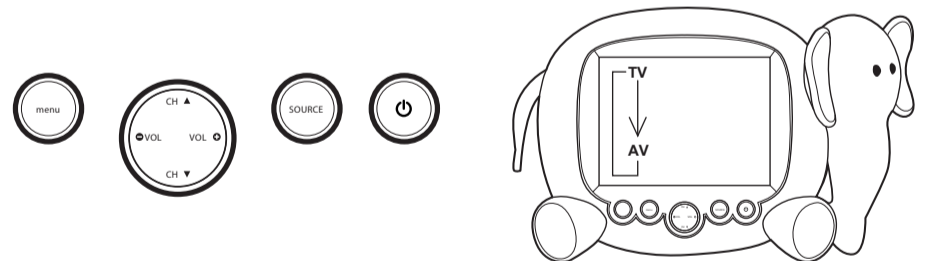

### Auto Channel Setup

Please follow the instructions by using the control panel.

1. Press the **MENU** button to enter the OSD menu.
2. Use the **CH** button to select "TV".
3. Press the **VOL +** button to enter the TV setting.
4. Press the **CH** button until the "Auto Program" feature is selected.
5. Press the **VOL +** button to begin "Auto Program".
6. Your television will begin automatically memorizing the available channels.

### Auto Program

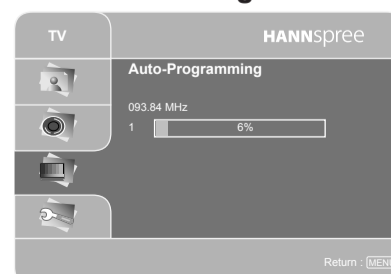

## K206-10X1 9.6" Liquid Crystal Display TV

This guide is designed as a reference to help you start using your LCD TV quickly. Please refer to the User's Manual for more detailed installation and safety instructions.

The information in this Quick Start Guide applies to all models shown below.

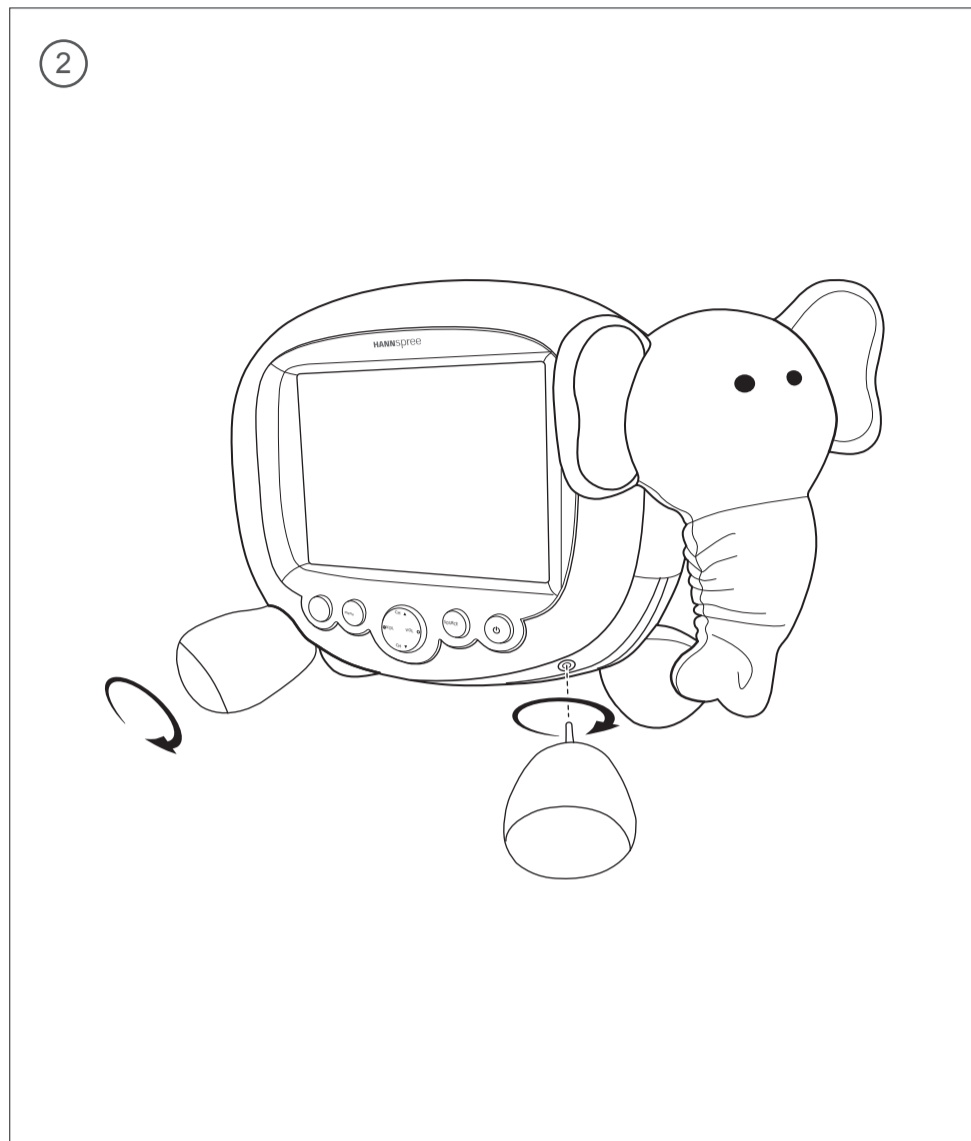
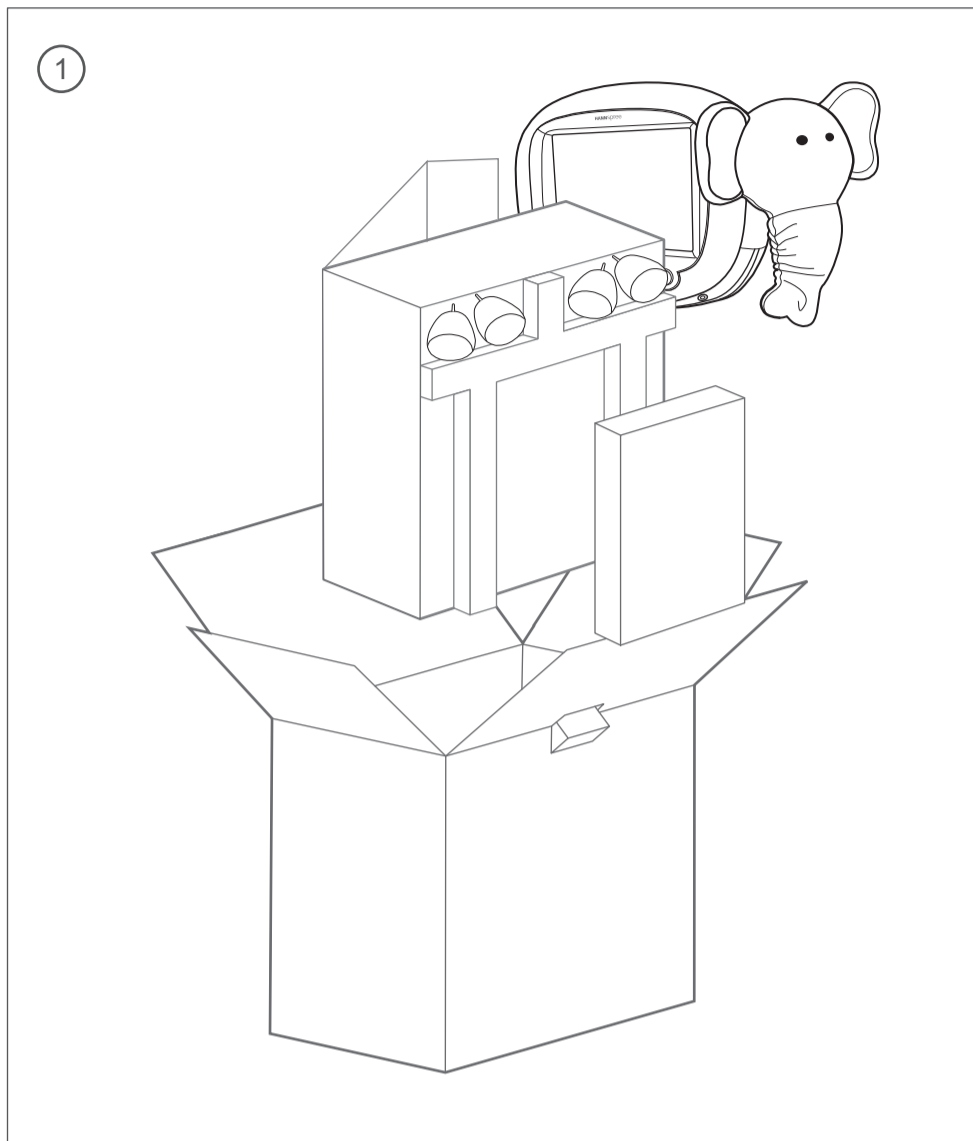

### ASSEMBLY INSTRUCTION:

1. REMOVE ALL CONTENTS FROM THE PACKAGING. ①
2. PLACE TV HORIZONTALLY ON A FLAT AND STABLE SURFACE.
3. FASTEN THE FEET TO THE TV UNIT BY TURNING THE FEET IN A CLOCKWISE DIRECTION. ②

### 請依指示操作：

1. 為確保本 Hannspree 產品的完整性，請依圖示 ① 依序取出產品及所有構件。
2. 請將產品本體平放，再將產品腳部四個構件依圖示 ② 方向 (順時針) 依序鎖入固定位置。
3. 安裝構件時請務必保持本產品平穩，以防止損傷。

### 裝配說明：

1. 請依圖 ① 從包裝箱中取出所有組件。
2. 將電視水平放置在平穩表面上，再將產品支撐腳四個構件依圖 ② 方向 (順時針) 鎖入固定位置。
3. 順時針轉動支撐腳，用支撐腳固定電視。

### 組み立て指示：

1. パッケージから付属品をすべて取り出します。①
2. テレビを平らで安定した面に水平に設置し、脚を時計方向に回して、本体にしっかり固定してください。②

### ZUSAMMENBAUANLEITUNG:

1. ENTFERNEN SIE DEN GESAMTEN INHALT AUS DER VERPACKUNG. ①
2. STELLEN SIE DAS TV-GERÄT HORIZONTAL AUF EINER FLACHEN, STABILEN FLÄCHE AUF.
3. BEFESTIGEN SIE DIE FÜSSE AM TV-GERÄT, INDEM SIE DIE FÜSSE IM UHRZEIGERSINN DREHEN. ②

### INSTRUCTIONS DE MONTAGE:

1. RETIREZ TOUS LES ELEMENTS DU PAQUET D'EMBALLAGE. ①
2. PLACEZ LA TV HORIZONTALEMENT SUR UNE SURFACE PLANE ET STABLE.
3. FIXEZ LES PATTES SUR LA TV EN LES VISSANT DANS LE SENS HORAIRE. ②

### INSTRUCCIONES DE MONTAJE:

1. EXTRAIGA EL CONTENIDO DEL ENVASE. ①
2. COLOQUE LA TV DE FORMA HORIZONTAL SOBRE UNA SUPERFICIE PLANA Y ESTABLE.
3. ACOPLA LOS PIES AL APARATO DE TV GIRANDO LOS PIES EN EL SENTIDO DE LAS AGUJAS DEL RELOJ. ②

### ISTRUZIONI PER L'ASSEMBLAGGIO:

1. RIMUOVERE TUTTI I CONTENUTI DALLA CONFEZIONE. ①
2. COLLOCARE IL TELEVISORE ORIZZONTALMENTE SU DI UNA SUPERFICIE PIATTA E STABILE.
3. AVVITARE LE ZAMPE ALL'UNITÀ TV GIRANDO IN SENSO ORARIO FINCHÉ SONO BEN STRETTE. ②