



[WWW.GRIZZLY.COM](http://WWW.GRIZZLY.COM)

## **3.6V CORDLESS SCREWDRIVER AND FLASHLIGHT KIT**

**MODEL G8592**

### **INSTRUCTION MANUAL**



COPYRIGHT © 1999 BY GRIZZLY INDUSTRIAL, INC.  
1821 VALENCIA ST., BELLINGHAM, WA 98227

**WARNING: NO PORTION OF THIS MANUAL MAY BE REPRODUCED IN ANY SHAPE  
OR FORM WITHOUT THE WRITTEN APPROVAL OF GRIZZLY INDUSTRIAL, INC.**

NOVEMBER, 1999 PRINTED IN U.S.A.



# **WARNING!**

**Some dust created by power sanding, sawing, grinding, drilling, and other construction activities contains chemicals known to the State of California to cause cancer, birth defects or other reproductive harm. Some examples of these chemical are:**

- **Lead from lead-based paints.**
- **Crystalline silica from bricks, cement and other masonry products.**
- **Arsenic and chromium from chemically-treated lumber.**

**Your risk from these exposures varies, depending on how often you do this type of work. To reduce your exposure to these chemicals: Work in a well ventilated area, and work with approved safety equipment, such as those dust masks that are specially designed to filter out microscopic particles.**

# SAFETY

## **WARNING**

### **For Your Own Safety Read Instruction Manual Before Operating This Equipment**

The purpose of safety symbols is to attract your attention to possible hazardous conditions. This manual uses a series of symbols and signal words which are intended to convey the level of importance of the safety messages. The progression of symbols is described below. Remember that safety messages by themselves do not eliminate danger and are not a substitute for proper accident prevention measures.

 **DANGER** Indicates an imminently hazardous situation which, if not avoided, WILL result in death or serious injury.

 **WARNING** Indicates a potentially hazardous situation which, if not avoided, COULD result in death or serious injury.

 **CAUTION** Indicates a potentially hazardous situation which, if not avoided, MAY result in minor or moderate injury. It may also be used to alert against unsafe practices.

**NOTICE** This symbol is used to alert the user to useful information about proper operation of the equipment.

## **WARNING**

### **Safety Instructions For Power Tools**

- 1. KEEP ALL SAFETY DEVICES IN PLACE** and in working order.
- 2. REMOVE ADJUSTING KEYS AND WRENCHES.** Form habit of checking to see that keys and adjusting wrenches are removed from tool before turning on.
- 3. KEEP WORK AREA CLEAN.** Cluttered areas and benches invite accidents.
- 4. DON'T USE IN DANGEROUS ENVIRONMENT.** Don't use power tools in damp or wet locations, or where any flammable or noxious fumes may exist. Keep work area well lighted.
- 5. KEEP CHILDREN AND VISITORS AWAY.** All children and visitors should be kept a safe distance from work area.
- 6. MAKE WORK SHOP CHILD PROOF** with padlocks, master switches, or by removing starter keys.
- 7. DON'T FORCE TOOL.** It will do the job better and safer at the rate for which it was designed.
- 8. USE RIGHT TOOL.** Don't force tool or attachment to do a job for which it was not designed.

# **WARNING**

## **Safety Instructions For Power Tools**

- 9. USE PROPER EXTENSION CORD** for the charger. Make sure your extension cord is in good condition. Conductor size should be in accordance with the chart below. The amperage rating should be listed on the motor or tool nameplate. An undersized cord will cause a drop in line voltage resulting in loss of power and overheating. Your extension cord must also contain a ground wire and plug pin. Always repair or replace extension cords if they become damaged.

Minimum Gauge for Extension Cords

AMP RATING	LENGTH		
	25ft	50ft	100ft
0-6	18	16	16
7-10	18	16	14
11-12	16	16	14
13-16	14	12	12
17-20	12	12	10
21-30	10	10	No

- 10. WEAR PROPER APPAREL.** Do not wear loose clothing, gloves, neckties, rings, bracelets, or other jewelry which may get caught in moving parts. Non-slip footwear is recommended. Wear protective hair covering to contain long hair.
- 11. ALWAYS USE SAFETY GLASSES.** Also use face or dust mask if cutting operation is dusty. Everyday eyeglasses only have impact resistant lenses, they are NOT safety glasses.
- 12. SECURE WORK.** Use clamps or a vise to hold work when practical. It's safer than using your hand and frees both hands to operate tool.
- 13. DON'T OVERREACH.** Keep proper footing and balance at all times.
- 14. MAINTAIN TOOLS WITH CARE.** Keep tools sharp and clean for best and safest performance. Follow instructions for lubricating and changing accessories.
- 15. DISCONNECT TOOLS** before servicing and changing accessories, such as blades, bits, cutters, and the like.
- 16. REDUCE THE RISK OF UNINTENTIONAL STARTING.** Make sure switch is in off position before plugging in.
- 17. USE RECOMMENDED ACCESSORIES.** Consult the owner's manual for recommended accessories. The use of improper accessories may cause risk of injury.
- 18. CHECK DAMAGED PARTS.** Before further use of the tool, a guard or other part that is damaged should be carefully checked to determine that it will operate properly and perform its intended function. Check for alignment of moving parts, binding of moving parts, breakage of parts, mounting, and any other conditions that may affect its operation. A guard or other part that is damaged should be properly repaired or replaced.
- 19. NEVER LEAVE TOOL RUNNING UNATTENDED. TURN POWER OFF.** Don't leave tool until it comes to a complete stop.

# CHARGING SAFETY

## WARNING

- 1. READ ALL INSTRUCTIONS** and warnings on the battery and charger before charging the battery.
- 2. CHARGE ONLY USING THE SUPPLIED CHARGER AND BATTERY.** Do not use with other batteries, chargers or cordless equipment.
- 3. DO NOT EXPOSE BATTERY OR CHARGER TO WET OR RAINY CONDITIONS.** Moisture greatly increases the risk of a shock hazard.
- 4. DO NOT TOUCH BATTERY POLES** with any conductive materials. Touching any two poles at the same time causes a short condition and can cause sparks, electrical shock or fire.
- 5. DO NOT STORE BATTERY WITH CONDUCTIVE MATERIALS.** Storing the battery in a box of screws or nails can cause shorting across the battery poles.
- 6. DO NOT THROW BATTERY IN FIRE.** Combustion of some of the batteries' component materials can cause toxic fumes and possible explosion.
- 7. IF CHARGER LIGHT FAILS TO COME ON** check the incoming power supply. If power source is okay, then the fuse inside the charger needs replacement. Charger should be serviced by a qualified electrical technician only.
- 8. CHARGER HAS A POLARIZED PLUG** (one prong is wider than the other). Do not attempt to modify the plug. Modifying the plug will result in a safety hazard and will void the warranty.
- 9. CHARGER IS DESIGNED TO OPERATE AT 110-120 VOLTS.** Never try to plug into any circuit that is not 110-120 volts. Never modify or change the plug that is attached to the charger unit to attempt to plug into 220 volt. This can cause serious electrical damage to the unit, possible fire or explosion.



Ni-Cd

**BATTERY MUST BE RECYCLED OR DISPOSED OF PROPERLY.** Consult your local Yellow Pages directory under the category "Recycling" to locate a battery recycler in your area.

# BEFORE YOU START

## Unpacking

When unpacking, check to make sure all of the following parts are included:

- 1 Cordless Screwdriver w/ Battery
- 1 Cordless Flashlight w/ Battery
- 1 Charging Adapter
- 1 Bit Extension
- 1 Square Drive Adapter
- 1 Double End Phillips®/Straight Bit
- 8 Sockets (6mm - 13mm)
- 4 Straight Blade Screwdriver Bits
- 4 Phillips® Screwdriver Bits
- 4 Posi-Drive® Driver Bits
- 8 Torx® Driver Bits
- 8 Hex Driver Bits

If any parts are missing, please contact Grizzly's Customer Service department at the phone number provided on the Warranty>Returns page.



Fig 1. Kit Contents (case not shown).

## Initial Charging

The batteries in your new Cordless Screwdriver/Flashlight Kit will not be fully charged when you receive it. To maximize

the storage capacity of the battery it should be completely discharged (turn the flashlight and screwdriver on and let them run until the batteries discharge), then fully recharge for 10-12 hours.

For optimal life span, completely discharge the battery after every use. Follow the instructions below to charge your battery

NOTE: The battery does not need to be removed from the tool in order to be charged.

1. Plug the adapter into an appropriate 110/120V outlet.
2. Plug the other end of wire with the pin plug into the receptacle on the base of the Screwdriver or Flashlight battery pack (**See Figure 2**).
3. Let the battery charge for 10-12 hours. This will give the battery a full charge. DO NOT let the battery charge for more than 12 hours.
4. When charging is complete, unplug the pin plug from the battery pack, and unplug the adapter from the wall outlet. The accessory should be ready to use.



Fig 2. Plugging charger into battery.

# OPERATION

## Inserting and Removing Drivers and Sockets:

The hex end of the screwdriver bits fit into the hex opening on the end of the cordless driver. The bits can be inserted directly into the tool, or if additional extension is required, you can insert the bit extender first, then mount the bit on the end of the extension (**See Figure 3**).

When using the supplied sockets you will need to use the square drive adapter which is included. You can easily distinguish this from the other drivers by the spring loaded detent ball on the square end. This helps to lock the socket into place on the end of the driver. Attach the socket to the adapter, then insert the adapter into the end of the driver tool.

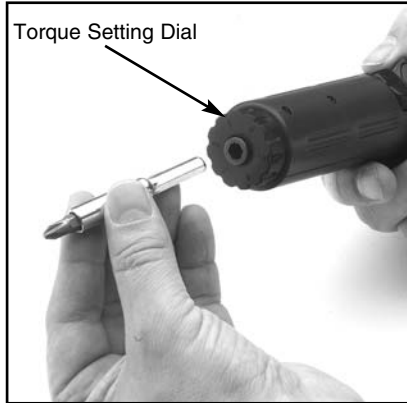

**Fig 3.** Using bit extension.

## Torque Setting

Turn the torque setting dial to the desired torque setting (**See Figure 3**). Line up the number on the torque dial with the small arrow embossed on the left hand side of the case. Torque setting “1” has the highest torque, setting “6” the least. Use only the necessary amount of torque to avoid damaging the material you are driving into or the tool.

The driver has a maximum speed of 150 RPM.

# OPERATION

## Handle Position and Switch

The driver and flashlight are both jointed in the center to adjust to different types of use. Adjust the angle to whatever is comfortable for the job to be done (**See Figure 4.**)

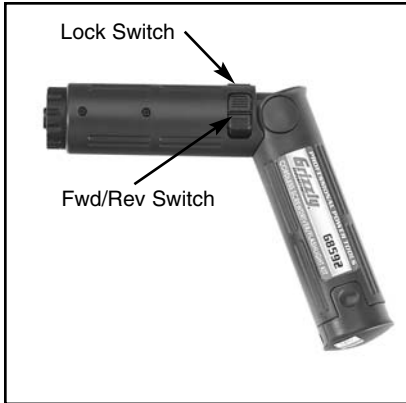

**Fig 4.** Positioning the handle and switch location.

The driver has a two position rocker switch with forward and reverse. If you want to tighten a screw, push on the top of the switch to drive clockwise. To operate counterclockwise, push the bottom portion of the switch.

There is also a locking switch just above the forward/reverse switch. This allows you to lock the tool to prevent accidental use of the tool. You should always use the LOCK position when placing, removing or adjusting bits or when removing the battery.

The flashlight has only a slider ON/Off switch on the top of the case.

## Removing Battery From Tool

The battery can be removed by pressing on the two circular depressions at the end of the handle and pulling away from the tool. When reinstalling the battery, be sure the elongated end of the battery is aligned with the slots on the inside of the compartment. The battery will lock into position when fully inserted.

## **! WARNING**

**Operating this equipment has the potential to propel debris into the air which can cause eye injury. Always wear safety glasses or goggles when operating equipment. Be certain the safety glasses you wear meet the appropriate standards of the American National Standards Institute (ANSI).**



# OPERATING TIPS AND MAINTENANCE

---

## Operating Guides and Tips

**Avoid overloading the driver.** Always use a driver which matches the fastener you are trying to drive. Do not apply excessive pressure to the driver while using. If the speed drops abnormally, decrease pressure immediately. If the driver stops abruptly or becomes blocked, release the switch at once.

**Ensure the safety of the workplace.** Clear the work area of all parts and debris that may cause injury by flying objects. Securely fix the object to be fastened in a vise or otherwise clamp to avoid injury. Do not attempt to hold workpiece by hand.

**Inspect the driver before use.** Run the driver before using to ensure all parts are running smoothly and there are no abnormal sounds or sparks. If any defect is found, have unit serviced.

**Know your worksite.** Before driving fasteners, check behind walls for wires, other electrical hazards, or plumbing.

**Use accessories properly.** Use the lowest possible torque setting when driving fasteners. This will increase the life span of the driving bit and prevent damage to the fastener.

## Maintenance

Your cordless power tool will give you hundreds of hours of operation time before ever needing service. The electrical components of this cordless drill are not user serviceable. Repair should always be undertaken by a qualified electrical repair technician.

Keep the drill free from dirt and grease. Always store it in a dry place, preferably in the case that is supplied.

The battery will require periodic recharging, and eventually replacement after it has exceeded its recharge life (approximately 800-1000 recharge cycles). You will notice extended charging times or shortened operation time as the battery experiences more cycles. **Battery must be recycled or disposed of properly.** Refer to the Grizzly catalog for replacement batteries.

### **WARNING**

**Disassembly and improper reassembly of this device can result in electrical shock danger. Always have this device serviced by a qualified electrical repair technician. Serious injury will result.**

# WARRANTY AND RETURNS

---

Grizzly Industrial, Inc. warrants every product it sells for a period of **1 year** to the original purchaser from the date of purchase. This warranty does not apply to defects due directly or indirectly to misuse, abuse, negligence, accidents, repairs or alterations or lack of maintenance. This is Grizzly's sole written warranty and any and all warranties that may be implied by law, including any merchantability or fitness, for any particular purpose, are hereby limited to the duration of this written warranty. We do not warrant or represent that the merchandise complies with the provisions of any law or acts unless the manufacturer so warrants. In no event shall Grizzly's liability under this warranty exceed the purchase price paid for the product and any legal actions brought against Grizzly shall be tried in the State of Washington, County of Whatcom.

We shall in no event be liable for death, injuries to persons or property or for incidental, contingent, special, or consequential damages arising from the use of our products.

To take advantage of this warranty, contact us by mail or phone and give us all the details. We will then issue you a "Return Number", which must be clearly posted on the outside as well as the inside of the carton. We will not accept any item back without this number. Proof of purchase must accompany the merchandise.

The manufacturers reserve the right to change specifications at any time because they constantly strive to achieve better quality equipment. We make every effort to ensure that our products meet high quality and durability standards and we hope you never need to use this warranty.

Please feel free to write or call us if you have any questions about the machine or the manual.

Grizzly Industrial, Inc.  
1203 Lycoming Mall Circle  
Muncy, PA 17756  
Phone: (570) 546-9663  
Fax: (800) 438-5901

E-Mail:  
techsupport@grizzly.com

Web Site: <http://www.grizzly.com>

Thank you again for your business and continued support. We hope to serve you again soon.

# WARRANTY CARD

Name \_\_\_\_\_

Street \_\_\_\_\_

City \_\_\_\_\_ State \_\_\_\_\_ Zip \_\_\_\_\_

Phone Number \_\_\_\_\_ E-Mail \_\_\_\_\_ FAX \_\_\_\_\_

MODEL # G8592 3.6V Cordless Set Order # \_\_\_\_\_

The following information is given on a voluntary basis. It will be used for marketing purposes to help us develop better products and services. Of course, all information is strictly confidential.

- How did you learn about us?  
 Advertisement  Friend  
 Catalog  Card Deck  
 World Wide Web  
 Other \_\_\_\_\_
- What is your annual household income?  
 \$20,000-\$29,999  \$60,000-\$69,999  
 \$30,000-\$39,999  \$70,000-\$79,999  
 \$40,000-\$49,999  \$80,000-\$89,999  
 \$50,000-\$59,999  \$90,000 +
- What is your age group?  
 20-29  50-59  
 30-39  60-69  
 40-49  70 +
- How long have you been a woodworker?  
 0 - 2 Years  8 - 20 Years  
 2 - 8 Years  20+ Years
- How would you rank your woodworking skills?  
 Simple  Advanced  
 Intermediate  Master Craftsman
- What stationary woodworking tools do you own? Check all that apply.  
 Air Compressor  Panel Saw  
 Band Saw  Planer  
 Drill Press  Power Feeder  
 Drum Sander  Radial Arm Saw  
 Dust Collector  Shaper  
 Spindle Sander  Jointer  
 Table Saw  Lathe  
 Mortiser  Wide Belt Sander  
 Horiz.Boring Machine  
 Vacuum Veneer Press  
 Other \_\_\_\_\_
- How many of your woodworking machines are Grizzly? \_\_\_\_\_
- Which benchtop tools do you own? Check all that apply.  
 1"x42" Belt Sander  6" - 8" Grinder  
 5" - 8" Drill Press  Mini Lathe  
 8" Table Saw  8" - 10" Bandsaw  
 Scroll Saw  Disc/Belt Sander  
 Spindle/Belt Sander  Mini Jointer  
 10"-12" Thickness Planer  
 Other \_\_\_\_\_
- How many of the machines checked above are Grizzly? \_\_\_\_\_
- Which portable/hand held power tools do you own? Check all that apply.  
 Belt Sander  Orbital Sander  
 Biscuit Joiner  Palm Sander  
 Circular Saw  Portable Planer  
 Detail Sander  Saber Saw  
 Drill/Driver  Reciprocating Saw  
 Miter Saw  Router  
 Other \_\_\_\_\_
- What machines/supplies would you like Grizzly Industrial to carry?  
 12" Table Saw  Radial Arm Saw  
 12" Jointer  Panel Saw  
 Brass Hardware  Lumber  
 Paint & Finishing Supplies  
 Contractor's Supplies  
 Combination Planer/Jointer  
 Other \_\_\_\_\_
- What new accessories would you like Grizzly Industrial to carry?  
 Builders Hardware  Hand Tools  
 Fasteners  
 Wood Components  
 Other \_\_\_\_\_
- What other companies do you purchase your tools and supplies from?  
\_\_\_\_\_  
\_\_\_\_\_  
\_\_\_\_\_
- Do you think your purchase represents good value?  
 Yes  No
- Would you recommend Grizzly to a friend?  
 Yes  No
- Would you allow us to use your name as a reference for Grizzly customers in your area? **Note: We never use names more than three times.**  
 Yes  No
- Comments: \_\_\_\_\_  
\_\_\_\_\_  
\_\_\_\_\_

Send a Grizzly Catalog to a friend:

Name _____
Street _____
City _____ State _____ Zip _____

FOLD ALONG DOTTED LINE

---

---

---

---



**GRIZZLY INDUSTRIAL, INC.**  
**P.O. BOX 2069**  
**BELLINGHAM, WA 98227-2069**

TAPE ALONG EDGES--PLEASE DO NOT STAPLE