

Combi

i-thru 7100 Series

Instruction Manual

Be sure to carefully read this instruction manual **before** using the product to ensure proper use of the stroller and **keep it for future reference**. Record the following information for quick reference.

Note: Illustrations are only representative and not actual.
Attach copy of sales receipt.

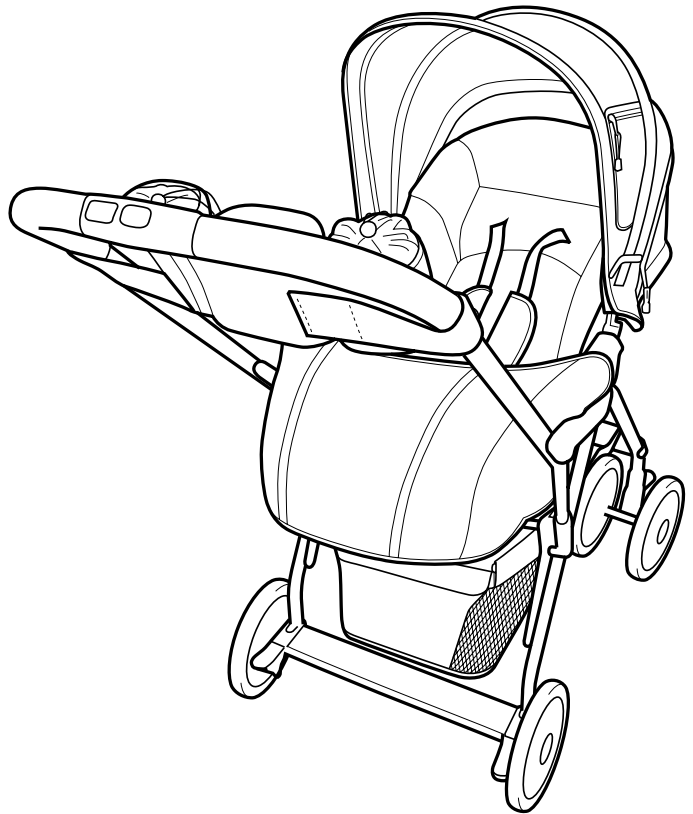

Date Purchased: _____

Model Number: 7100-_____ Located on the rear right leg.

Color: _____

Fabric Pattern: _____

Parts List

Make sure you have all the parts listed below before using your stroller. If any parts are missing, call Consumer Affairs at 1-800-99-COMBI.

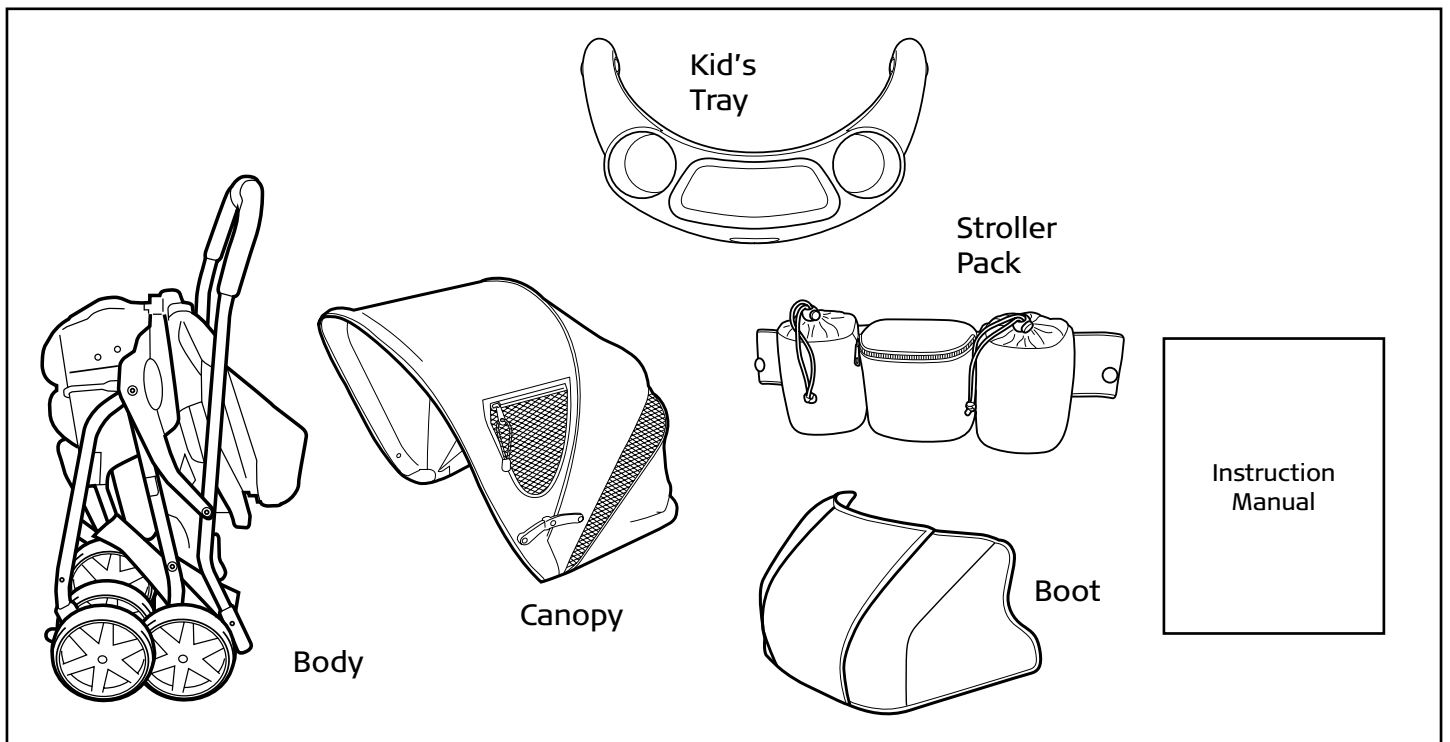

Name of Parts

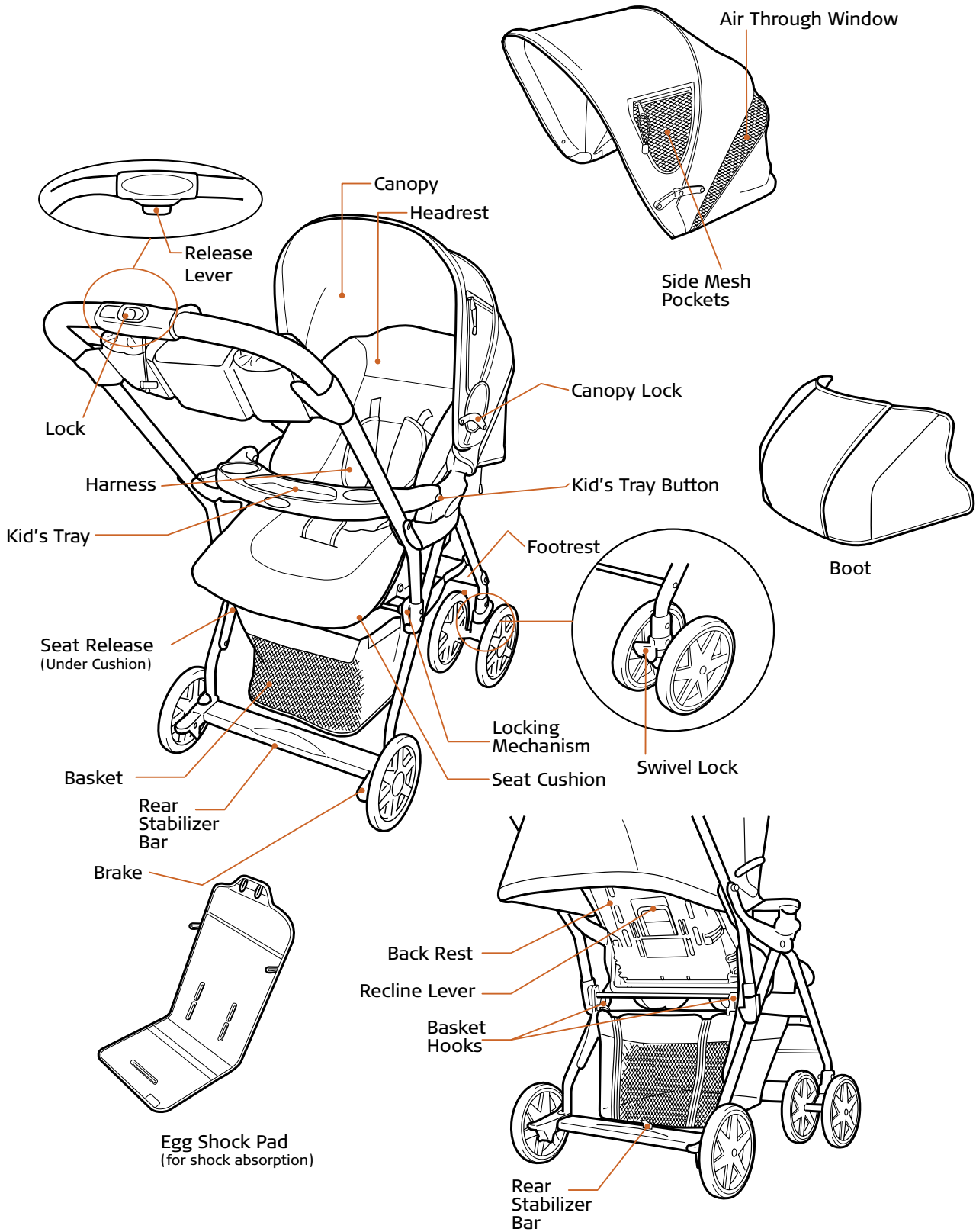

Questions, concerns check our website
www.combi-intl.com

1-800-992-6624

⚠️ WARNINGS For your child's safety:

If your stroller is not used in compliance with these instructions, serious injury may result.

⚠️ WARNING

Before use, make sure stroller locking mechanism is in the locked position.

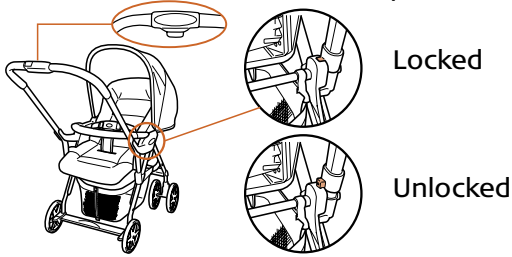

⚠️ WARNING

Avoid serious injury from falling or sliding out. Always use attachment strap.



⚠️ WARNING

Do not use seat from stroller to carry child.



⚠️ WARNING

Do not use the stroller on steep slopes, stairs, escalators, beaches, rough roads, mud, etc.



⚠️ WARNING

Always remove child before detaching, reattaching stroller seat.



⚠️ WARNING

Do not lift or carry the stroller while occupied. The stroller may fold.

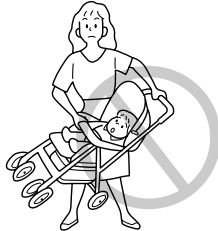

⚠️ WARNING

Do not allow your child to stand in or on the stroller.



⚠️ WARNING

Do not hang items on the handle or place items on canopy. This could cause the stroller to become unbalanced or tip over.



⚠️ WARNING

Never leave child unattended.

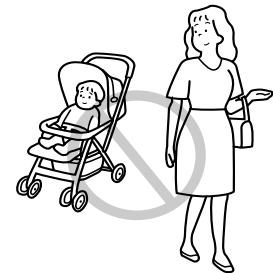

⚠️ WARNING

Never carry more than one child in the stroller. Do not allow a child to ride or sit on areas of stroller other than the seat.



⚠️ WARNING

Always engage both brakes when parking the stroller.

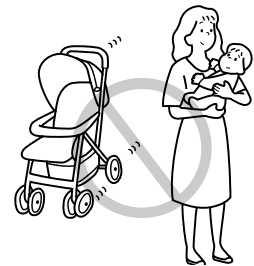

⚠️ WARNING

CHILD MAY SLIP INTO LEG OPENINGS AND STRANGLE. NEVER USE IN RECLINED CARRIAGE POSITION UNLESS THE PERMANENTLY ATTACHED SAFETY COVER IS USED.

In the event of damage or problems, discontinue use and contact Combi Consumer Affairs for instructions: 1-800-992-6624.

CAUTIONS:

1. Improper usage or lack of knowledge regarding the instructions can result in dangerous situations, personal injury or damage to the stroller.
2. Completely remove all plastic bags and packing materials before using this product to prevent a possible choking hazard.
3. Push the stroller at a normal walking speed only.

All products specifications are subject to change without notice. Sizes and weights are intended as guides and are approximations. Combi® reserves the right to modify the products in its line during the course of the year. Non contractual media. Colors are as accurate as the media in which they appear allows. ©Combi USA, Inc. 2004

Note: Illustrations are for reference only and may not represent the actual product.

Opening the Stroller

1. Slide indicator to right so that red label is visible.
2. Press and hold release button while lifting handle up and snap stroller away from you.
3. Release button can not be pressed if red label on indicator is not visible.
4. Before use, ensure stroller locking mechanism is in locked position.

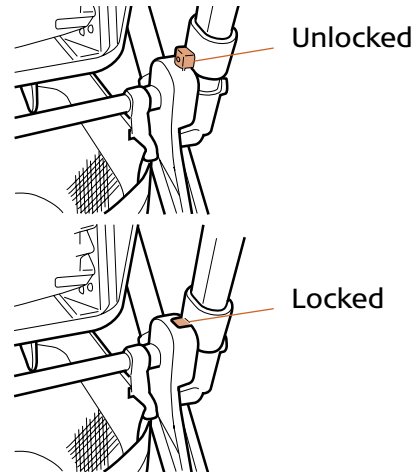
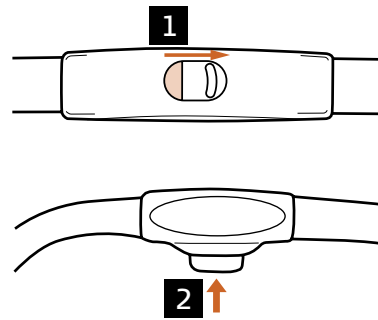
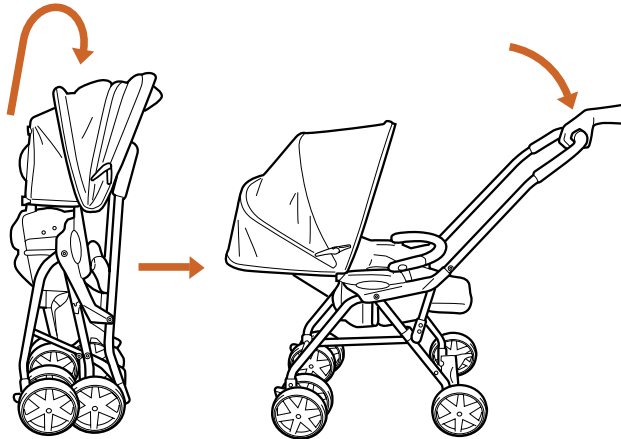

Note: Illustrations are only representative and not actual.

Changing Seat Direction



**Do not use seat from stroller to carry child.
Always remove child before detaching or reattaching stroller seat.**

1. Pull seat release lever.
2. While pulling release lever place opposite hand behind seat back and lift seat with both hands.
3. Rotate seat.
4. Center armrest above red arrow labels and press seat into stroller.
5. You will hear an audible "click" once seat is locked into position.
6. Pull up on seat to ensure that it is locked into position.

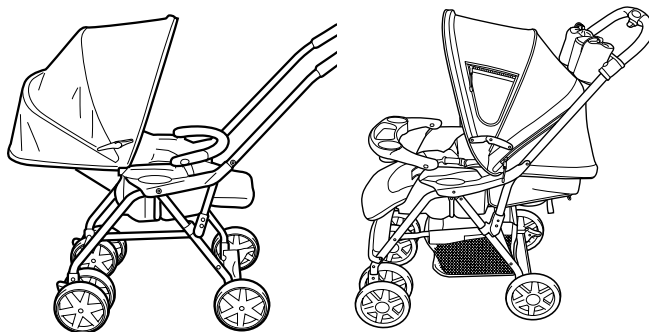
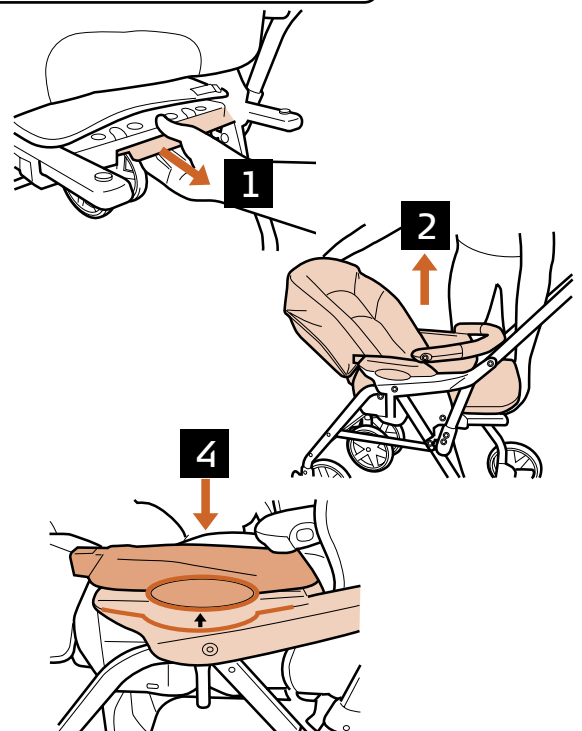

Rear Facing Seat

Forward Facing Seat

Using the Basket



Do not place more than 11 lbs. in the basket.
Remove all items from basket before folding stroller.

Attaching

1. Attach sides of basket to frame of stroller using snaps.
2. Snap both basket hooks onto rear stabilizer bar.
3. Insert hook into rear stabilizer bar cover to secure basket.

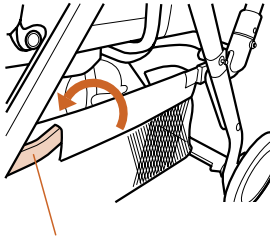
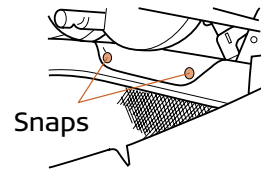

Frame for basket attachment

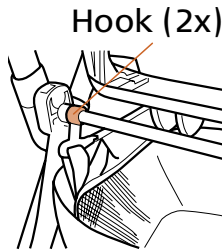

Hook (2x)

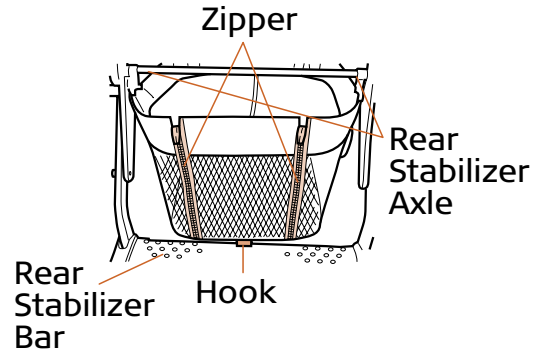

Removing

Reverse the procedure for attaching.

Reclining the Seat



Never use seat in reclined position unless the permanently attached safety cover is used.

CAUTION

Be careful when reclining the backrest while your baby is in the stroller to prevent abrupt changes in seating position.

CAUTION

Seat will fold if pushed forward.

Pull the recline lever and gently adjust backrest to any three positions.

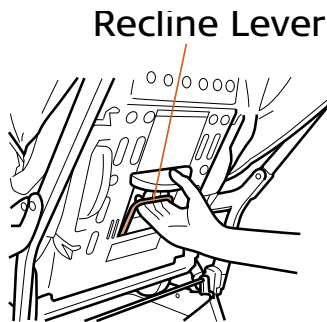

Recline Lever



Using the Safety Cover

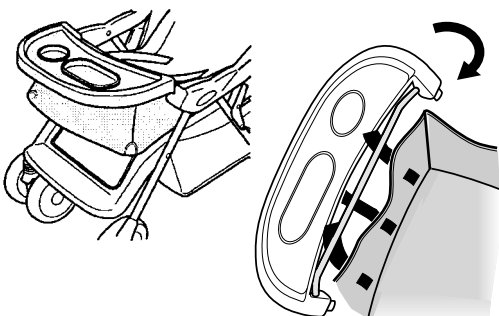

CAUTION

Before folding the stroller, unfasten and store the safety cover under the seat. The stroller will not fold with it attached.



Never use seat in reclined position unless the permanently attached safety cover is used.

1. Lift the seat cushion and pull the safety cover out.
2. Wrap the velcro straps around the tray belt and route the side velcro straps through the loop underneath the seat cushion. (Located on the bottom of the Kid's Tray.)
3. Fasten the velcro straps to secure.

Using the Swivel Wheels

To lock swivels, lift both swivel lock levers up.

To unlock swivels, push both swivel lock levers down.

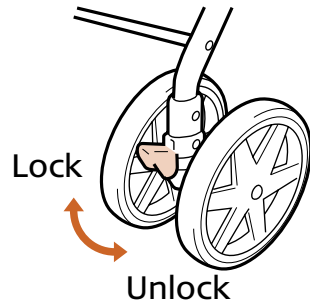

Using the Brakes

To lock brakes, push both brake levers down.

To unlock brakes, lift both brake levers up.

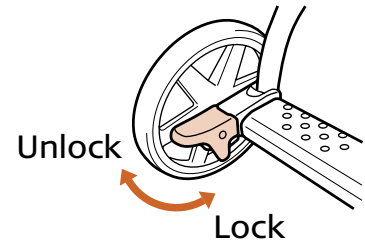

CAUTION

Push the stroller forward to ensure that the brakes are properly engaged.

Using the Kid's Tray



To prevent damage to the stroller, never push down or pull up on tray once it is attached to stroller.

1. Squeeze the release buttons on both sides and lift up to release,
2. When released, it allows easy access to the seating area.
3. To attach the Kid's Tray, slip it over the armrest pins until you hear the pins click into position.

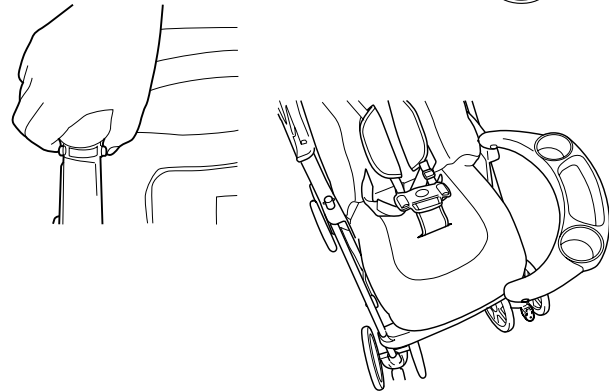

Using the Seat Extension

1. Lift the seat cushion and locate the seat extension.
2. Pull out the seat extension on both sides.
3. Attach snaps on seat cushion to snaps on seat extension.

When not in use push the seat extension back to the original position.

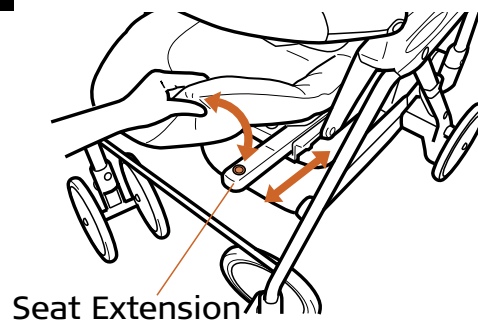

Using the Boot

1. Pull out seat extension and attach seat cushion.
2. Fit boot onto seat extension
3. Attach snaps on boot to snaps on side of the stroller.
4. Attach elastic to Kid's Tray.

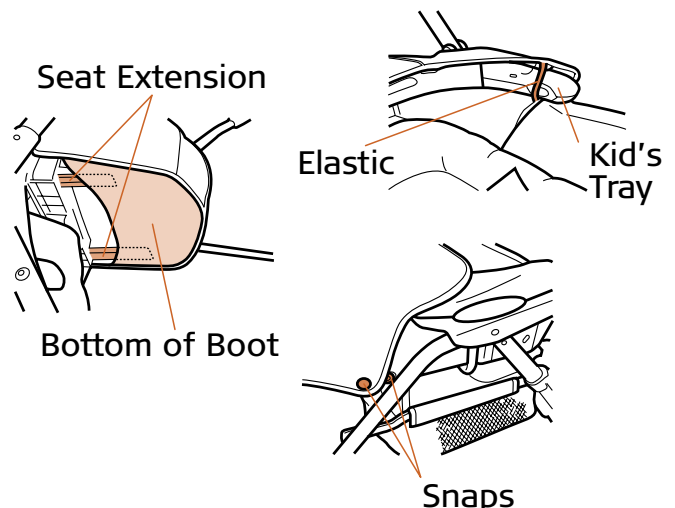

Folding the Stroller

Perform the following operations before folding:

Forward Facing Seat

1. Lock both front swivel wheels.
2. Ensure Kid's Tray is attached at both sides.
3. Fold the canopy toward the handle.

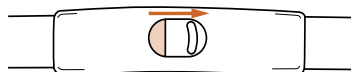
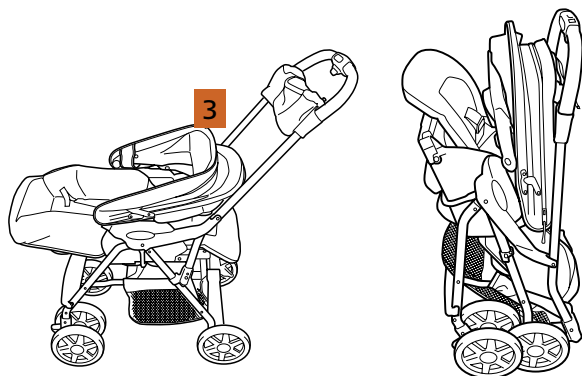

5. Slide indicator to right so that red label is visible.
6. Press and hold release button while lifting handle up and toward front of stroller.

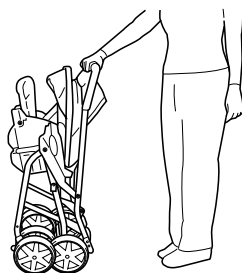

CAUTION

Folding levers should be operated only when folding the strollers.

Rear Facing Seat

1. Lock both front swivel wheels.
2. Ensure Kid's Tray is attached at both sides.
3. Fold the canopy away from the handle.

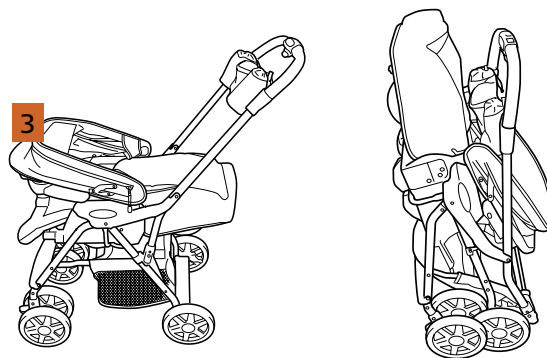

WARNING

Before use, make sure stroller locking mechanism is in the locked position.

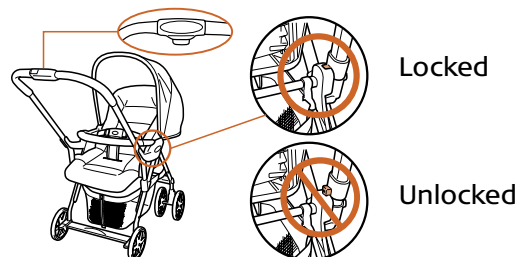

Using the Harness



Avoid serious injury from falling or sliding out. Always use the 5-point harness.

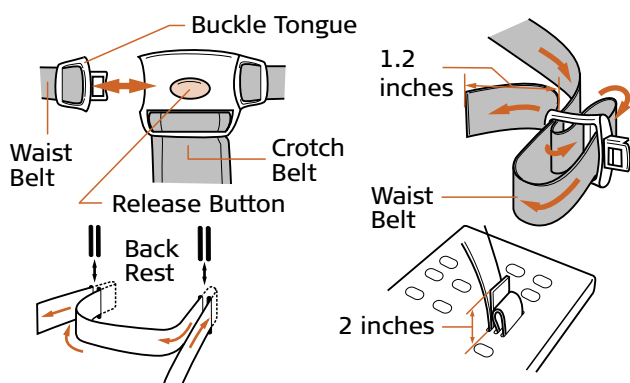

Unbuckling the Harness

1. Press levers down on right and left harness hooks to detach from buckle tongues.
2. Press buckle button down (with Combi logo) and detach buckle tongues from buckle.

Buckling the Harness

1. Place the crotch belt between the baby's legs.
2. Insert buckle tongues into buckle.
3. Lift buckle with tongues inserted and attach right and left hook to holes in buckle tongue
4. To adjust the harness or waist belt, loosen the slack on both sides of each buckle tongue.

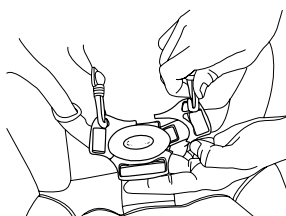

Removing and Attaching the Seat Cushion and Eggshock Pad

CAUTION

If seat cushion is ripped or torn, do not use. Do not use the stroller without the seat cushion.

WARNING

Always ensure at least 1.2 inches of waist belt is visible after routing is complete.

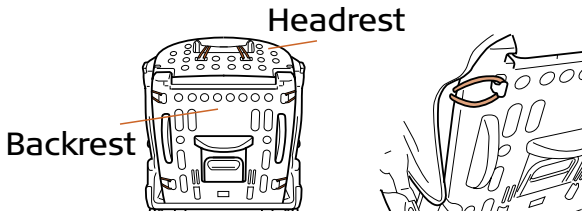

Removing

1. Unbuckle the 5-point harness and pull all the straps through the seat cushion.
2. Unsnap seat cushion from seat extension.
3. Unhook elastic bands from backrest.
4. Grasp seat cushion and Eggshock foam and remove from seat.

Attaching

1. Pass the 5-point harness straps through the appropriate locations in the Eggshock foam and seat cushion.
2. Fit seat cushion over backrest.
3. Attach all elastic bands.

Using the Canopy

Attaching

Fully insert the canopy holder (male) to the canopy holder (female) until a click is heard.

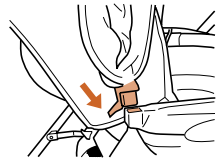

Removing

Pull tab on canopy up and pull out of canopy holder.

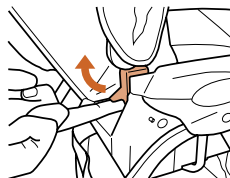

CAUTION

Failure to fully secure the canopy holders can cause the holders to bend. When storing the stroller by laying it down, be sure the canopy is off the ground to prevent it from bending.

Extending

Press lock down to fully extend canopy.

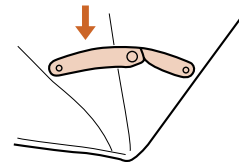

Folding

Push lock up to fold canopy.

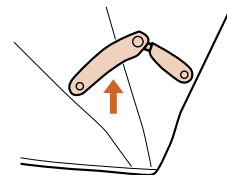

Using the Air-Thru System

Open and close the Air-Thru window using the zipper located at the rear of the canopy.

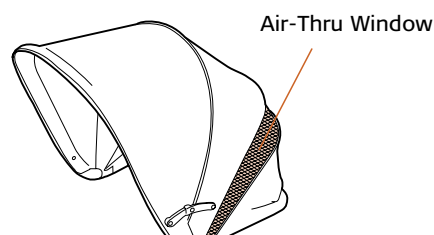

Routine Maintenance

STORE IN A COOL AND DRY AREA, especially in the summer. Do not store the stroller in the trunk of a vehicle.

SEAT CUSHION

The seat cushion is machine washable. Set to gentle cycle using cold water and a mild detergent. Do not use bleach. Lay seat cushion flat to dry in shaded area. Do not machine dry. To prevent color fading, do not leave soaking for a long period. Do not dry in the sun. If the seat cushion is frayed or unraveling, discontinue use and call Consumer Affairs for further instruction.

EGGSHOCK PAD

The Eggshock pad is not washable. Should pad become damp, lay flat in a shaded area to dry.

CANOPY, WAIST BELT, FIXED SEAT BASE AND BASKET

Hand wash with brush. Wipe out excess water with a dry cloth and dry in a shaded area. For stubborn dirt, dilute a mild detergent and apply directly to the dirty area. Wipe out the detergent.

MAIN BODY

Briskly wipe off any mud and dirt. To clean the body, wipe with a damp cloth then wipe out any traces of moisture on the body with a dry cloth. The main body might become moldy and musty if not wiped dry.

Excessive exposure to the sun could cause premature color fading of stroller plastic and fabric.

WHEEL ASSEMBLIES

After prolonged normal use, the wheels of your stroller may not swivel or turn as easily as when the stroller was new. This is usually due to a buildup of dirt in the swivel mechanism. Before adding lubrication, wipe off mud and dirt. **Do not use soap and water to wash wheels.** Periodically check that all screws, bolts and nuts are tight.

Avoid lubricating the swivel wheels whenever possible. Excessive lubrication or adding lubricant to swivel wheels when new may cause them to develop a shimmy or wobble that may quicken their deterioration. Add silicone* to **the wheel assemblies** in small amounts.

Do not use lubricants because oil attracts dust and would hinder the movement rather than improve it.

*Silicone spray is available in varying size cans at most hardware stores.

Trouble Shooting

STROLLER WILL NOT FOLD

- Check to see that the waist belt is not caught in the side.
- Make sure front swivels are locked.
- Make sure the backrest is in the folded position.
- Remove all items from the basket.

DIFFICULT TO STEER/STROLLER PULLS TO ONE SIDE

- Remove any items hanging from the handle.
- Make sure weight in basket is distributed evenly.
- Check that the brakes are not in the locked position.
- Clean and add silicone to wheels, if necessary.

DIFFICULT TO GET UP CURBS

- Pulling stroller backward makes going up a curb difficult, and could pose a safety hazard. Pull the handle up to lift the rear wheels onto the curb, then pull the stroller backward until the front wheels clear.

DIFFICULT GOING DOWN CURBS

- Turn stroller around, bringing rear wheels toward the edge of the curb. Gently lower rear wheels onto the surface below. Once the rear wheels have landed, guide the front portion of the stroller, using the armrest as support.

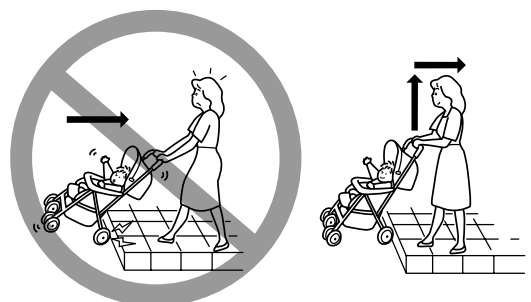

LIMITED WARRANTY

1. Combi Juvenile Products, when purchased from an authorized retailer; are warranted to the original purchaser to be free of defect in materials and workmanship for a period of one (1) year from date of purchase. Warranty is valid for products purchased and used in the U.S. only, and used in compliance with the warrantor's use and maintenance instructions. Save your carton and receipt in case of return for warranty service is necessary.
2. During the warranty period your Combi product will either be repaired or replaced, at the warrantor's discretion, without charge if it is purchased from an authorized Combi dealer and is found to be defective in workmanship or materials. For service call 1-803-548-6633. The warrantor shall not be responsible for any costs incurred by the consumer in returning a defective product for repair.

This limited warranty shall not apply to normal wear to the product, or if the product has been:

- a. Damaged due to accidents, misuse, abuse or neglect as determined by Combi.
- b. Tampered with or repaired by other than an authorized Combi repair center or with parts other than Combi approved parts.
- c. Leased or rented for commercial use.

THE WARRANTY PROVIDED HEREIN IS EXCLUSIVE AND IS IN LIEU OF ALL OTHER EXPRESS WARRANTIES. ANY IMPLIED WARRANTIES, INCLUDING ANY IMPLIED WARRANTY OF MERCHANTABILITY OR FITNESS FOR A PARTICULAR PURPOSE ARE EXPRESSLY EXCLUDED. WARRANTOR'S OBLIGATIONS AND THE CONSUMER'S OR OTHER BUYER'S REMEDIES UNDER THE LIMITED WARRANTY ABOVE ARE EXCLUSIVE AND ARE STRICTLY LIMITED TO REPAIR OR REPLACEMENT AS STATED. ANY INCIDENTAL OR CONSEQUENTIAL DAMAGES ON THE PART OF THE WARRANTOR AND ANY SUPPLIER OR DEALER ARE HEREBY ALSO EXPRESSLY EXCLUDED.

Some states limit or do not allow exclusions or limitations on how long an implied warranty lasts so the above limitation may not apply to you. Some states do not allow the exclusion or limitation of incidental or consequential damages, so the above limitation or exclusion may not apply to you. This warranty gives you specific legal rights, and you may also have other rights which vary from state to state.

