ANKO MITYFLEX PERISTALTIC PUMPS

PERISTALTIC PUMP
OPERATORS MANUAL

907 & 908 SERIES

QUALITY MANAGEMENT SYSTEM REGISTERED
TO ISO9001 INTERNATIONAL STANDARDS



ANKO PRODUCTS INC. PUMP DIVISION

www.ankoproducts.com

Thank you for purchasing an Anko Mityflex® Peristaltic pump. We are sure you will be completely satisfied with its performance. Should you need assistance or have questions regarding the use or installation, please call: 941-749-1960

TABLE OF CONTENTS

WARRANTY	2
WARNING	2
RETURN & REPAIR	2
PUMP FEATURES	3
PUMP INSTALLATION	3
FLOW CHARTS	4
ROLLER SELECTION	5
FUSE INSTALLATION/FAN ASSEMBLY	5
TUBING INSTALLATION	6
TUBING INSTALLATION PROCEDURE A	6
TUBING INSTALLATION PROCEDURE B	7
TUBING INSTALLATION PROCEDURE C	8
ILLUSTRATION OF PUMP HEAD ASSEMBLY	8
REPLACEMENT PARTS LIST	8

Every precaution for accuracy has been taken in the preparation of this manual, however, Anko Products, Inc. neither assumes responsibility for any omissions or errors that may appear nor assumes liability for any damages that result from the use of the products in accordance with the information contained in the manual.

LIMITED WARRANTY

ANKO PRODUCTS, INC., warrants equipment of its manufacture and bearing its identification to be free from defects in workmanship and material. ANKO PRODUCTS, INC.'s liability under this warranty extends for a period of one year from the date of delivery from our factory or authorized distributor. It is limited to repairing or replacing any device or part of any device which is returned, transportation prepaid, to the factory within one year of delivery to the original purchaser, and which is proven to be defective upon examination by us. ANKO PRODUCTS, INC. disclaims all liability for consequential damage of whatever nature, damage of equipment during transportation, damage due to improper handling, installation or improper operation or for determining suitability for the particular use intended by the purchaser. Replaceable parts including tubes supplied with the product are not covered by any warranties either express or implied. ANKO PRODUCTS, INC., makes no warranties either express or implied, including implied warranty or merchantability, other than those stated above. No representative has authority to change or modify this warranty in any respect. Jurisdiction and venue for enforcement of this warranty may be brought only in the State of Florida. This warranty gives you specific legal rights, and you may also have other rights which vary from state to state.

WARNING

Anko Products assumes no responsibility or liability for chemical compatibility of our tubing in specific applications. ALWAYS pretest tubing in accordance with tubing manufacturer's specifications. Tubing that shows signs of swelling, embrittlement or other deterioration should not be used.

RETURN AND REPAIR REQUESTS

Please direct all warranty and repair requests to Anko Products, Inc. Customer Service Department. Before returning any unit, please call 1-941-749-1960 to request an authorized return number.

THE RETURN AUTHORIZATION NUMBER MUST BE MARKED CLEARLY ON THE RETURN PACKAGE.

The MITYFLEX® 907 and 908 models are fixed speed general purpose pumps for dispensing fluid based products. The 907 is housed in a case and is controlled by a simple on/off switch that activates the pump. The 908 is manufactured with a zinc plated steel bracket and six inch lead wires for convenient assembly to your OEM application.

FEATURES

1. ELECTRICAL: 115 VAC, 60HZ; OPTIONS: 24 to 240 VAC 50Hz, 60Hz or 50/60Hz; 12 & 24 VDC. The 907 also includes: On/Off switch; Six foot power cord.
2. PRIMING: Unit is self priming and will hold vacuum when turned off.
3. OPERATION: Pump can run dry without damaging the motor or drive unit, however the tubing life will be reduced.
4. CONSTRUCTION: Polypropylene housing and case using stainless steel fasteners.
5. MAX. HEAD PRESSURE: Maximum working pressure 40 PSI. Normal working pressure 18 PSI varies depending on tubing used.
6. MAX. SUCTION LIFT: 29 feet (8.8m) with H₂O.
7. RATING: AC units-100% continuous operation at 25°C ambient; DC units-100% continuous operation at 40°C ambient.
8. FLOW RATE: .4 - 987 ml/min. depending on the tubing used. (See page 4.)
9. FUSE: (907 only) Located in the interior of the case. (See page 8 for replacement procedure and page 4 for fuse type.)

INSTALLATION INSTRUCTIONS

1. POWER REQUIREMENTS: Voltage and frequency of power supply must be the same as shown on unit.
2. WIRING CONNECTIONS: All wiring and electrical connections must comply with local and national electrical codes.
3. MOUNTING: (907) Case enclosed model has rubber feet and mounting flanges. This enables it to be used on a flat surface or wall mounted. Be sure that one of the sets of vent holes has plenty of space for air circulation. (908) Mounting bracket for OEM applications. Be sure there is plenty of space for air circulation. **Do not allow tubing to be crimped.**
4. MOUNTING LOCATION: Pump should be placed in a dry location with adequate cooling provided. The ambient temperature should not exceed 25°C for AC units or 40°C for DC units.

WARNING:

This unit should not be used in outdoor or hazardous locations.

MODEL 907 FLOW RANGE CHART

FLOW RATES (ml/min.) FUSE/ FAN

Tubing ID ->	.062 in (1.6mm)	.125 in (3.2mm)	.187 in (4.7mm)	.250 in (6.3mm)	Fuse	Fan
Unit #						
907-002	.4	1.7	4	7	5 amp	
907-007	1.5	5.9	14	25	5 amp	None
907-014	3	12	28	48	1 amp	None
907-023	5	19	46	81	1 amp	12-1115-18-00
907-028	6	24	56	98	2 amp	12-1115-18-00
907-036	8	30	72	126	1 amp	12-1115-20-00
907-049	10	41	98	172	5 amp	12-1115-25-00
907-058	12	49	116	208	2 amp	12-1115-18-00
907-075	16	63	150	263	3 amp	12-1115-18-00
907-108	23	91	216	378	3 amp	12-1116-18-00
907-129	27	108	258	452	3 amp	12-1116-18-00
907-172	36	144	344	602	3 amp	12-1116-18-00
907-203	43	170	406	711	3 amp	12-1116-18-00
907-282	60	237	564	987	5 amp	12-1116-18-00

Flow rate based on pumping water at 25°C and 0 PSI using 60 durometer thermoplastic elastomer tubing.

MODEL 908 FLOW RANGE CHART

(ml/min.)

Tubing ID ->	.062 in (1.6mm)	.125 in (3.2mm)	.187 in (4.7mm)	.250 in (6.3mm)	RPMS	AMPS	Fan
Unit #							
908-002	.4	1.7	4	7	2	.37	
908-007	1.5	5.9	14	25	7	.37	
908-014	3	12	28	48	14	.37	
908-023	5	19	46	81	23	.42	12-1116-18-00
908-028	6	24	56	98	26	.75	12-1116-18-00
908-036	8	30	72	126	36	.90	12-1116-20-00
908-049	10	41	98	172	48	1.0	12-1116-25-00
908-058	12	49	116	208	58	1.2	12-1116-18-00
908-075	16	63	150	263	75	1.5	12-1116-18-00
908-108	23	91	216	378	108	1.9	12-1115-18-00
908-129	27	108	258	452	129	2.2	12-1115-18-00
908-172	36	144	344	602	172	2.2	12-1115-18-00
908-203	43	170	406	711	203	3.3/2.2	12-1115-18-00
908-282	60	237	564	987	282	3.3/2.2	12-1115-18-00

Flow rate based on pumping water at 25°C and 0 PSI using 60 durometer thermoplastic elastomer tubing.

ROLLER/TUBING SELECTION

Use the following color coded rollers with the appropriate tubing I.D. Your unit is assembled with black rollers. Red rollers are included in your tubing kit. See separate instructions for roller replacement enclosed in your tube kit.

Roller	Tubing ID	ML/Revolution
Black	1/4" (.250)	3.5
Black	3/16" (.187)	2.1
Red	1/8" (.125)	0.8
Red	1/16"*	0.21

*The 1/16"ID tubing must be inserted into a 3/16"(.187)ID X 3/8"(.375)OD tubing (sleeve) for operation in pump.

FUSE INSTALLATION (907)

(See page 4 for fuse type and page 10 for fuse ordering information.)

1. **Disconnect power to pump.**
2. Remove four screws from case front.
3. Carefully remove case cover being sure not to pull wires apart.
4. Lay the unit on a flat surface.
5. Find fuse holder and pull apart.
6. Remove old fuse and replace with new fuse.
7. Replace case cover.

FAN ASSEMBLY

(See page 4 for replacement number)

Disconnect the power from the pump.

The fan is pressed on to the rotor shaft. On all 907 case units, the fan is pressed on with the metal clip away from the motor. On all OEM 908 units, the fan is pressed on with the metal clip toward the motor.

TUBING INSTALLATION

Inspect all tubing regularly and replace if any sign of deterioration occurs. Always wear safety glasses and protective clothing when working with chemicals. See chart below for proper tubing installation procedure for your unit.

*90_-002 through 90_-014	Procedure A (below)
90_-023 through 90_-049	Procedure A or B (below or page 6)
90_-058 through 90_-282	Procedure B or C (page 6 or 7)

*** WARNING: MODEL 907-002, 907-007, 907-014, 908-002, 908-007 and 908-014 GEARTRAINS CAN BE DAMAGED IF THEIR DRIVE SHAFT IS ROTATED BY HAND FOR TUBE INSERTION.**

PROCEDURE A

(If unit is new start with step number 6.)

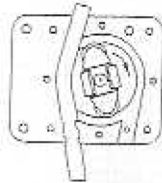

FIG. 1



FIG. 2

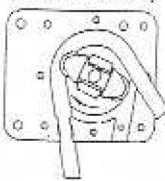

FIG. 3

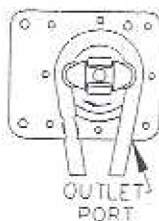
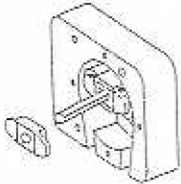
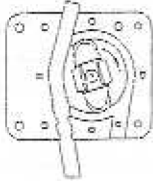
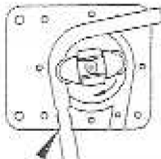
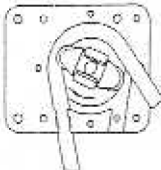
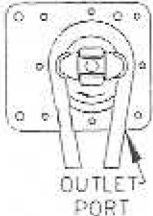

FIG. 4

1. Disconnect power to the pump.
2. Disconnect the suction and discharge tubing from the pump tubing.
3. Remove four screws and pump cover from pump head.
4. Pull out old pump tubing and discard.
5. Clean roller race, removing any particles that could damage tubing.
6. Connect power and run at slowest speed until roller bracket assembly is in position as shown in figure 1.
7. Push new tubing into inlet port, anchoring tubing in grippers. If using a 9" piece of tube, 1 1/2" should be extended outside of inlet port. (figure 2)
8. Continue to run at slowest speed carefully feeding tube into race as the rollers turn. (Figure 3)
(KEEP FINGERS AWAY FROM ROLLERS.)
9. Insert tubing into outlet port (figure 4) and replace cover.

PROCEDURE B

- FIG. 1
- 
- FIG. 2
- 
- FIG. 3
- 
- GRIPPER
(INLET PORT)
- FIG. 4
- 
- FIG. 5
- 
- OUTLET
PORT
- Follow steps 1 - 5 in procedure A, then continue with the following:
6. Using extra bracket (figure 1), rotate roller bracket assembly until it is in position as in figure 2. (Be sure power is disconnected)
 7. Push new tubing into inlet port, anchoring the tubing in grippers (see figure 3). If using 9" piece of tube, 1 1/2" should be extended outside of inlet port.
 8. Continue to rotate the roller bracket assembly using the extra bracket, while pushing the tubing into the roller race. (Figure 4)
 9. Insert the tubing into the outer port (Figure 5) and replace the cover and screws.

PROCEDURE C

Without removing the pump cover, run the unit at high RPM. Pull the old tubing out from outlet port of pump. Install new tube by inserting into inlet port; continue feeding tube 1/4" in at a time allowing the roller assembly to push tubing through. When tubing is half way around the race, put your finger over the inlet hole of the tube and continue to feed tubing 1/4" at a time, this should make installation easier. Continue until desired tubing extension is obtained. Run unit for about one minute.



WARNING

Anko Products assumes no responsibility or liability for chemical compatibility of our tubing in specific applications. ALWAYS pretest tubing in accordance with tubing manufacturer's specifications. Tubing that shows signs of swelling, embrittlement or other deterioration should not be used.

ROLLER BRACKET ASSEMBLY INSTRUCTIONS For Roller Replacement

(A plastic roller bracket assembly is supplied with units ranging from 2 to 36 RPM. No assembly is required for the plastic bracket. If new rollers are required a new assembly must be ordered.)

- 1) To remove the roller bracket assembly from the pump, use a flat head screwdriver and pry open both sides of the springs to the edge of the bracket.
- 2) Pull the roller bracket assembly off the shaft holding on to the roller area of the bracket.
- 3) Holding the top and bottom of the bracket, slide the spring off to the side and lay the assembly on a flat surface. Try not to let it fall apart as you will need to put it together the same way it is now.
- 4) Remove the top bracket and the rollers.
- 5) If a roller pin comes out of it's recess, replace it at this time.
- 6) Place the new rollers on the pins and replace the top bracket. Be sure that the flat in the inner hole of the top bracket lines up with the flat on the bottom bracket.
- 7) Slide the spring fastener back over the bracket. Do not snap the spring together.
- 8) Matching the roller bracket flat to the output shaft flat, slide the roller bracket assembly down until it stops without using force.
- 9) Snap the spring together.

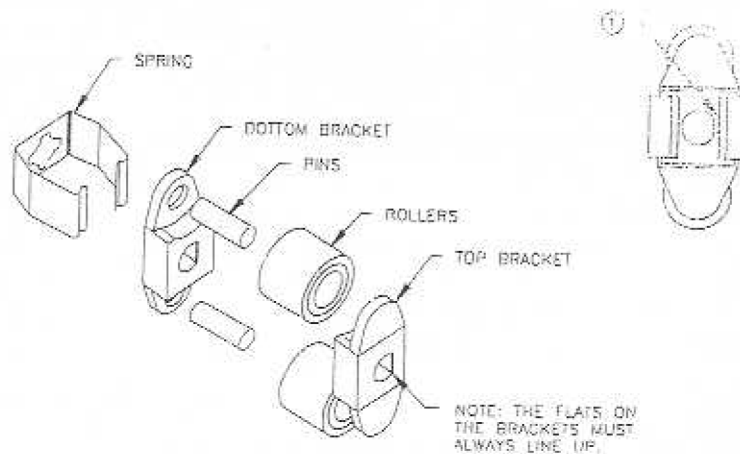

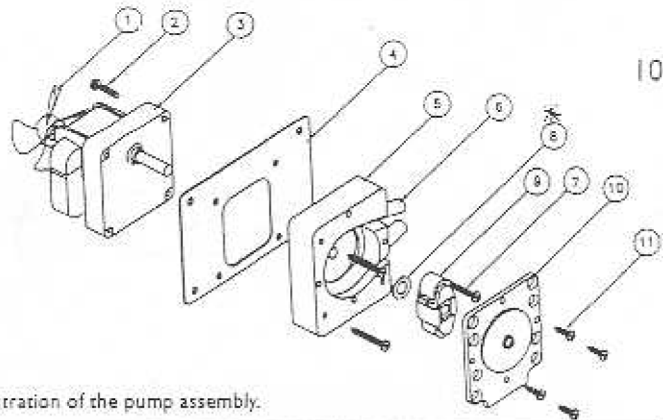

Illustration of the pump assembly.

1 - Fan	7 - Screws(4) 10-32 x 1 1/4"
2 - Screw (1) 8-32 x 7/8"	*8 - Nylon Washer
3 - Gearmotor	9 - Roller Bracket Assembly
4 - Mounting Bracket (908 only)	10- Pump Cover
5 - Pump Housing	11- Screws (4) 8-32 x 5/8"
6 - Tube	

The 908 mounting bracket is replaced with the 907 case cover on the case model.

Replacement Parts List

Call Customer Service at 800-446-2656 to order. Please remember to include the complete model number when you place your order for replacement parts. For fan orders use the chart on page 4 for the part number.

Item	Part Number
Plastic Roller Bracket (Red)	RBA-1718-03-25
Plastic Roller Bracket (Black)	RBA-1718-01-25
Black Roller Bracket Assembly.....	RB-1212-01-00
Red Roller Bracket Assembly.....	RB-1212-03-00
Pump Kit	907-101-0000-30
Includes housing, cover w/bearing, four screws, and washer.	
Tube Kit.....	TU-1124-0000-01
Includes 9' of each of the following: 1/16" ID (in a sleeve), 1/8" ID, 3/16" ID & 1/4" ID thermoplastic elastomer tubing. (See chart on page 5 for tubing and roller compatibility.)	
Model 907 only:	
Fuses .5 amp (5/pack).....	FU-1127-00-05
Fuses 1 amp (5/pack).....	FU-1127-01-00
Fuses 2 amp (5/pack).....	FU-1127-02-00
Fuses 3 amp (5/pack).....	FU-1127-03-00
Fuses 5 amp (5/pack).....	FU-1127-05-00
* No washer necessary for units using an all plastic roller bracket assembly. (2 to 36 RPM)	

ANKO MITYFLEX PERISTALTIC PUMPS

PERISTALTIC PUMP
OPERATORS MANUAL

907 & 908 SERIES

QUALITY MANAGEMENT SYSTEM REGISTERED
TO ISO9001 INTERNATIONAL STANDARDS



ANKO PRODUCTS INC. PUMP DIVISION

www.ankoproducts.com